

D1204_soundcore Liberty 5 Pro Max_User Guide

OVERVIEW

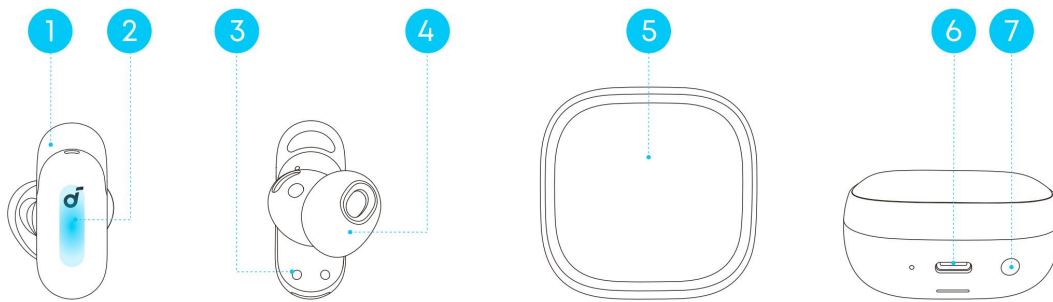

1. Ear Fin
 - Size 1 ear fins are pre-installed on the earbuds.
2. Touch Control Area
 - Tap the control area on the earbud stems to manage different functions.
3. Earbud Charging Contacts
4. Ear Tip
 - M-size ear tips are pre-installed on the earbuds.
5. Smart Display
6. USB-C Charging Port
7. Charging Case Button

POWERING ON & PAIRING

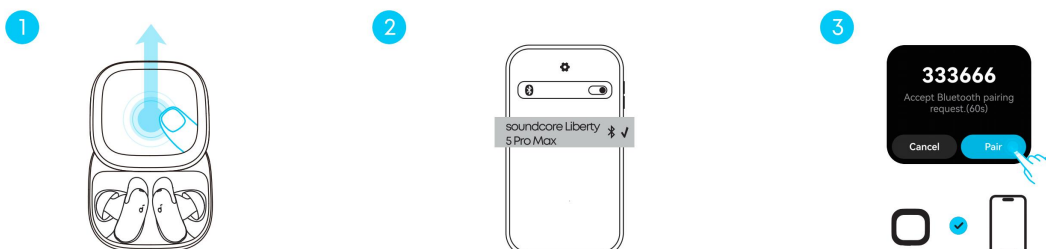

1. Slide open the charging case. The earbuds will power on and enter pairing mode.
2. On your device's Bluetooth list, select "**soundcore Liberty 5 Pro Max**" and then open the soundcore app to connect the charging case.
3. Once you initiate the connection, a pairing code will appear on both your device and the charging case. Please confirm that the two codes match before approving the pairing.

Google Fast Pair Supported: Android users can enjoy instant pairing with Google Fast Pair (Android 6.0+).

WEARING GUIDE

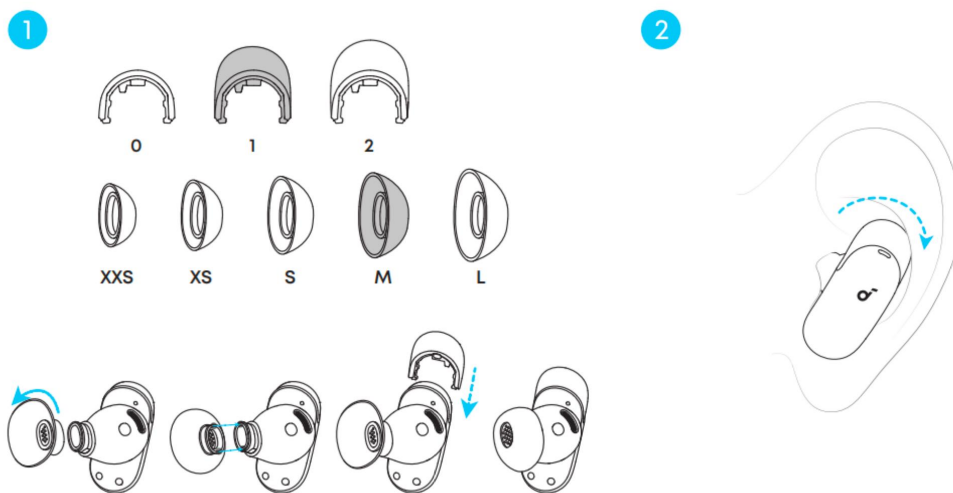

Properly wearing your earbuds will provide a more comfortable and stable fit while ensuring optimal noise cancellation and sound quality.

1. Try different ear tips and fins to find your best fit.

How to choose the right ear tips and fins?

Begin with the pre-installed size 1 ear fins and M-size ear tips. After wearing them correctly:

- a. If the ear fins cause pressure or discomfort, switch to the size 0 or size 2 ear fins.
- b. With the default M-size ear tips, if one earbud doesn't fit well, try using different sizes for each ear, such as medium in one ear and large in the other.

2. Gently place the earbuds into your ear canal and rotate them for a snug fit.
3. Take a fit test in the soundcore app (Go to **Settings** > **Fit Test**) to ensure you get the best active noise cancelling performance.

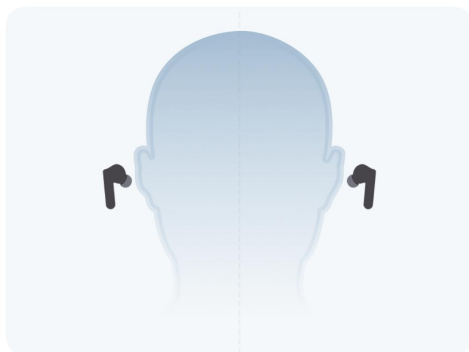

- When wearing the earbuds, avoid touching the area near the logo to prevent accidental touches.
- Dust, earwax, or other debris can accumulate in the earbuds. To maintain optimal sound quality, clean them regularly. Use a slightly moistened cotton swab with rubbing alcohol to gently wipe the metal mesh filter beneath the rubber ear tips. Make sure the alcohol has completely dried on the metal mesh filter before using the earbuds again.

MULTI-DEVICE CONNECTION

Multi-Device Connection feature is enabled automatically. If you prefer to disable this feature, tap the gear icon in the upper-right corner to access **Settings**, then tap the toggle switch for

Multi-Device Connection to turn it off.

How to Connect New Devices

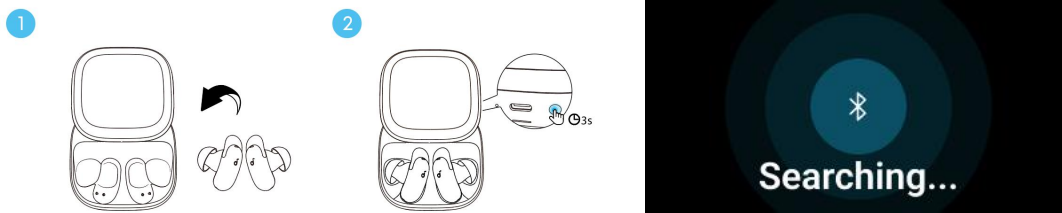

To connect a new device when one is already connected, place both earbuds in the case, then press and hold the charging case button for 3 seconds with the lid open, until the Bluetooth Pairing prompt appears on the Smart Display. You can then proceed to pair with new devices.

If you are wearing the earbuds, tap and hold the touch control area on both earbuds to enter pairing mode.

You can also tap **Connect New Device** in the app, then your earbuds can be discovered by another Bluetooth device.

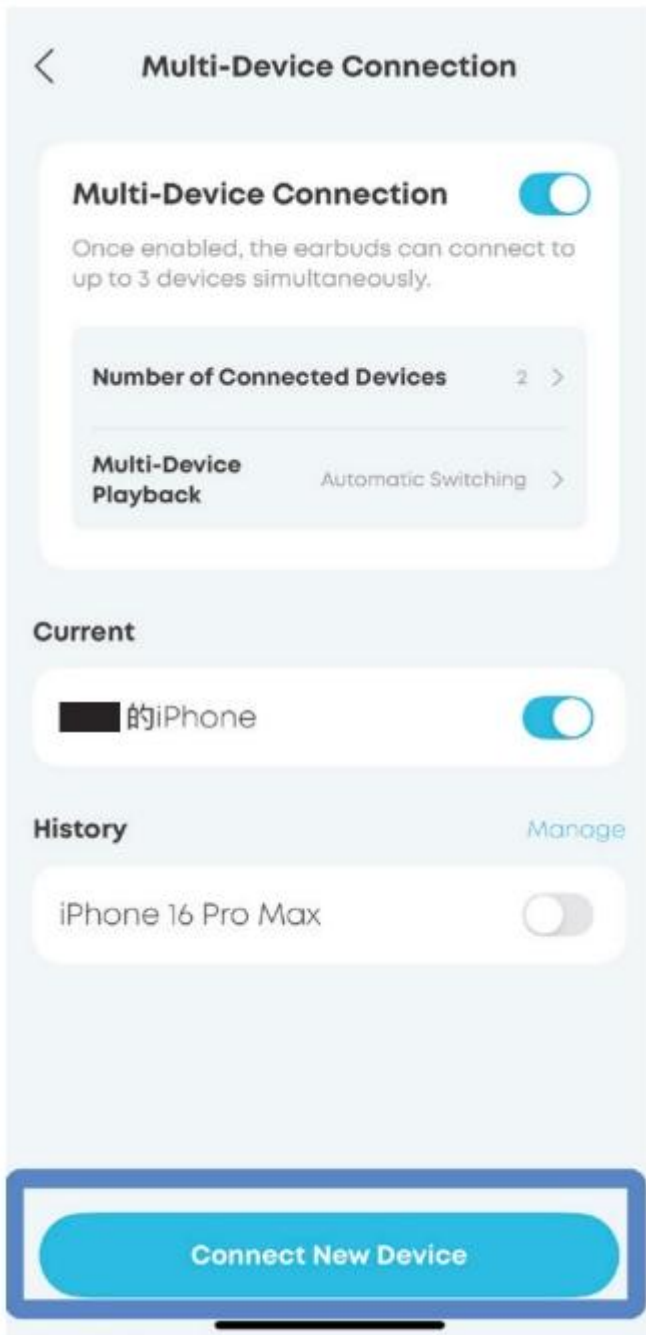

Number of Connected Devices

In this setting, you can select the number of connected devices in the soundcore app. By default, the earbuds can connect 2 devices simultaneously. The maximum number of connected devices is 3.

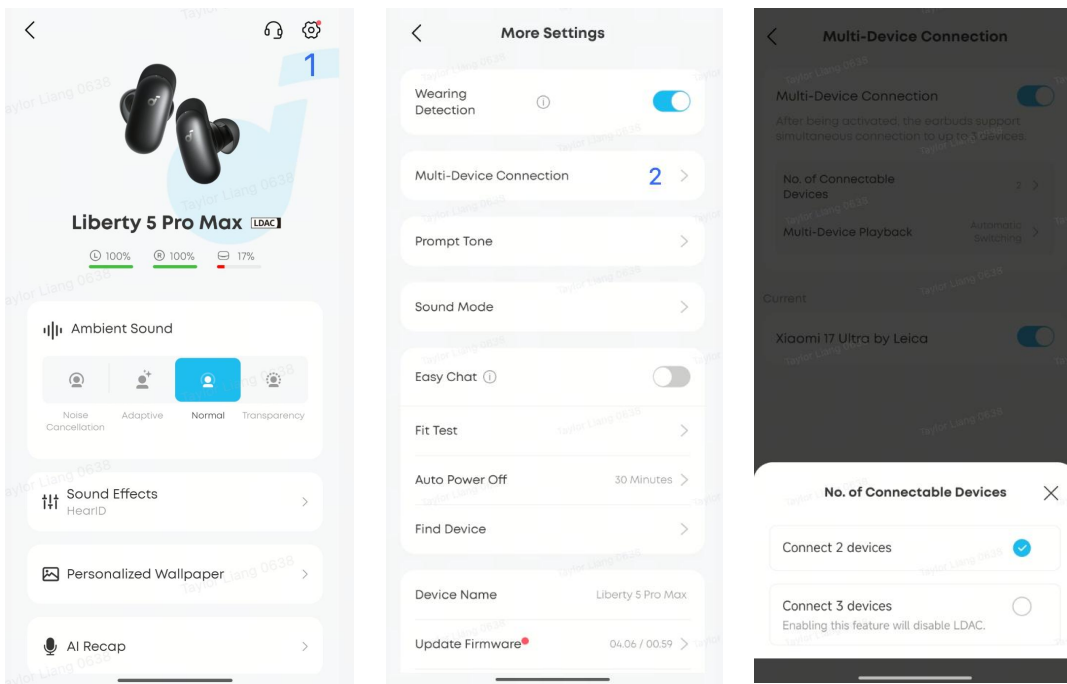

- LDAC is unavailable when the earbuds are connected to 3 devices simultaneously.

Multi-Device Playback

There are two audio playback switching modes available in the soundcore app, giving you the ideal flexibility for audio experience across smartphones, tablets, and computers.

- **Automatic Switching:** The earbuds intelligently switch to the device that starts playback, ensuring a smooth and uninterrupted listening experience.
- **Manual Switching:** To change devices manually, pause audio on the current device, then start playback on another connected device.

SMART DISPLAY



The Smart Display on the charging case shows you the battery level of both the charging case and earbuds, and provides easy control over multiple features.

Unlock: Swipe up to access the main interface.

Browse Features:

- Swipe left or right to scroll through available features.
- Tap a feature icon to open details.

Quick Access:

- Swipe down to open Control Center.
- Swipe up again (from unlocked state) to view full feature list.

There are a total of six features available for smart control via the charging case:

Ambient Sound: Adjust the ambient sound levels to suit your environment and preferences, ensuring an optimal listening experience.

Sound Effects: Customize your audio experience with preset sound modes to match your favorite music style.

Spatial Audio: Experience immersive 3D sound that adjusts dynamically based on your head movements, providing a more realistic audio experience.

Easy Chat: Automatically lowers the volume of music and enables Transparency mode so that you can have face-to-face conversations without removing the earbuds.

Remote Camera: With the camera feature activated on your phone, use the charging case to control your smartphone's camera remotely.

Find Device: Locate your misplaced earbuds within Bluetooth range by enabling them to

sound alerts.

CHARGING

1

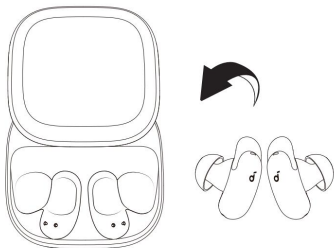

2

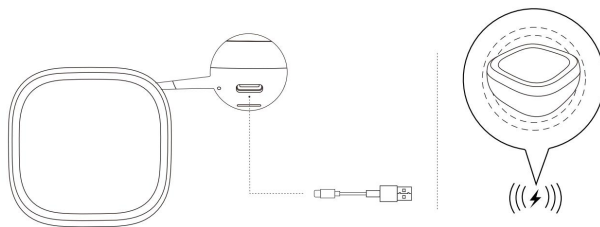

1. Place the earbuds in the charging case and close it.
 - Ensure the earbuds and the USB-C charging port are fully dry before charging.
2. Connect the charging case to a power supply using the provided USB-C charging cable. For wireless charging, place the charging case at the center of your wireless charger.
 - Recharging the charging case with the earbuds removed takes 3 hours via cable. A 5-minute charge of the earbuds provides 4 hours of playtime.

CONTROLS

Touch Control Area

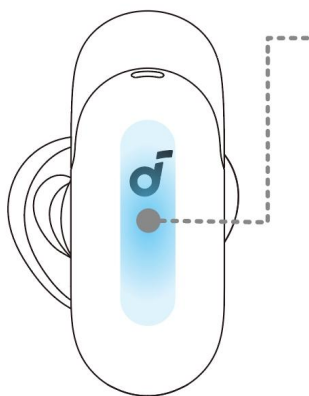

Touch Control Area

		Using Dual Earbuds	Using Single Earbud
	Play / Pause Audio	Double Tap (R)	Double Tap

	Play the Next Track	Double Tap (L)	/
📞	Answer a Call	Double Tap (L/R)	Double Tap
	Reject a Call / End a Call	Tap and Hold for 2 Seconds (L/R)	Tap and Hold for 2 Seconds
🔊	Increase Volume	Slide Up (L/R)	Slide Up
	Decrease Volume	Slide Down (L/R)	Slide Down
👂	Switch Between ANC and Transparency Modes	Tap and Hold for 2 Seconds (L/R)	Tap and Hold for 2 Seconds

- You can customize controls in the soundcore app.

Charging Case Button

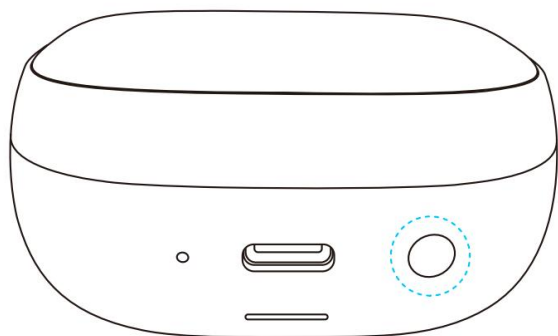

Turn on / off the Smart Display	Press Once
Enter Pairing Mode	Press and Hold for 3 Seconds
Reset the Device	Press and Hold for 10 Seconds

SOUND EFFECTS

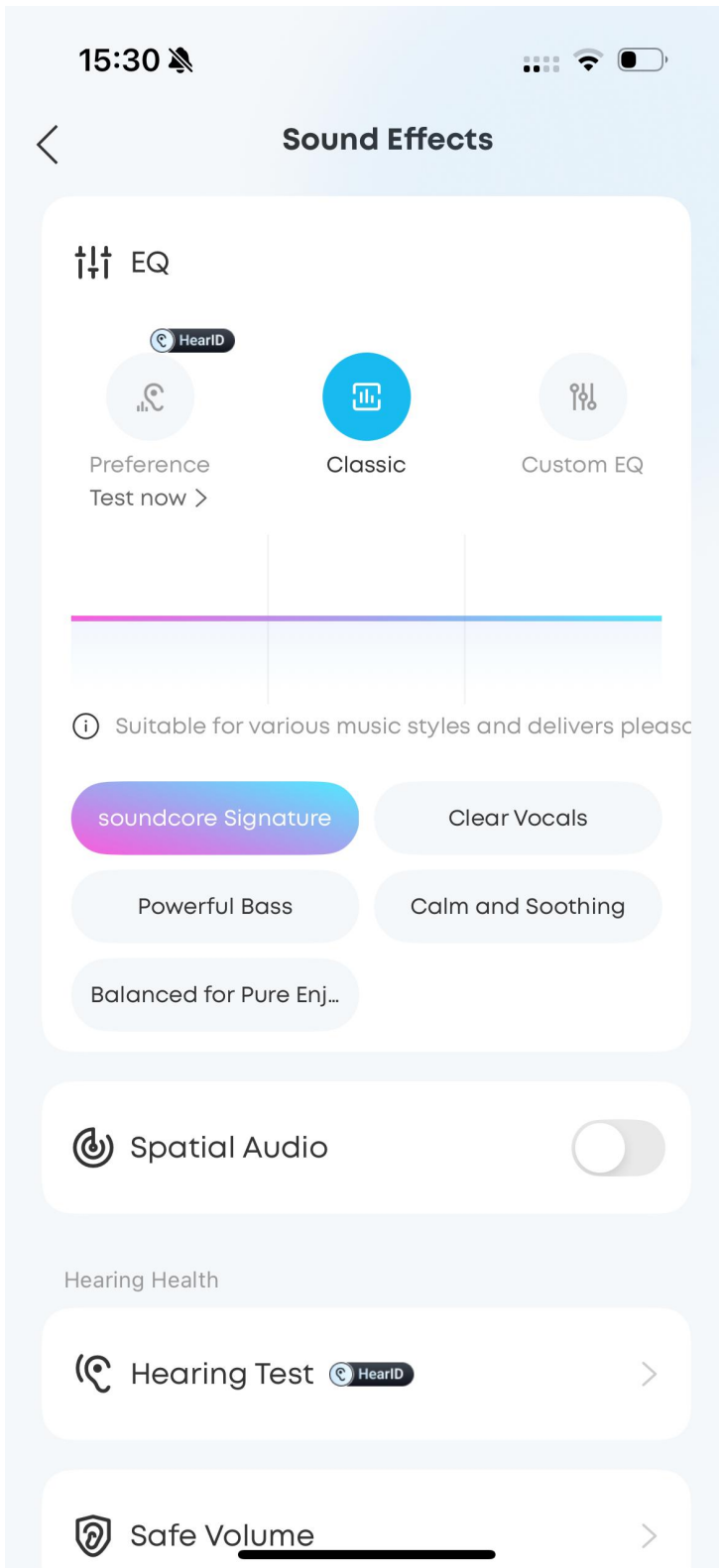

The soundcore app offers a range of preset EQ modes designed to match different listening preferences. Each preset EQ mode is carefully tuned to bring out distinct sound characteristics.

soundcore Signature (default): Suitable for various music styles and delivers pleasant listening experience.

Clear Vocals: Suitable for podcast, audiobooks, and music.

Powerful Bass: Suitable for hip-hop, rock, electronic, and dance music.

Calm and Soothing: Suitable for classical, jazz, and soothing music.

Balanced for Pure Enjoyment: Suitable for pop and blues music.

DOLBY ATMOS

Dolby Atmos creates an immersive listening experience by placing sound all around you.

Music Mode:

- **Head Tracking:** Hear surround sound that follows your head movement.
- **Fixed:** Listen to Spatial Audio without head tracking.

AMBIENT SOUND

Control with Smart Display

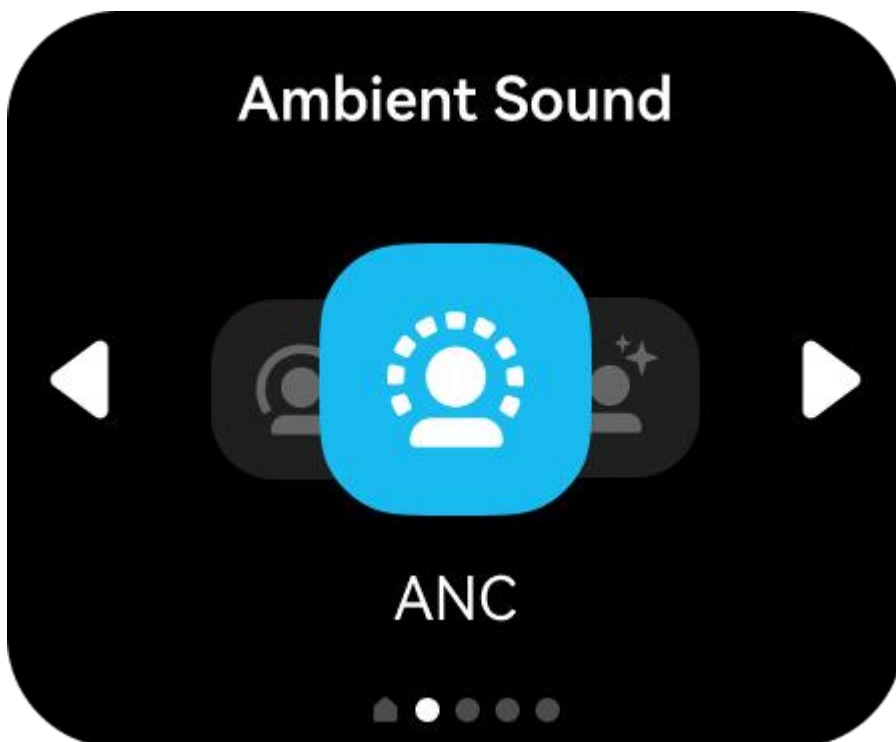

Easily switch between different ambient sound levels by tapping on the left/right arrow icon. In order to adjust other features, such as spatial audio, EQ, and other sound settings, you can slide left or right on the Smart Display.

Control with App

You can select from Noise Cancellation, Adaptive, Normal, or Transparency modes in the soundcore app.

- **Noise Cancellation (Level 1 to Level 5):** Adjust the strength of noise cancellation to match your environment.
- **Adaptive:** Experience seamless sound with Adaptive Noise Cancellation that intuitively tunes to your environment, preserving the perfect harmony between clarity and awareness.
- **Normal:** Enjoy balanced sound without noise cancellation.
- **Transparency:** Stay aware of your surroundings while listening to music.

EASY CHAT

Upon activation, Easy Chat mode automatically lowers the volume of music and amplifies the voice of the person you're talking to so that you can communicate without taking the earbuds off.

By default, when you have stopped talking for 5 seconds, your earbuds will automatically exit Easy Chat mode and resume the original ANC level and volume.

REMOTE PHOTO SNAP

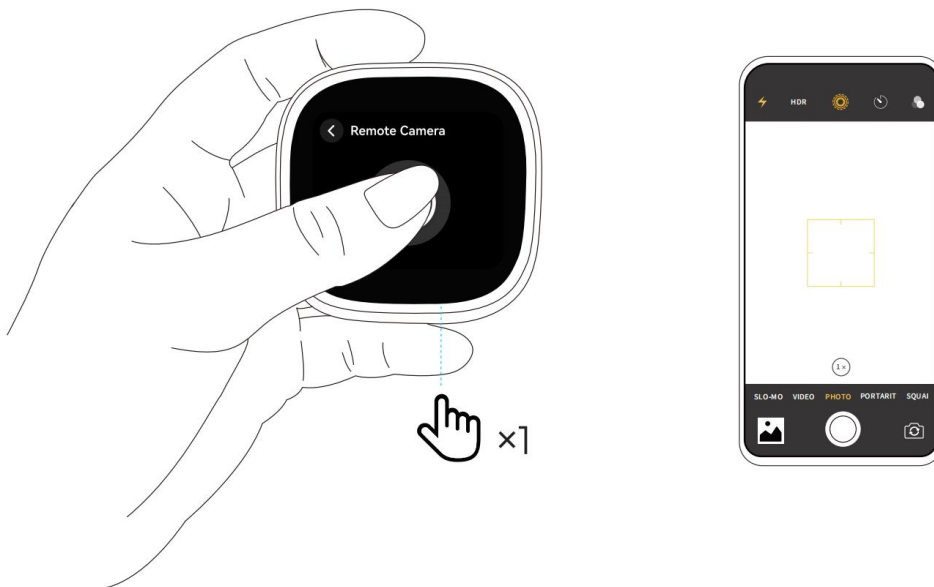

Make sure the earbuds are connected to your phone via Bluetooth. Then, open the camera on your phone and tap the Remote Camera shortcut on the Smart Display to remotely control your phone to take a photo.

- Due to system settings, this feature is not supported on some phones.

WEARING DETECTION

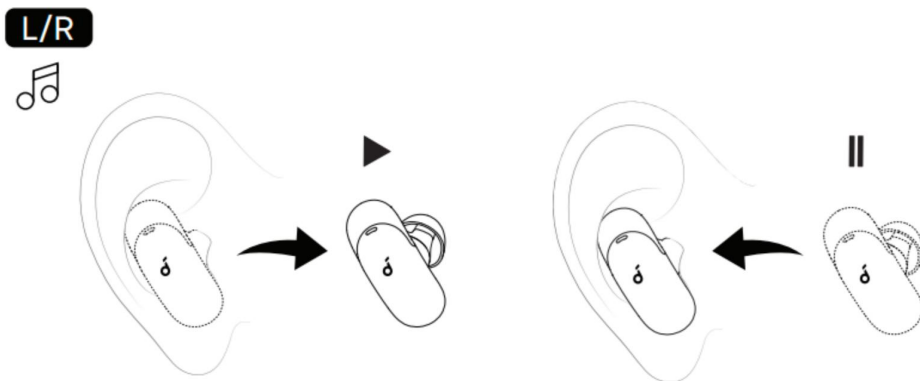

Your earbuds can automatically detect when you're wearing them.

Playback will pause when you remove an earbud, and resume as soon as you put it back on.

Wearing Detection is turned on by default. If you prefer to disable it, go to **Settings > Wearing Detection**, and toggle the switch to the left.

VOICE CONTROL

Enable voice control to control your earbuds hands-free with voice commands.

This feature currently supports command words in Chinese, English, Japanese, and German.

You can change voice command language anytime in app settings.

Access the complete voice command list in the soundcore app under **Settings > Voice Control**.

Note: Enabling voice control may reduce the earbuds' battery life.



Voice Control

Voice Control



After activation, you can operate the headphones through voice commands.

Language

Chinese

English

Japanese

German

Voice Commands

Say the following command words to activate.

Theme

Say:

🎵 Playback

Pause Audio
Start Playing
Resume Playing
Next Track
Previous Track

🔊 Volume

Increase Volume
Decrease Volume

☎️ Call

Answer Call
Reject Call

🔊 Ambient
Sound

ANC Mode
Adaptive Mode
Transparency Mode

AI NOTE-TAKER

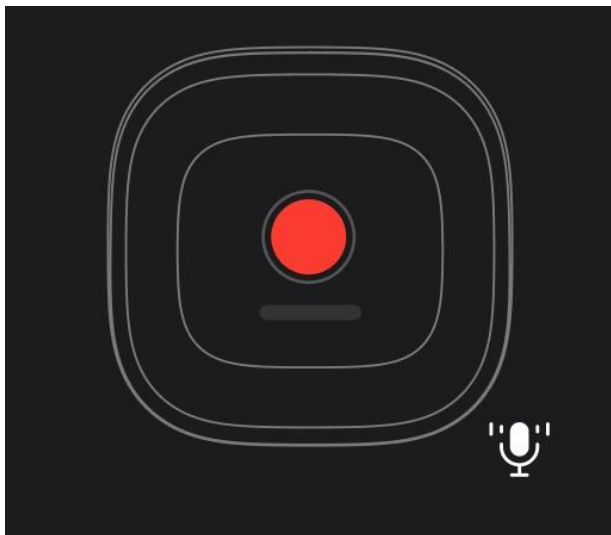

The AI Note-Taker feature supports instant audio recording, allowing users to record audio at any time when needed.

3 Ways to Start Recording

1. Open the feature list on the Smart Display, select **AI Note-Taker**, and tap the red record button on the screen to start recording.
2. Double-tap the charging case button to start recording.
3. Add **AI Note-Taker** to the common widget list in the widget settings. Once added, tap the widget to start recording.

Mark Highlights During Recording

During a recording session, there are two ways to mark important moments:

1. Tap the **Flag** icon on the Smart Display.
2. Single-tap the charging case button to mark a highlight.

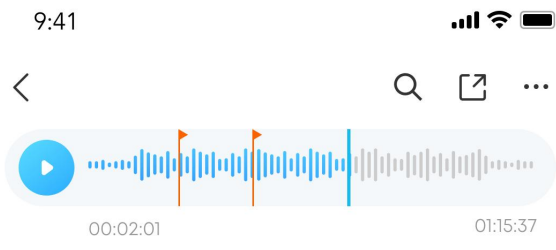

TWS Unify headphone and at product strategy

2025-01-13 12:30:38 1h 23m 54s Meeting

00:00

New Product Launch Strategy Meeting, Brainstorming session for our new product, on a Discussion on new product rollout plan on new product rollout plan.

00:30

New Product Launch Strategy Meeting, Brainstorming session

00:35

New Product Launch Strategy Meeting, Brainstorming session for our new product, on a Discussion on new product rollout plan on new product rollout plan

01:02

New Product Launch Strategy Meeting, Brainstorming session for our new product, on a Discussion on new product rollout plan on new product rollout plan

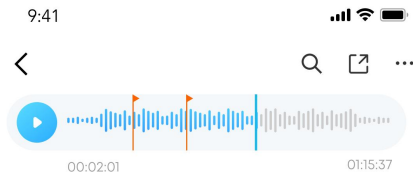

TWS Unify headphone and at product strategy

2025-01-13 12:30:38 1h 23m 54s Meeting

Mark

- 00:32
- 05:24 ... At present, the research and development of new products ...
- 01:16:44 ... At present, the research and development of new ...

Key Points

1. Main Points

Obtain news channels

Methods: Obtain the latest news through news websites, social media, news apps, and search engines

Popular news directions

Pay attention to international policy adjustments, breakthroughs in the field

of science and technology, financial data releases and domestic social hotspots

AI ASSISTANT

Before Use:

- Uninstall any previous versions of the soundcore app on your device and download the latest version.
- To use the AI assistant, download the soundcore app and keep it connected to your earbuds. On Android devices, adjust system settings to allow the app to run in the background.

Note:

- The AI assistant prioritizes your privacy and data security.
- AI-generated responses are for reference only and may contain inaccuracies, especially regarding political or sensitive topics. Please use your discretion.
- The images provided are for illustration purposes only.

What Anka Can Do for You

Function	What It Does	Example Command (Say the following to Anka after activating with "Hey Anka")
Answering Questions	Acts as your portable encyclopedia—ask any question anytime.	"Why do giraffes have such long necks?"
Casual Conversation	Chats with you like a friend would and helps you relax.	"Tell me a joke."
Information Aggregation	Provides you with daily news and updates.	"Tell me the latest tech news for today."
Information Lookup	Checks the weather, the latest match scores, and more.	"What's the weather like in New York today? Will I need an umbrella when I go out?"

- Some voice commands may not work due to app limitations.

How to Access the Feature

1. Tap **AI Assistant** in the home page, then go to **Settings** and enable **Say "Hey Anka" to activate**.

2. In the soundcore app, go to **Anka Page** > **Chat With Anka**.

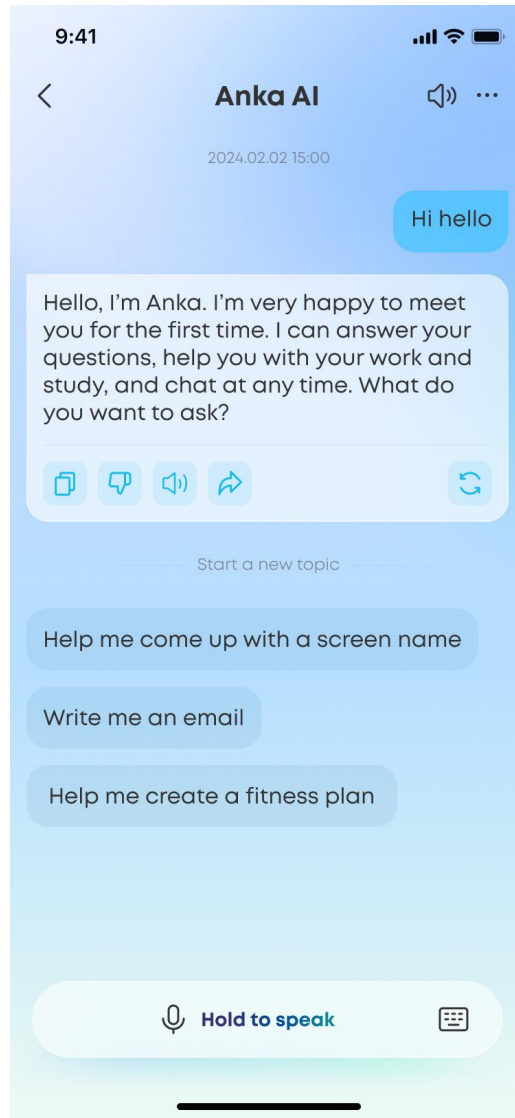
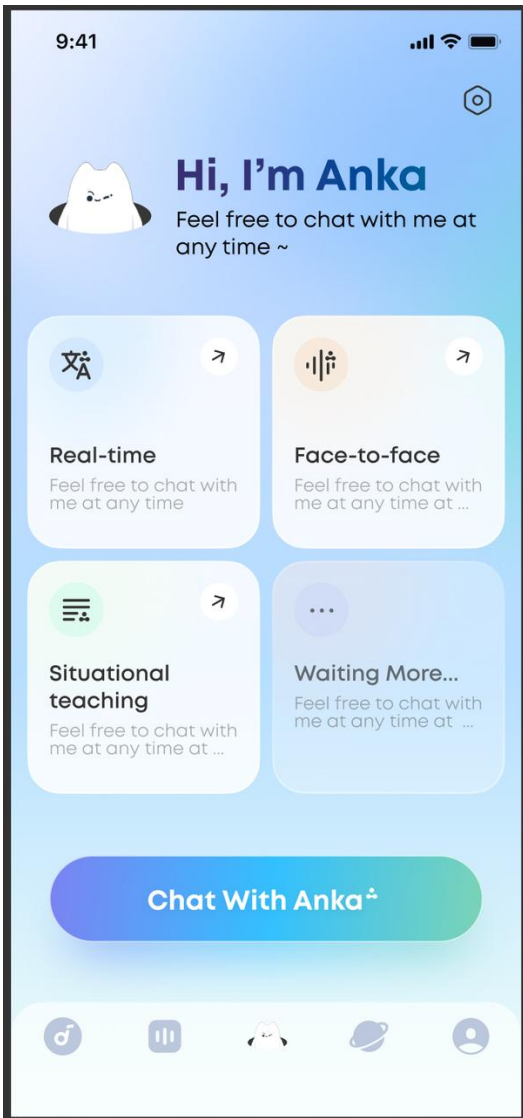

AI TRANSLATION

Note: Feature paths and interface visuals may change with software updates. For the most accurate

guidance, please refer to your latest app version.

Before Use:

- Please upgrade to the latest version of the soundcore app and ensure that your earbuds are connected to the app.
- Disable Multi-Device Connection.

Real-Time Translation

In settings where you're exposed to content in a foreign language for extended periods (e.g., lectures, classes), real-time translation delivers continuous text display and audio playback of the translated content with almost no lag.

In the soundcore app, go to **Anka page** and tap **Real-Time Translation**. Make sure your earbuds are connected to the app.

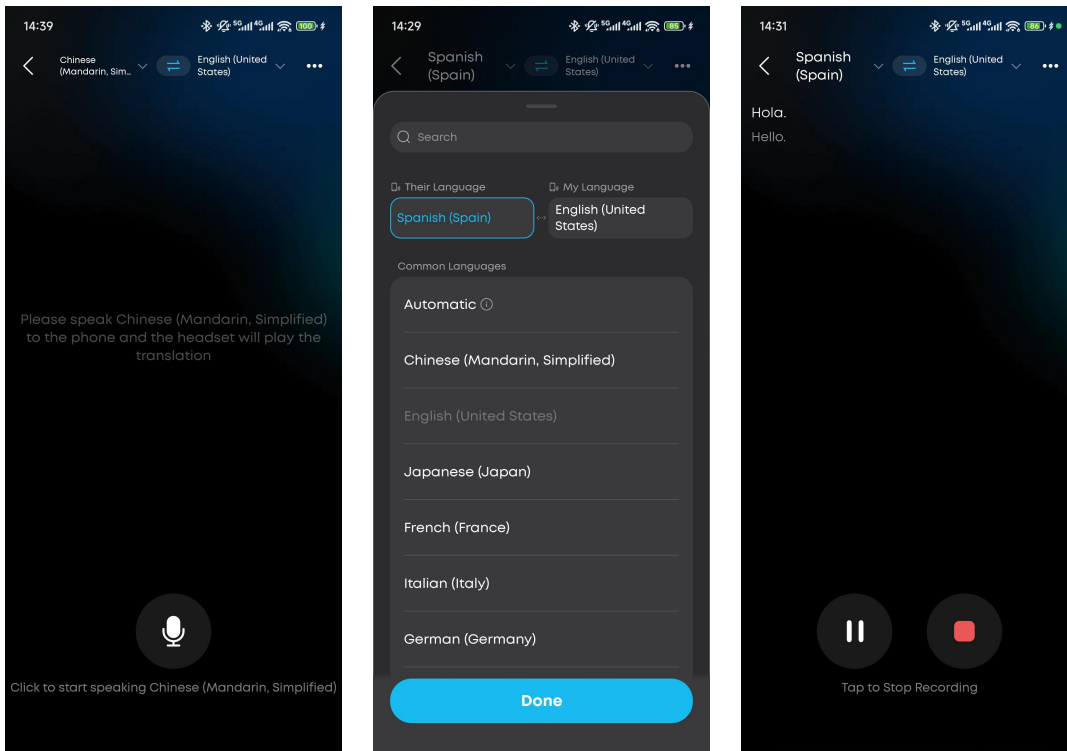

1. Tap **Real-Time Translation**.
2. Tap the language section at the top of the page, then select **Their Language** and **My Language**.
3. Tap the microphone button to start recording.

Face-to-Face Translation

In the soundcore app, go to **Anka page** and tap **Face-to-Face Translation**.

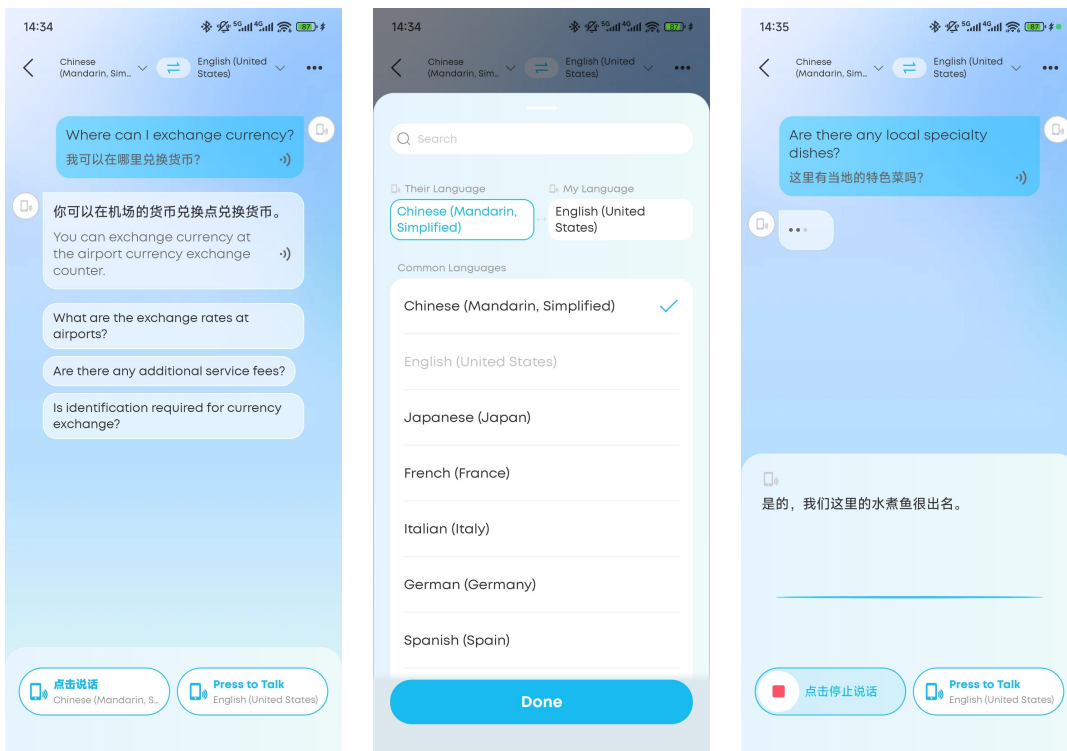

When your earbuds are connected to the app, follow the steps below to try out Face-to-Face Translation.

1. Tap the language section at the top of the page, then select **Their Language** and **My Language**.
2. Tap the bottom-right button and speak into your earbuds. The translation will play from your phone.
3. Tap the bottom-left button and speak into your phone. The translation will play from your earbuds.

Note: This feature works even if your earbuds aren't connected to the app. Just speak into your phone, and the translation will play through its speaker.

LDAC

Enable LDAC in the soundcore app to enjoy high-resolution audio on devices running Android 8.0 or later. This feature delivers higher sound quality but may increase power consumption and reduce playtime. For the best LDAC performance with stable Bluetooth connection, use LDAC in a low-interference environment.

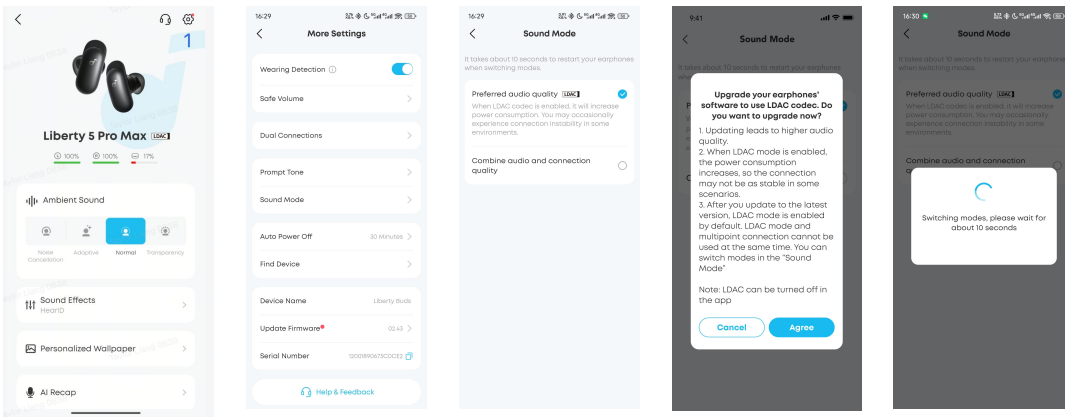

Follow the steps below to enable LDAC on your device:

1. Go to settings in the soundcore app.
2. Click on **"Sound Mode"**.
3. Select **"Preferred audio quality"** to switch to LDAC codec.
4. Switching audio codecs takes about 10 seconds. You may be prompted to update the firmware if a new version is available.

RESETTING

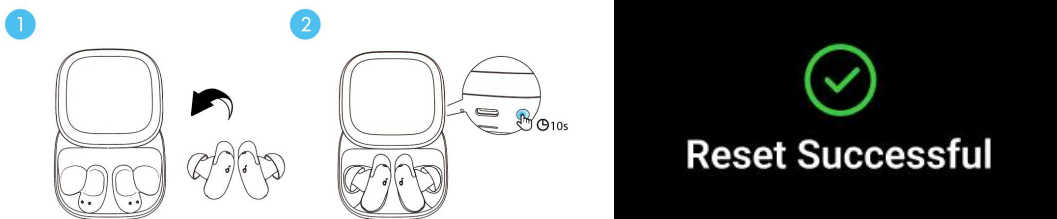

You might need to reset the earbuds if you experience any connectivity issues.

Place the earbuds in the charging case and leave the lid open. Press and hold the charging case button behind the charging case for 10 seconds. Upon a successful reset, the Smart Display will show a prompt.

POWERING OFF

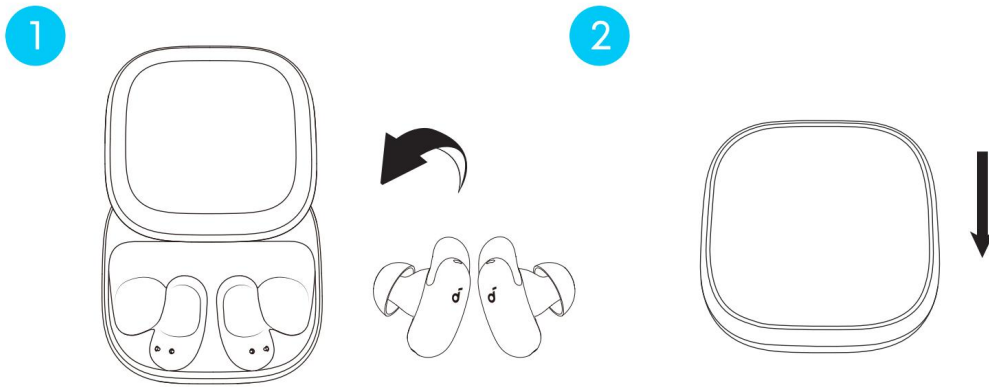

To power off, simply return the earbuds to the charging case and slide down the lid.

FIRMWARE UPDATE

You will be informed once a new firmware version is detected when you connect the earbuds to the app. Ensure the earbuds are placed in the charging case and the lid remains open until the firmware update is complete. During the update, ensure the earbuds are being charged and avoid using them.

SPECS

Specifications are subject to change without notice.

Input	5V=1A
Output	5V=0.54A (0.27A per port)
Battery Capacity	62mAh × 2 (Earbuds) 690mAh (Charging case)
Playtime (with ANC Off)	Up to 12 hours (50 hours in total with the charging case)
Playtime (with ANC On)	Up to 6.5 hours (28 hours in total with the charging case)
Charging Time	Up to 50 minutes (Earbuds) Up to 3 hours (Charging case)

Driver Unit	9.2mm dynamic driver
Frequency Response	10Hz-40kHz
Impedance	16Ω
Waterproof and Dustproof Rating (Earbuds)	IP55
Bluetooth Version	Bluetooth 6.1
Bluetooth Range	10 m / 33 ft