

ESSENZA  
MINI  
MY MACHINE

**Breville**

**NESPRESSO®**



Nespresso is an exclusive system creating the ultimate Espresso, time after time. All Nespresso machines are equipped with a unique extraction system that guarantees up to 19 bar pressure. Each parameter has been calculated with great precision to ensure that all the aromas from each capsule can be extracted, to give the coffee body and create an exceptionally thick and smooth crema.

**⚠ CAUTION:** when you see this sign, please refer to the safety precautions to avoid possible harm and damage.

**i Information:** when you see this sign, please take note of the advice for the correct and safe usage of your coffee machine.

## Content

Safety Precautions	4-6
Machine Overview	7
Specifications	7
First use or after a long period of non-use	8
Coffee Preparation	8-9
Programming the Water Volume	9
Energy saving mode	10
Reset to Factory Settings	10
Cleaning	11
Descaling	11-13
Emptying the system before a period of non-use and for frost protection, or before a repair	13
Troubleshooting	14
Disposal and environmental protection	14
Limited Guarantee	15
Contact the Nespresso Club	15

## Packaging Content

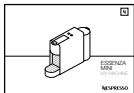

User manual



«Welcome to Nespresso» Folder



Nespresso capsule tasting gift

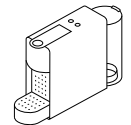

Coffee Machine



**⚠ Caution: when you see this sign, please refer to the safety precautions to avoid possible harm and damage.**

**ℹ Information: when you see this sign, please take note of the advice for the correct and safe usage of your appliance.**

**⚠ Caution: the safety precautions are part of the appliance. Read them carefully before using your new appliance for the first time. Keep them in a place where you can find and refer to them later on.**

- The appliance is intended to prepare beverages according to these instructions.
- Do not use the appliance for anything other than its intended use.
- This appliance has been designed for indoor and non-extreme temperature

conditions use only.

- Protect the appliance from direct sunlight effect, prolonged water splash and humidity.
- This appliance is intended to be used in households and similar applications only such as: staff kitchen areas in shops, offices and other working environments, farm houses; by clients in hotels, motels and other residential environments; bed and breakfast type environments.
- This appliance may be used by children of at least 8 years of age, as long as they are supervised and have been given instructions about using the appliance safely and are fully aware of the dangers involved. Cleaning and user maintenance shall not be made by children unless they are older than 8 and they are supervised by an adult.

- Keep the appliance and its cord out of reach of children under 8 years of age.
- This appliance may be used by persons with reduced physical, sensory or mental capabilities, or whose experience or knowledge is not sufficient, provided they are supervised or have received instruction to use the appliance safely and understand the dangers.
- Children shall not use the appliance as a toy.
- The manufacturer accepts no responsibility and the guarantee will not apply for any commercial use, inappropriate handling or use of the appliance, any damage resulting from use for other purposes, faulty operation, non-professionals' repair or failure to comply with the instructions.

**Avoid risk of fatal electric shock and fire.**

- In case of an emergency:

immediately remove the plug from the power socket.

- Only plug the appliance into suitable, easily accessible, earthed mains connections. Make sure that the voltage of the power source is the same as that specified on the rating plate. The use of an incorrect connection voids the guarantee.

**The appliance must only be connected after installation.**

- Do not pull the cord over sharp edges, clamp it or allow it to hang down.
- Keep the cord away from heat and damp.
- If the supply cord or the plug are damaged, they must be replaced by the manufacturer, its service agent or similarly qualified persons, in order to avoid all risks.
- If the cord or the plug are damaged, do not operate the appliance. Return the appliance to the *Nespresso*

- Club or to a *Nespresso* authorized representative.
- If an extension cord is required, use only an earthed cord with a conductor cross-section of at least 1.5 mm<sup>2</sup> or matching input power.
  - To avoid hazardous damage, never place the appliance on or beside hot surfaces such as radiators, stoves, ovens, gas burners, open flame, or similar.
  - Always place it on a horizontal, stable and even surface. The surface must be resistant to heat and fluids, like water, coffee, descaler or similar.
  - Disconnect the appliance from the mains when not in use for a long period. Disconnect by pulling out the plug and not by pulling the cord itself or the cord may become damaged.
  - Before cleaning and servicing, remove the plug from the mains socket and

let the appliance cool down.

- To disconnect the appliance, stop any preparation, then remove the plug from the power socket.
- Never touch the cord with wet hands.
- Never immerse the appliance or part of it in water or other liquid.
- Never put the appliance or part of it in a dishwasher.
- Electricity and water together is dangerous and can lead to fatal electrical shocks.
- Do not open the appliance. Hazardous voltage inside!
- Do not put anything into any openings. Doing so may cause fire or electrical shock!
- The use of accessory attachments not recommended by the manufacturer may result in fire, electric shock or injury to persons.

### **Avoid possible harm when operating the appliance.**

- Never leave the appliance unattended during operation.
- Do not use the appliance if it is damaged, has been dropped or not operating perfectly. Immediately remove the plug from the power socket. Contact the *Nespresso* Club or *Nespresso* authorized representative for examination, repair or adjustment.
- A damaged appliance can cause electrical shocks, burns and fire.
- Always completely close the lever and never lift it during operation. Scalding may occur.
- Do not put fingers under coffee outlet, risk of scalding.
- Do not put fingers into capsule compartment or the capsule shaft. Danger of injury!
- Water could flow around a capsule when not perforated by the blades and damage the appliance.
- Never use an already used, damaged or deformed capsule.
- If a capsule is blocked in the capsule compartment, turn the machine off and unplug it before any operation. Call the *Nespresso* Club or *Nespresso* authorized representative.
- Always fill the water tank with cold, fresh drinking water.
- Empty water tank if the appliance will not be used for an extended time (holidays, etc.).
- Replace water in water tank when the appliance is not operated for a weekend or a similar period of time.
- Do not use the appliance without the drip tray and drip grid to avoid spilling any liquid on surrounding surfaces.
- Do not use any strong

## EN Safety Precautions

cleaning agent or solvent cleaner. Use a damp cloth and mild cleaning agent to clean the surface of the appliance.

- To clean machine, use only clean cleaning tools.
- When unpacking the machine, remove the plastic film and dispose.
- This appliance is designed for *Nespresso* coffee capsules available exclusively through the *Nespresso* Club or your *Nespresso* authorized representative.
- All *Nespresso* appliances pass stringent controls. Reliability tests under practical conditions are performed randomly on selected units. This can show traces of any previous use.
- *Nespresso* reserves the right to change instructions without prior notice.

### Descaling

- *Nespresso* descaling agent, when used correctly, helps ensure the proper functioning of your machine over its lifetime and that your coffee experience is as perfect as the first day.
- Descale according to user manual recommendations.

### SAVE THESE INSTRUCTIONS

**Pass them on to any subsequent user.**

**This instruction manual is also available as a PDF at [nespresso.com](https://www.nespresso.com)**

# Machine Overview

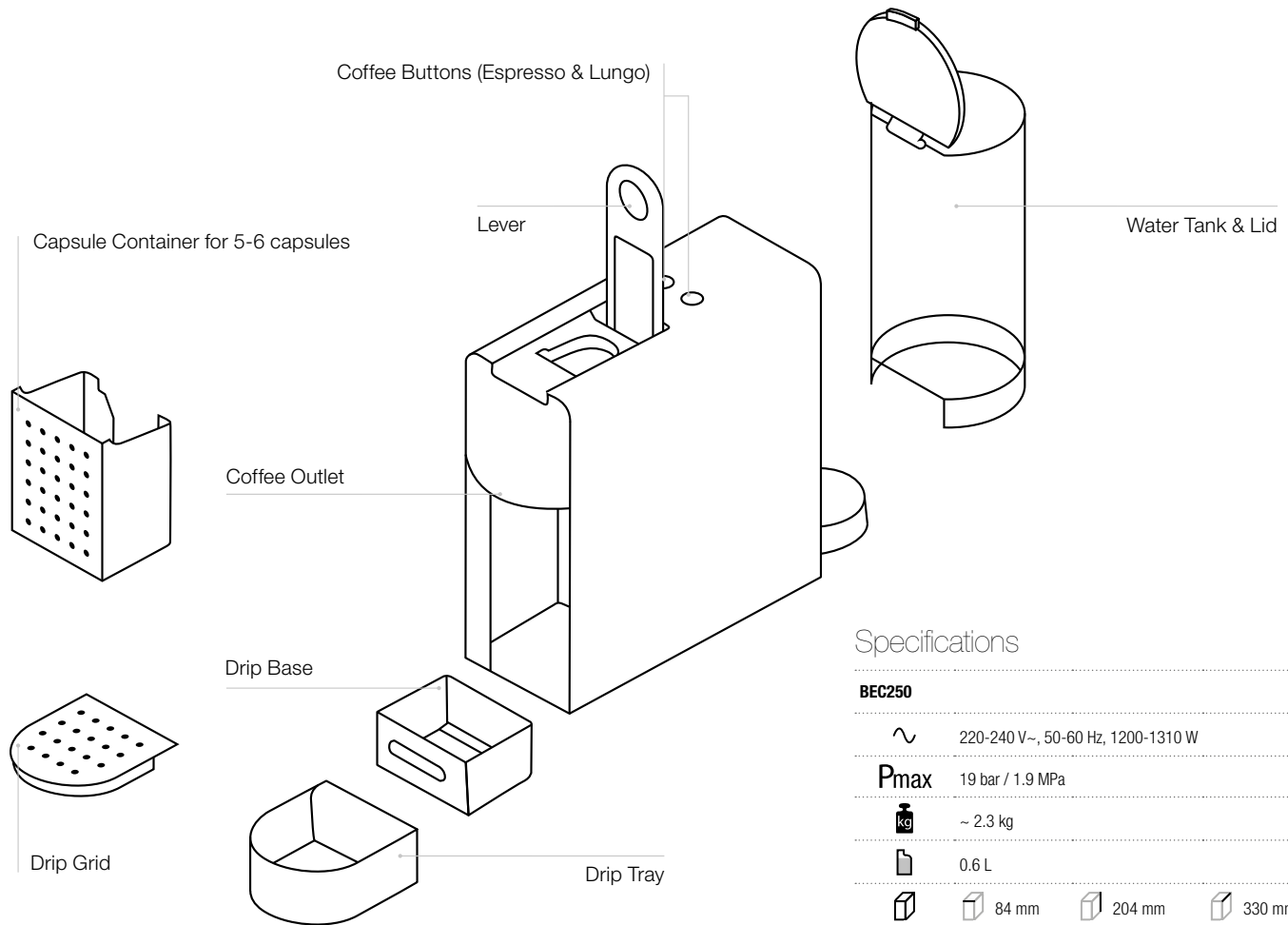

## Specifications

### BEC250

~ 220-240 V~, 50-60 Hz, 1200-1310 W

**Pmax** 19 bar / 1.9 MPa

 ~ 2.3 kg

 0.6 L

  84 mm  204 mm  330 mm

# EN First use or after a long period of non-use

**⚠ First, read the safety precautions** to avoid risks of fatal electrical shocks and fire.



**Factory settings:** Espresso cup: 40 ml, Lungo cup: 110 ml; Auto Off mode: 9 mins.

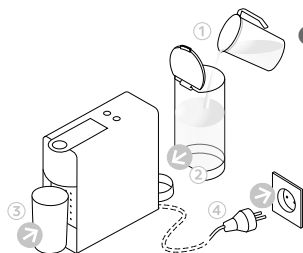

**1 Rinse the water tank** before filling with potable water. Place a container (min. 1 L) under coffee outlet. Plug into mains.

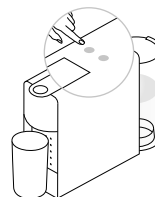

**2 To turn the machine ON**, press either the Espresso or Lungo button.  
- Blinking Lights: heating up (25 seconds)  
- Steady Lights: ready

**3 Press the Lungo button** to rinse the machine. Repeat 3 times.

**4 To turn the machine off** before automatic Auto Off mode, press both the Espresso and Lungo buttons simultaneously.

## Coffee Preparation

**1 To turn the machine ON**, press either the Espresso or Lungo button.  
Blinking Lights: heating up (25 seconds)  
Steady Lights: ready

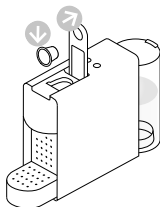

**2 Lift the lever** completely and insert the capsule.

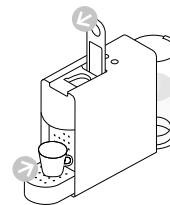

**3 Close the lever** and place a cup under the coffee outlet.



**⚠ Never lift the lever** during operation and refer to the safety precautions to avoid possible harm when operating the appliance.



**During heat up**, you can press either coffee button while blinking. The coffee will then flow automatically when the machine is ready.



- 4 Press the Espresso** (40 ml) or the Lungo (110 ml) button to start. Preparation will stop automatically. To stop the coffee flow or top up your coffee, press again.

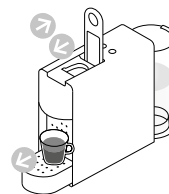

- 5 Remove the cup.** Lift and close the lever to eject the capsule into the used capsule container.

## Programming the Water Volume

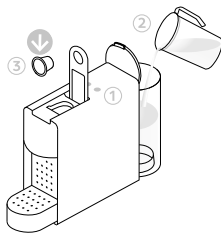

- 1 Turn the machine on** and wait for it to be in ready mode (steady lights). Fill the water tank with fresh potable water and insert the capsule.

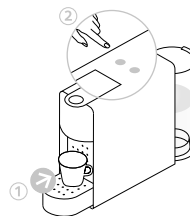

- 2 Place a cup** under the coffee outlet. Press and hold the Espresso or Lungo button. Release button once the desired volume is served. LED will blink fast 3 times to confirm new setting. Water volume level is now stored.

# EN Energy saving mode



This machine is equipped with an energy saving feature.



The machine will automatically enter Auto Off mode after 9 minutes.

To change this setting:

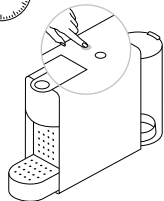
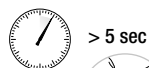

- 1 With machine being turned off, press and hold the Espresso button for 5 seconds. The Espresso button will blink to indicate the current setting.

- 2 To change this setting press the Espresso button:  
One time for Auto Off mode after 30 minutes.  
One more time for Auto Off mode after 9 minutes.

- ☀ 1x Single blinking: 9 mins mode
- ☀ 2x Double blinking: 30 mins mode

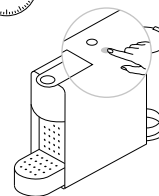
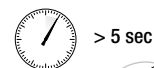

- 3 To exit the energy saving mode press the Lungo button for 5 seconds.

## Reset to Factory Settings



**Factory settings:** Espresso cup: 40 ml, Lungo cup: 110 ml; Auto Off mode: 9 mins.

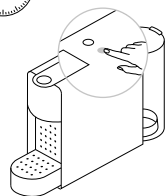
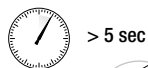

- 1 With machine turned off, press and hold down the Lungo button for 5 seconds.

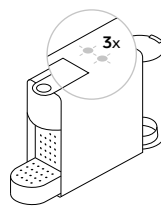

- 2 LEDs will blink fast 3 times to confirm machine has been reset to factory settings.

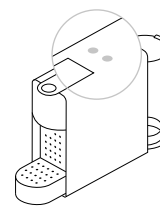

- 3 LEDs will then continue to blink normally, as heating up, until ready.  
- Steady Lights: ready

**⚠ Risk of fatal electrical shock and fire.** Never immerse the appliance or part of it in water. / Be sure to unplug the machine before cleaning. / Do not use any strong cleaning agent or solvent cleaner. / Do not use sharp objects, brushes or sharp abrasives. / Do not place in a dishwasher.

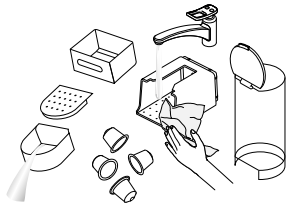

**1 Empty the drip tray, the drip base and the capsule container every day. Also remove the water tank with its lid and clean them all with odorless detergent and rinse with warm / hot water.**

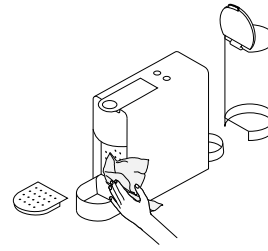

**2 Dry with a fresh and clean towel, cloth or paper and reassemble all parts. Clean the coffee outlet and inside the machine regularly with a damp cloth.**

## Descaling

[www.nespresso.com/descaling](http://www.nespresso.com/descaling)

**⚠ The descaling solution can be harmful.** Avoid contact with eyes, skin and surfaces. The following table will indicate the descaling frequency required for the optimum performance of your machine, based on water hardness. For any additional questions you may have regarding descaling, please contact your *Nespresso Club*.

# EN Descaling

[www.nespresso.com/descaling](http://www.nespresso.com/descaling)



**Duration** approximately 15 minutes.

- 1** Lift and close the lever to eject the capsule into the used capsule container.

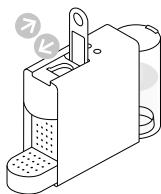

- 2** Empty the drip tray, drip base and used capsule container.

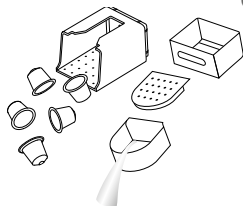

- 3** Pour 1 *Nespresso* descaling liquid sachet into the water tank. Fill the water tank up to the 0.6 L line with potable water.

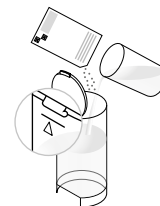

- 4** Place a container (min. volume 1 L) under the coffee outlet.

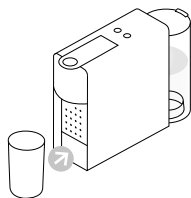

- 5** To enter the descaling mode, while the machine is turned on, press both the Espresso and Lungo buttons for 5 seconds.

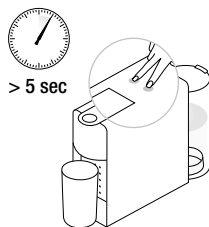

- 6** Both LEDs blink.

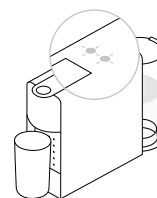

- 7** Press the Lungo button and wait until the water tank is empty.

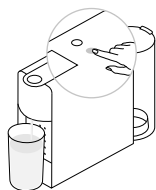

- 8** Refill the water tank with the used descaling solution collected in the container and repeat steps 4 and 7.

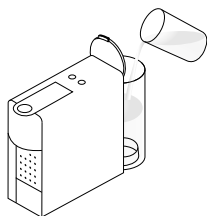

- 9** Empty and rinse the water tank. Fill with fresh potable water.



- 10 **When ready**, repeat steps 4 and 7 to now rinse the machine. Repeat twice.

- 11 **To exit the descaling mode**, press both the Espresso and Lungo buttons for 5 seconds.



- 12 **Empty** the drip base.

Water hardness			Descaling after:		
	fH	dH	CaCO <sub>3</sub>	Cups ☕ (40 ml)	
H	36	20	360 mg/l	300	fH French degree
M	18	10	180 mg/l	600	dH German Grade
L	0	0	0mg/l	1200	CaCO <sub>3</sub> Calcium Carbonate

## Emptying the system before a period of non-use and for frost protection, or before a repair

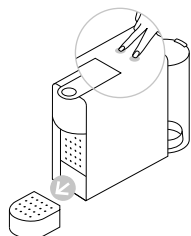

- 1 **To enter the emptying mode**, press both the Espresso and Lungo buttons to turn the machine off.

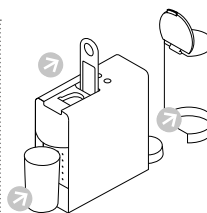

- 2 **Remove** the water tank and open the lever. Place a container under the coffee outlet.

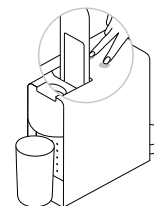

- 3 **Press both** the Espresso and Lungo buttons for 5 seconds. Both LEDs blink alternatively.

- 4 **Emptying process begins.** Machine switches off automatically when procedure is finished.

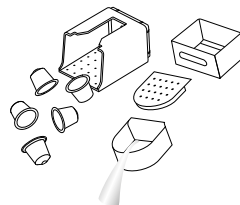

- 5 **Close** the lever. Empty and clean the used capsule container, the drip tray and the drip base.

<b>No light indicator.</b>	- <b>Check</b> the mains, plug, voltage, and fuse. In case of problems, <b>call</b> the <i>Nespresso</i> Club.
<b>No coffee, no water.</b>	-First use: <b>fill</b> water tank with warm water (max. 55° C) and <b>run through</b> machine according to instructions on page 8. -Water tank is empty. <b>Fill</b> water tank. - <b>Descale</b> if necessary; see Descaling section.
<b>Coffee comes out very slowly.</b>	-Flow speed depends on the coffee variety. - <b>Descale</b> if necessary; see Descaling section.
<b>Coffee is not hot enough.</b>	- <b>Preheat</b> cup. - <b>Descale</b> if necessary.
<b>Capsule area is leaking (water in capsule container).</b>	- <b>Position</b> capsule correctly. If leakages occur, <b>call</b> the <i>Nespresso</i> Club.
<b>Irregular blinking.</b>	- <b>Send</b> appliance to repair or <b>call</b> the <i>Nespresso</i> Club.
<b>No coffee, just water runs out (despite inserted capsule).</b>	-In case of problems, <b>call</b> the <i>Nespresso</i> Club.

---

## Disposal and environmental protection

**This appliance complies** with the EU Directive 2012/19/EC. Packaging materials and appliance contain recyclable materials.

Your appliance contains valuable materials that can be recovered or can be recycled. Separation of the remaining waste materials into different types facilitates the recycling of valuable raw materials. Leave the appliance at a collection point. You can obtain information on disposal from your local authorities.

To know more about *Nespresso* sustainability strategy, go to [www.nespresso.com/positive](http://www.nespresso.com/positive)

**Breville guarantees** this product against defects in materials and workmanship for two years domestic use (or 3 months commercial use) from the date of purchase. During this period, Breville will either repair or replace, at its discretion, any defective product at no charge to the consumer. In the event of a product or accessory being repaired or replaced during the guarantee period, the guarantee on the repaired product will expire two years from the purchase date of the original product, not two years from the date of repair. This guarantee excludes liability for consequential loss or any other loss or damage caused to property or person arising from any cause whatsoever. It also excludes defects caused by the product not being used in accordance with instructions, accidental damage, misuse, being tampered with by unauthorised persons, improper maintenance, consumable items or normal wear and tear and does not cover the cost of claiming under the warranty. Except to the extent applicable by law, the terms of this warranty do not exclude, restrict or modify, and are in addition to, the mandatory statutory rights applicable to the sale of the product to you.

### **How to Claim Under the Breville Warranty**

Nespresso is handling product enquiries and product servicing on Breville's behalf. If you believe your product is defective, contact the Nespresso customer service team directly for instructions on where to send or bring it for repair by a Breville authorised service agent. Contact Nespresso Australia: 1800 623 033 or New Zealand: 0800 234 579 [auclub@nespresso.com](mailto:auclub@nespresso.com)

This product is imported and distributed by Breville and this warranty is provided by Breville. To the extent permitted by law, Nespresso has no liability for the product and all guarantees, warranties and conditions by Nespresso are excluded.

---

## Contact the Nespresso Club

**As we may not have foreseen all uses of your appliance**, should you need any additional information, in case of problems or simply to seek advice, call the Nespresso Club or your Nespresso authorized representative.

Contact details for your nearest Nespresso Club or your Nespresso authorized representative can be found in the "Welcome to Nespresso" folder in your machine box or at [nespresso.com](http://nespresso.com)



BEC250  
by *Nespresso*

