

SLATE

GP71



MONTAGEHANDLEIDING

MONTAGEANLEITUNG

NOTICE DE MONTAGE

ISTRUZIONI DI MONTAGGIO



BILT®

Download on the
App Store

GET IT ON
Google Play

8657132

020226

NL / DE / FR / IT



NL

- ⚠ Monteer de barbecue op een vlakke, horizontale en zachte ondergrond.
- ⚠ Verwijder alle verpakkingsmaterialen en beschermfolie voordat je de barbecue in gebruik neemt.
- ⚠ Gebruik geen elektrisch gereedschap voor de montage.
- ⚠ Er zijn twee personen nodig voor de montage.
- ⚠ Er zijn mogelijk visuele verschillen te zien tussen de afbeeldingen en het model dat je hebt aangeschaft.

DE

- ⚠ Den Grill auf einem flachen, ebenen und weichen Untergrund montieren.
- ⚠ Vor der Inbetriebnahme des Grills sämtliches Verpackungsmaterial und alle Schutzfolien entfernen.
- ⚠ Für die Montage keine Elektrowerkzeuge verwenden.
- ⚠ Die Montage muss von zwei Personen durchgeführt werden.
- ⚠ Das erworbene Modell kann geringfügig von der Darstellung abweichen.

FR

- ⚠ Procédez au montage du barbecue sur une surface plane, horizontale et non rugueuse.
- ⚠ Retirez tous les éléments d'emballage et le film protecteur avant d'allumer votre barbecue.
- ⚠ N'utilisez pas d'outils électriques pour le montage.
- ⚠ Le montage requiert deux personnes.
- ⚠ Les illustrations et le modèle acheté peuvent présenter des différences visuelles.

IT

- ⚠ Montare il barbecue su una superficie piana, orizzontale e morbida.
- ⚠ Rimuovere tutti gli imballaggi e la pellicola protettiva prima di accendere il barbecue.
- ⚠ Non utilizzare utensili elettrici per il montaggio.
- ⚠ Per il montaggio sono necessarie due persone.
- ⚠ Il modello acquistato potrebbe differire visivamente da quello illustrato.

BENODIGD GEREEDSCHAP:**ERFORDERLICHE WERKZEUGE:****OUTILS NÉCESSAIRES :****UTENSILI NECESSARI:**

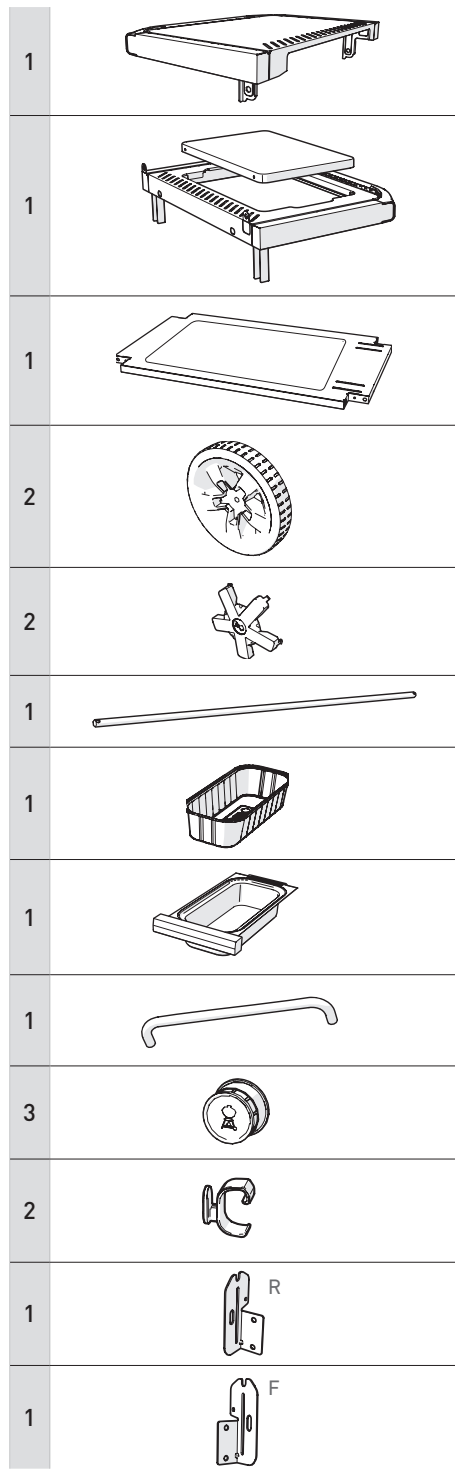
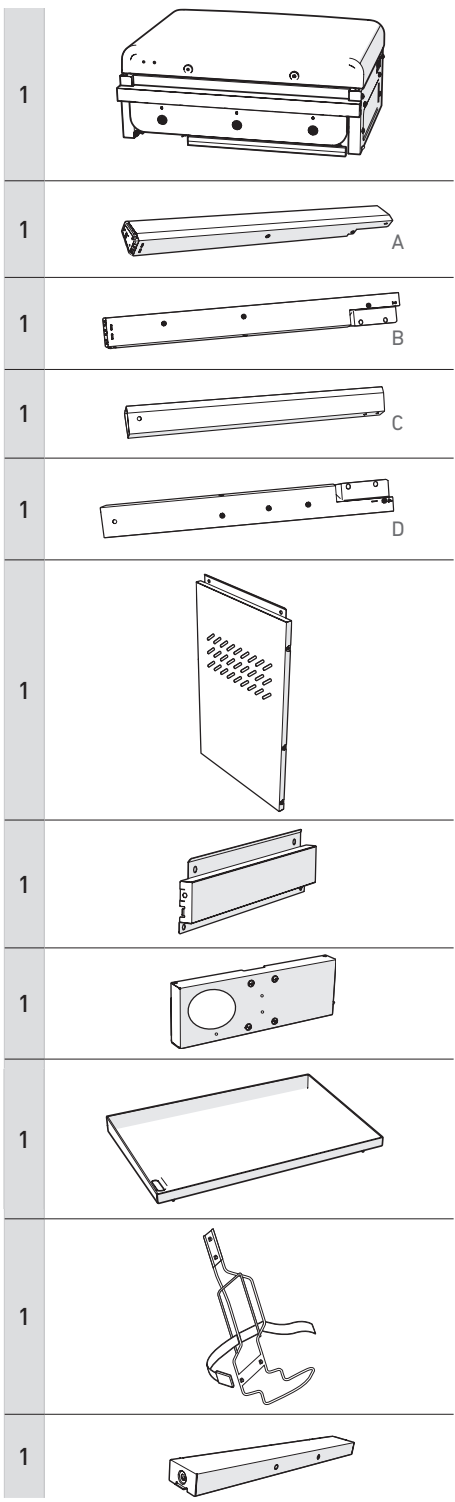

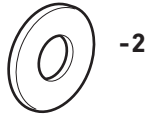
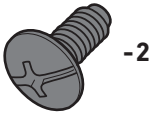
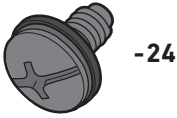

1

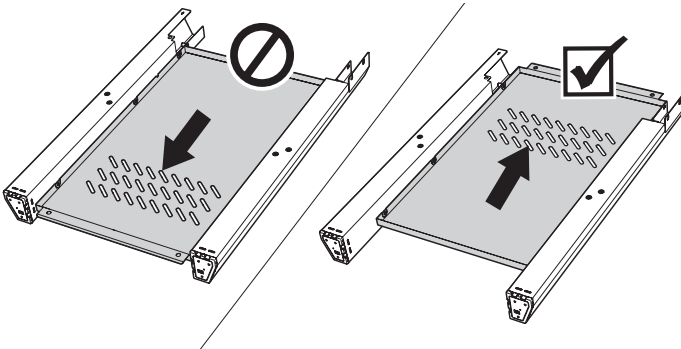
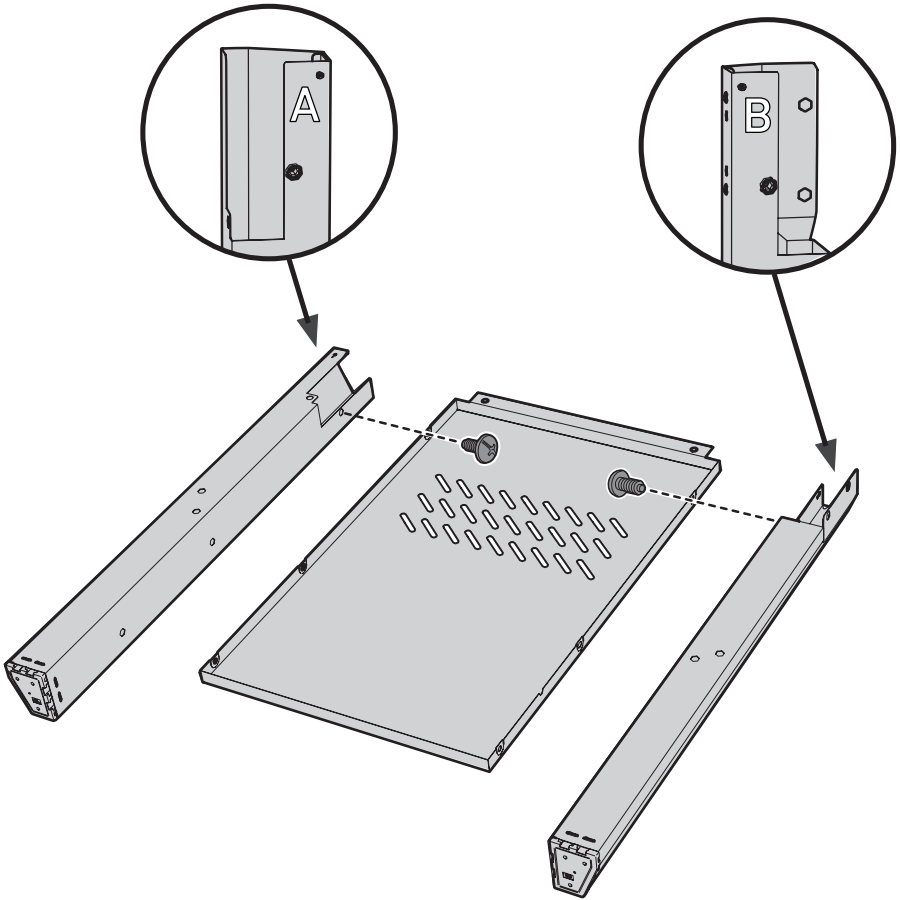

2

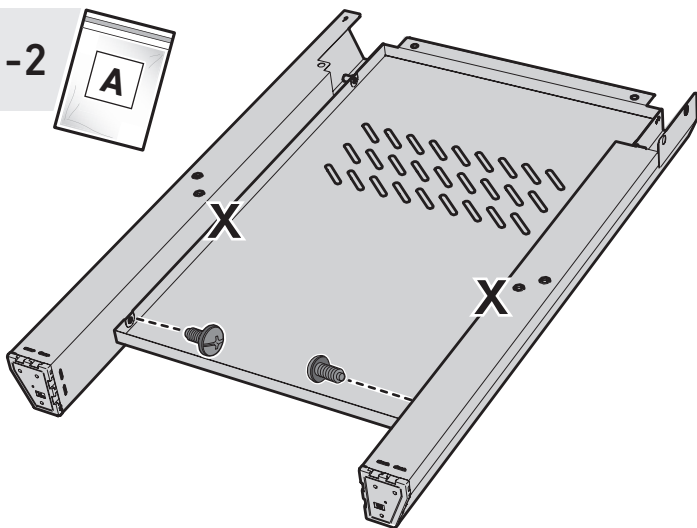
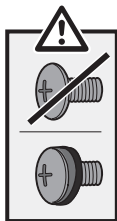

3

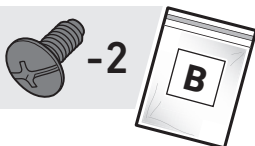

- ⚠ Alleen handvast aandraaien.
- ⚠ Nur handfest anziehen.
- ⚠ Serrez uniquement à la main.
- ⚠ Serrare solo manualmente.

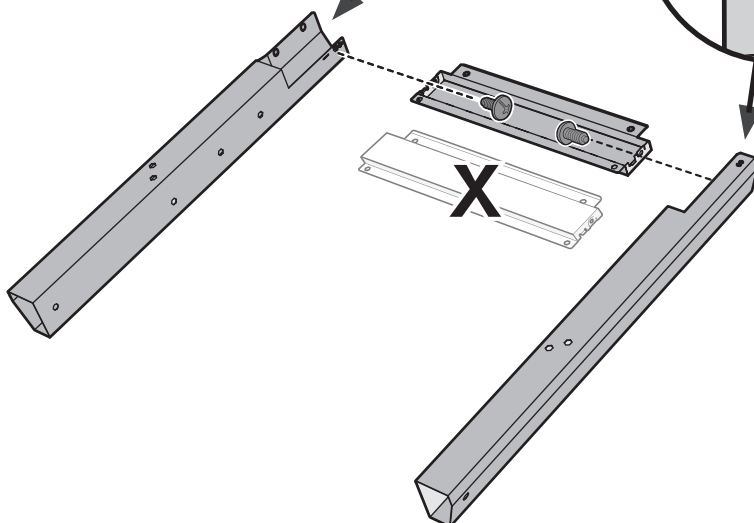
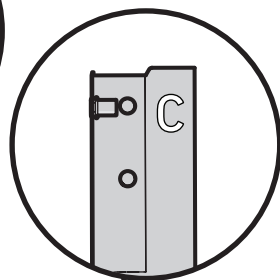
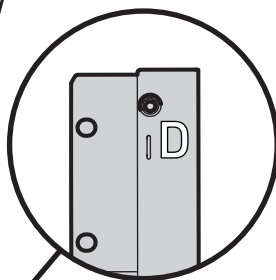

4



- ⚠ Alleen handvast aandraaien.
- ⚠ Nur handfest anziehen.
- ⚠ Serrez uniquement à la main.
- ⚠ Serrare solo manualmente.

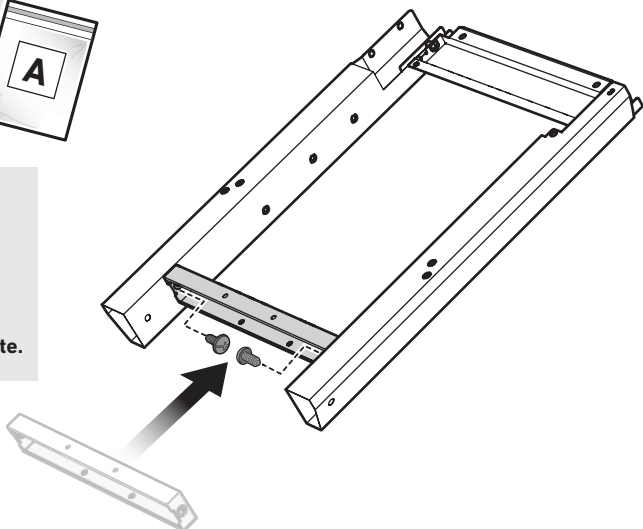

5

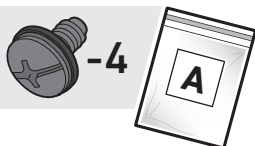

- ⚠ Draai alle schroeven goed vast.
- ⚠ Alle Schrauben vollständig festziehen.
- ⚠ Serrez toutes les vis à fond.
- ⚠ Serrare completamente tutte le viti.

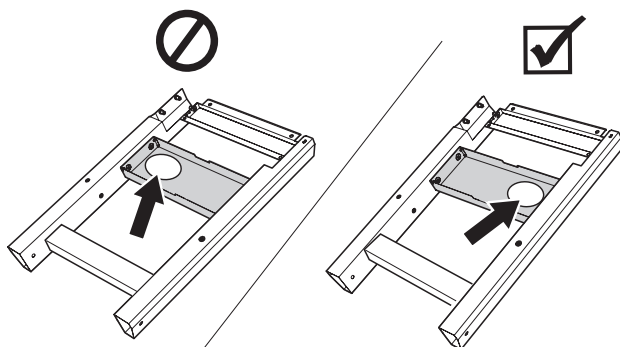
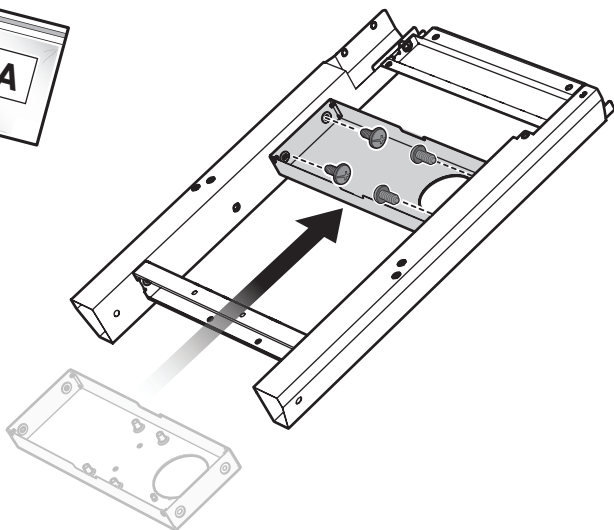

6

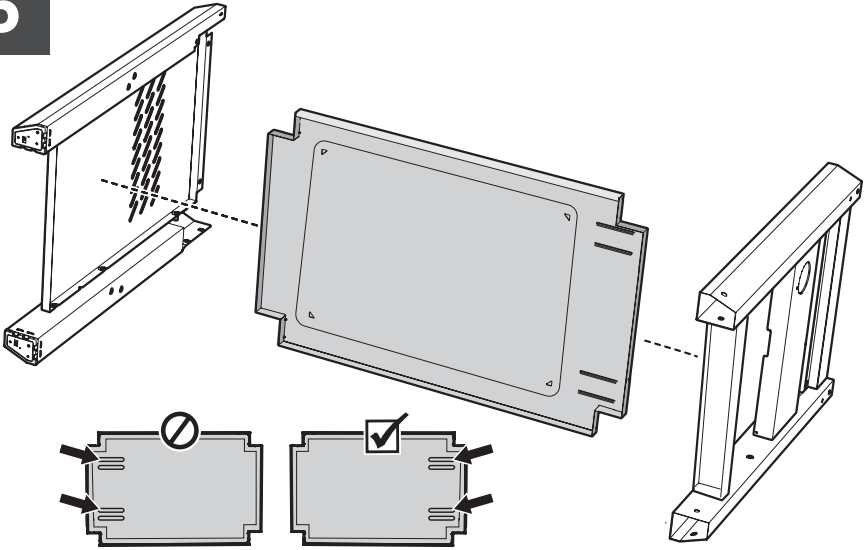

7



- ⚠ Alleen handvast aandraaien.
- ⚠ Nur handfest anziehen.
- ⚠ Serrez uniquement à la main.
- ⚠ Serrare solo manualmente.

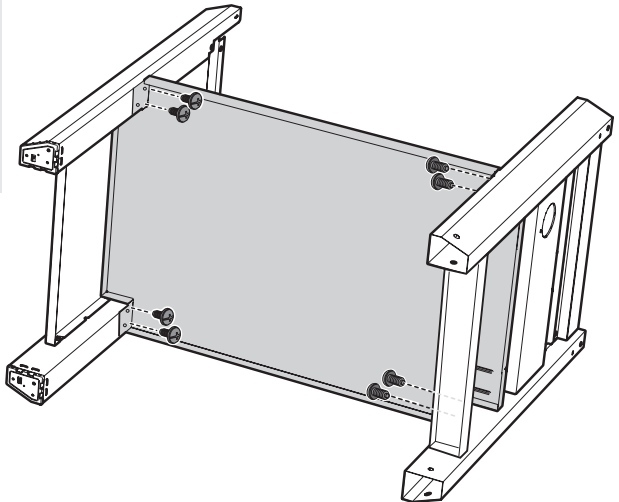

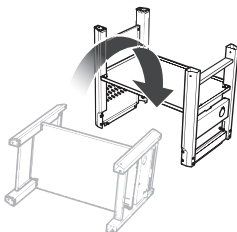
8**-4**

⚠ Draai alle schroeven goed vast.

⚠ Alle Schrauben vollständig festziehen.

⚠ Serrez toutes les vis à fond.

⚠ Serrare completamente tutte le viti.

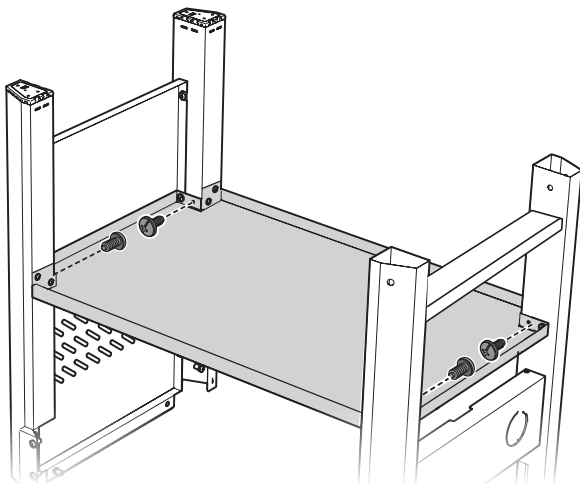
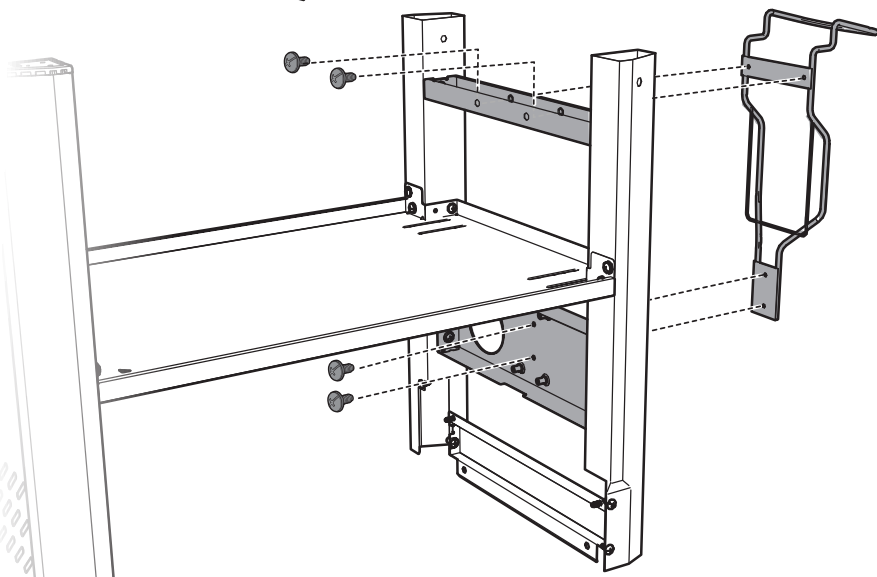
**9****-4**

10



-2

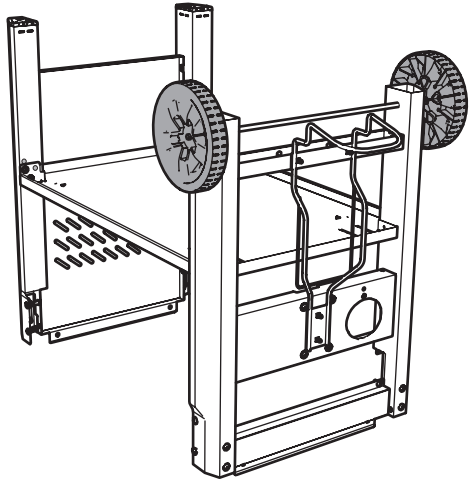
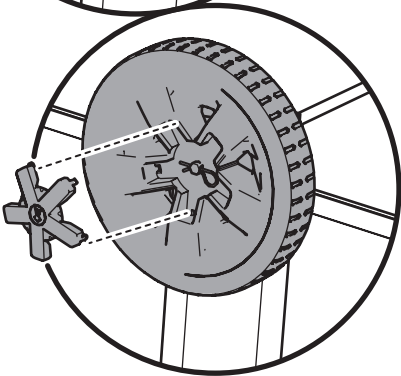
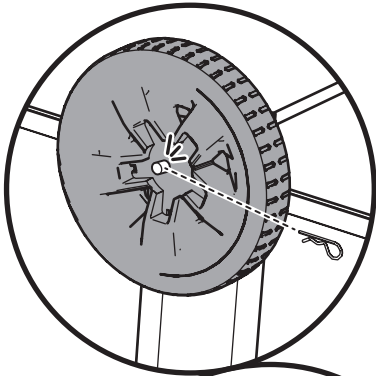
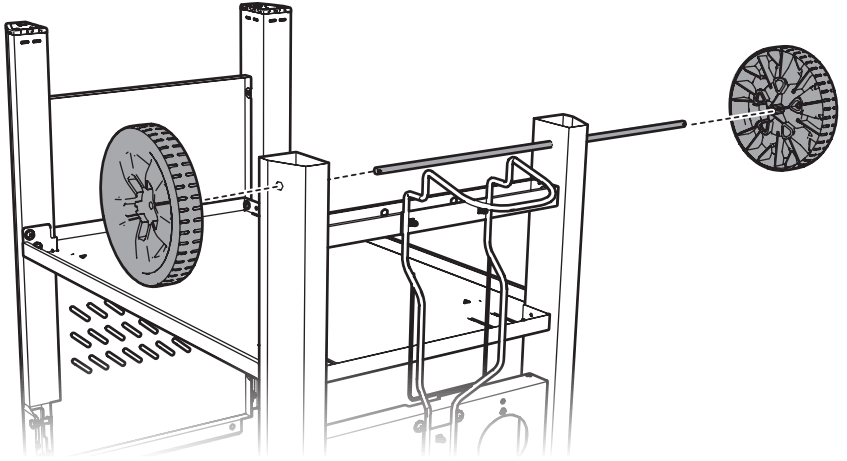
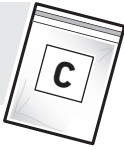

11

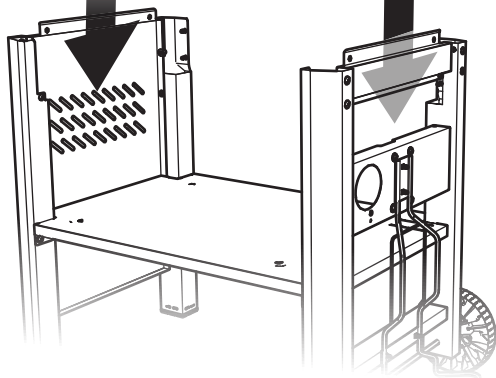
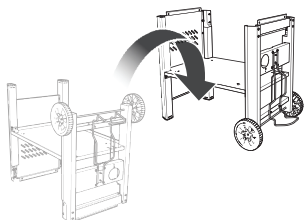
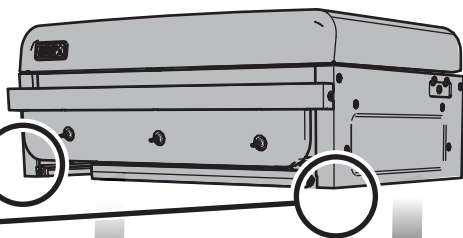

12



-4

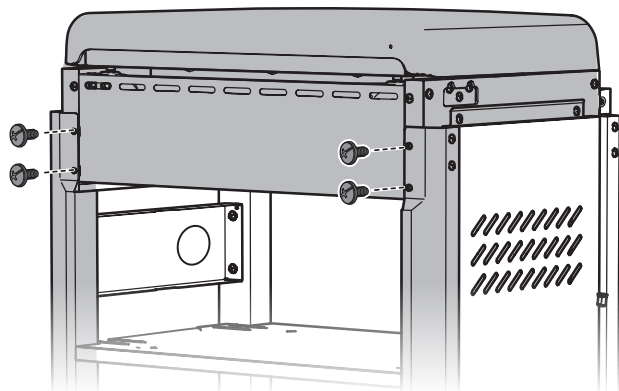
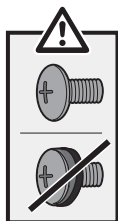
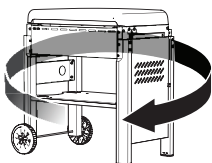

⚠️ Alleen handvast aandraaien.

⚠️ Serrez uniquement à la main.

⚠️ Nur handfest anziehen.

⚠️ Serrare solo manualmente.

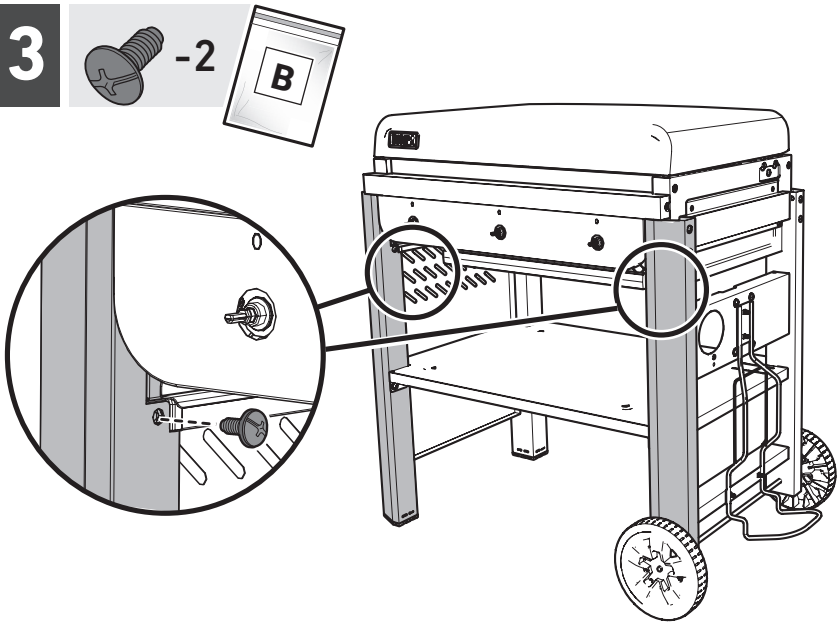
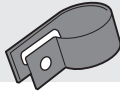
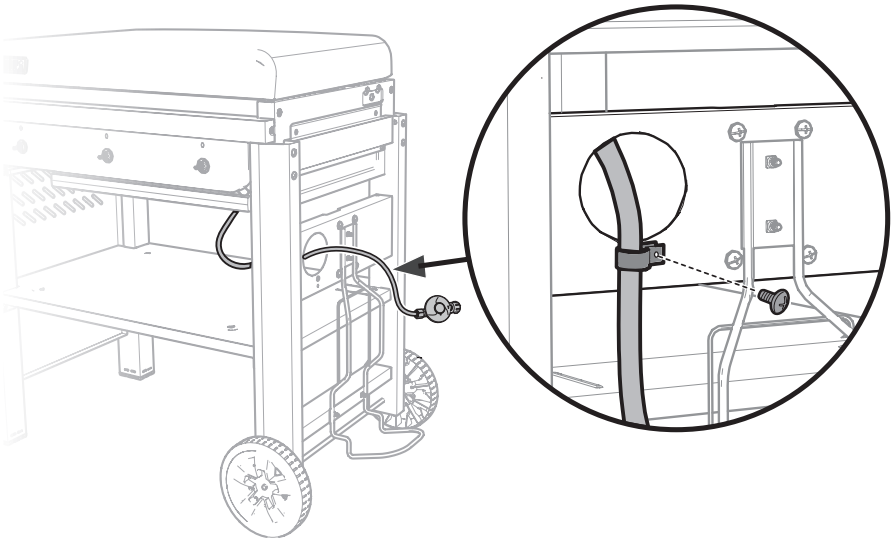
13**-2****B****14****-1****-1****C**

Raadpleeg de gebruikershandleiding voor de volledige instructies voor de gasaansluiting.

Siehe Benutzerhandbuch für eine umfassende Gasanleitung.

Reportez-vous à la notice d'utilisation pour des instructions complètes sur le gaz.

Per le istruzioni complete sul gas, vedere il Manuale utente.

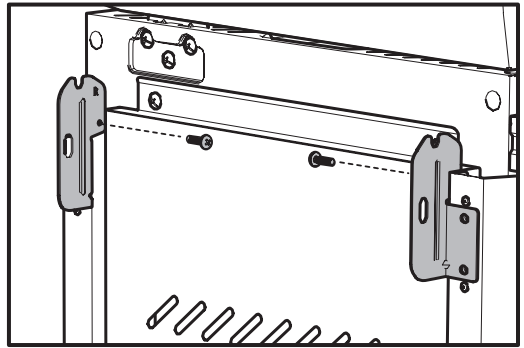
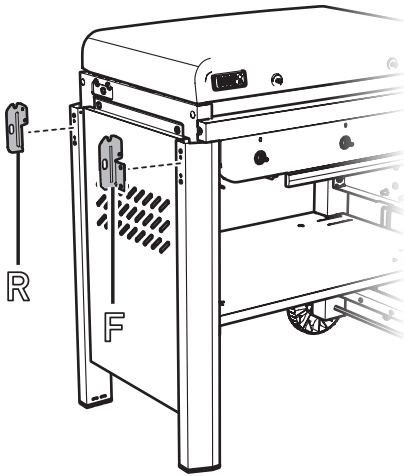
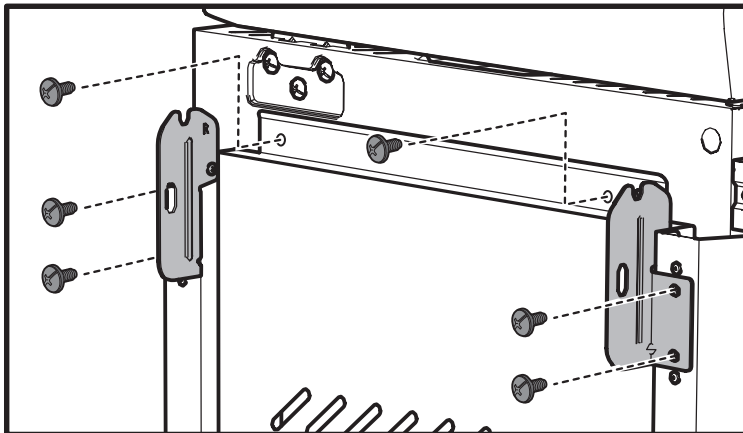
15**-2****16****-6**

17



-2

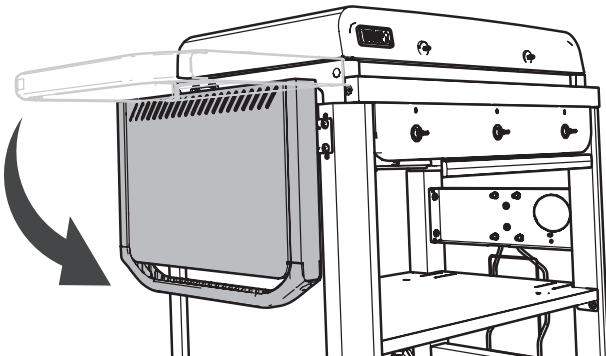
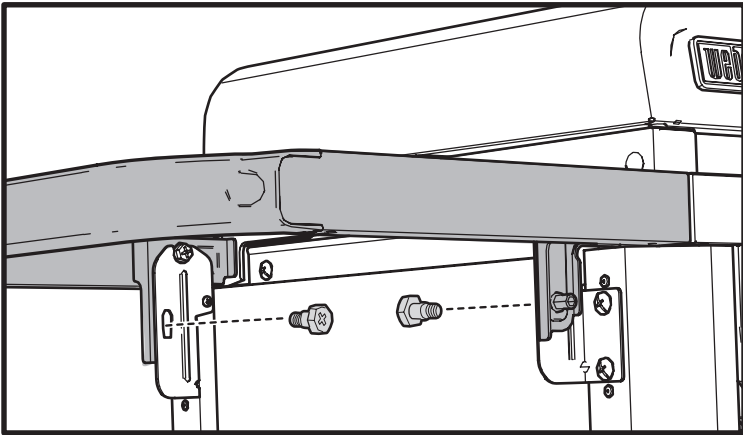
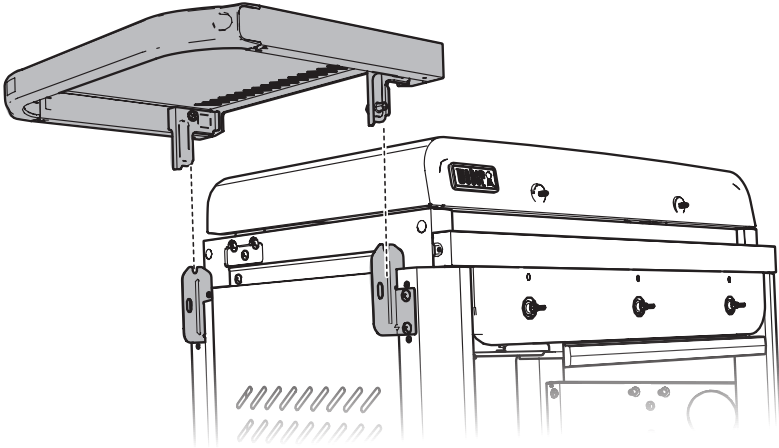

18



-10



⚠ Alleen handvast
aandraaien.

⚠ Nur handfest anziehen.

⚠ Serrez uniquement
à la main.

⚠ Serrare solo manualmente.

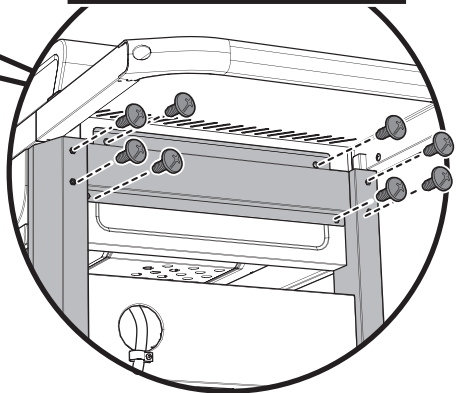
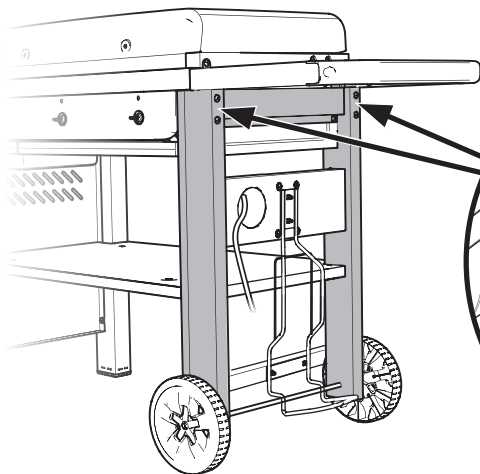
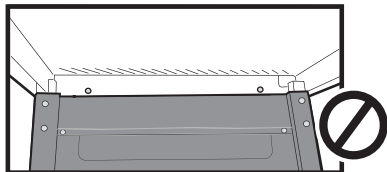
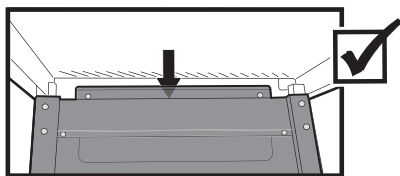
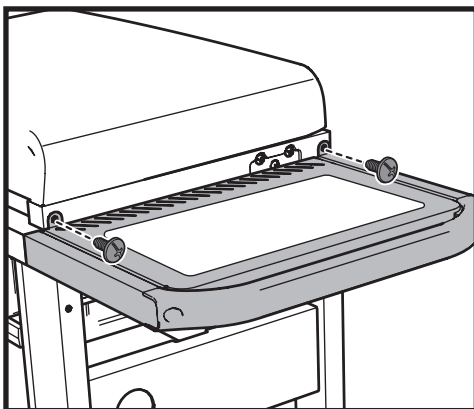
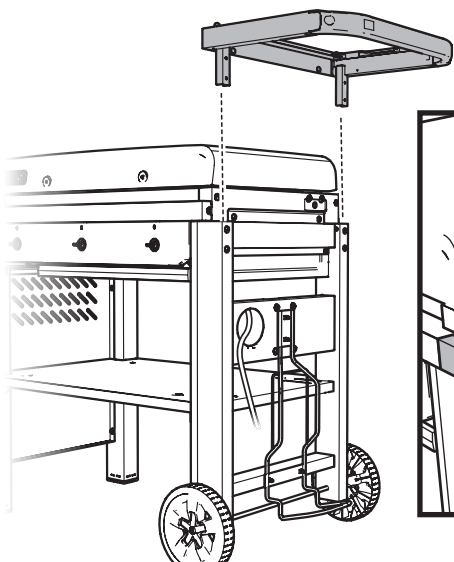

19

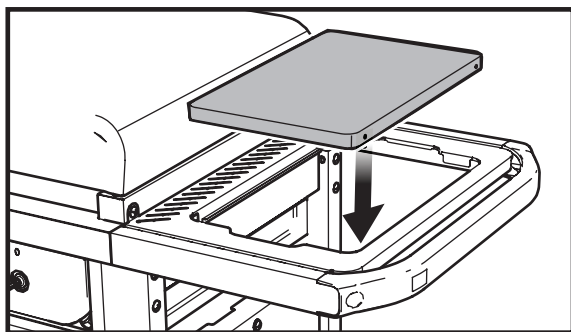

20

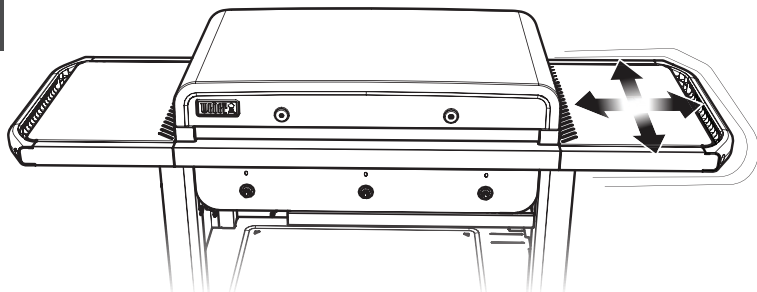

⚠ Pas de tafel aan.

⚠ Draai alle schroeven goed vast.

⚠ Réglez la tablette.

⚠ Serrez toutes les vis à fond.

⚠ Den Tisch einstellen.

⚠ Alle Schrauben vollständig festziehen.

⚠ Regolare il ripiano.

⚠ Serrare completamente tutte le viti.

21

⚠ Draai alle schroeven goed vast.

⚠ Alle Schrauben vollständig festziehen.

⚠ Serrez toutes les vis à fond.

⚠ Serrare completamente tutte le viti.

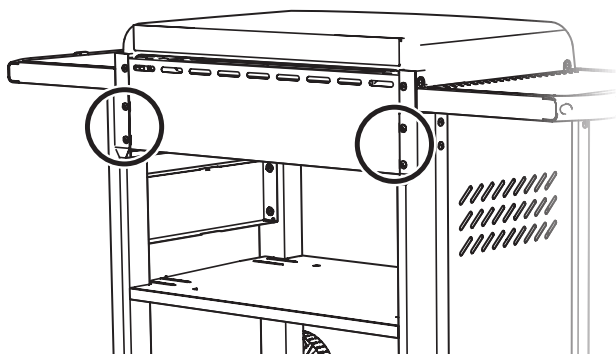

22



-2



-2

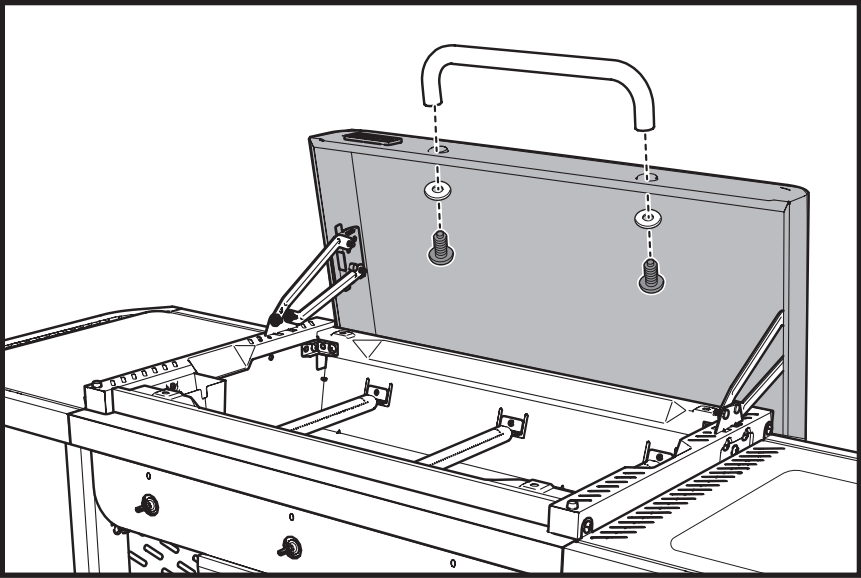

23

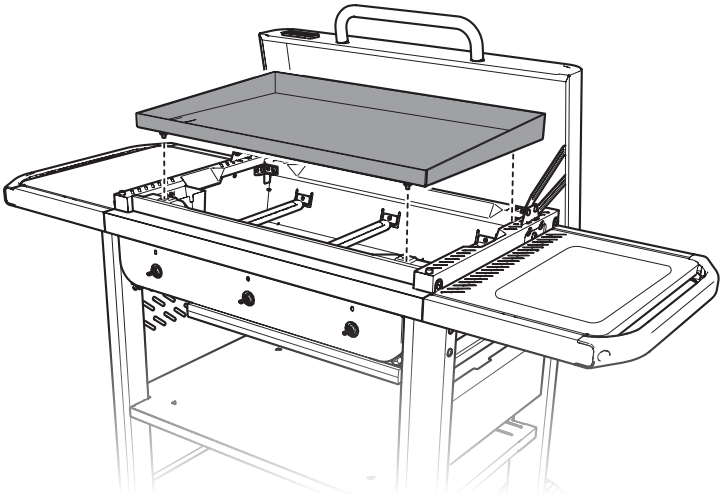

24

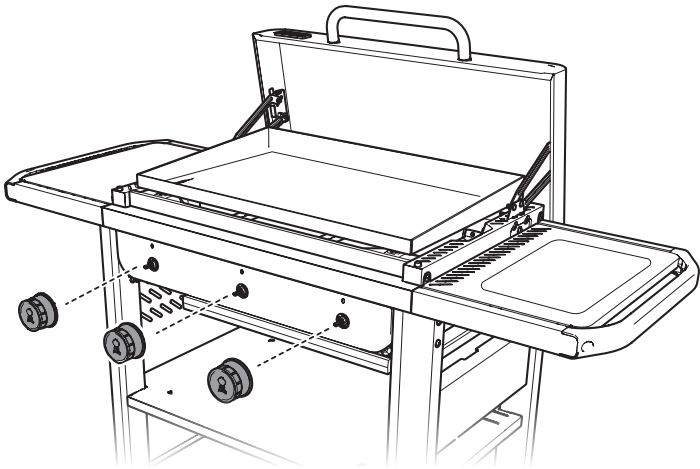

25

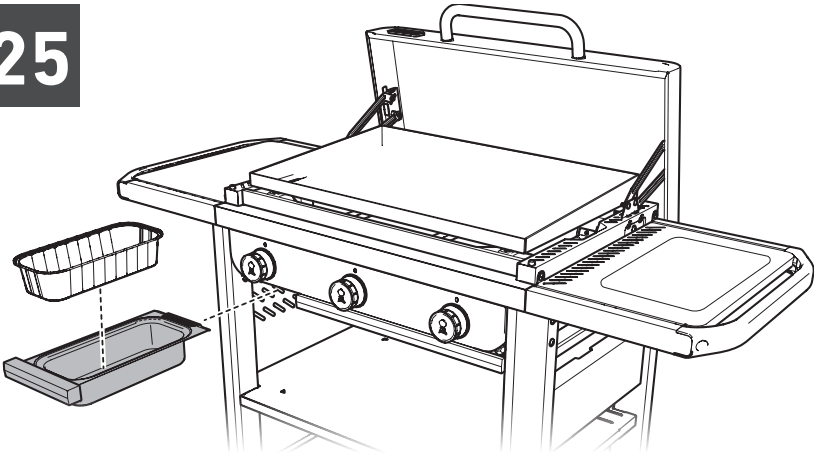

26

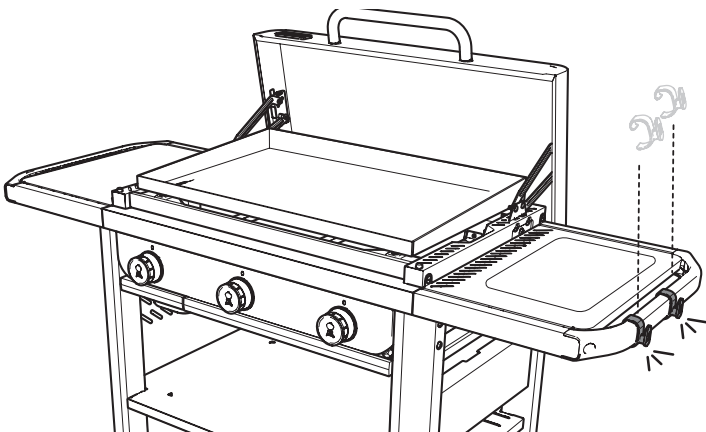

Verwijder de bakplaat (en de gasfles indien van toepassing) zodat de barbecue lichter is wanneer je hem optilt.

Volg de instructies voor de gasaansluiting in de gebruikershandleiding.

Nimm die Plancha (und ggf. die Flüssigpropangas-Flasche) heraus, um das Gewicht beim Anheben des Grills zu reduzieren.

Befolge die Anweisungen zum Gasanschluss in deinem Benutzerhandbuch.

Retirez la plancha (et la bouteille de propane liquide le cas échéant) pour réduire le poids lorsque vous soulevez votre appareil.

Suivez les instructions de raccordement du gaz indiquées dans votre notice d'utilisation.

Prima di sollevare il barbecue, rimuovere la piastra (e la bombola GPL, se presente) per ridurre il peso. Seguire le istruzioni per il collegamento del gas riportate nel Manuale utente.

a.

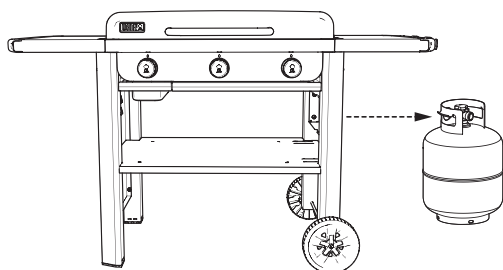

b.

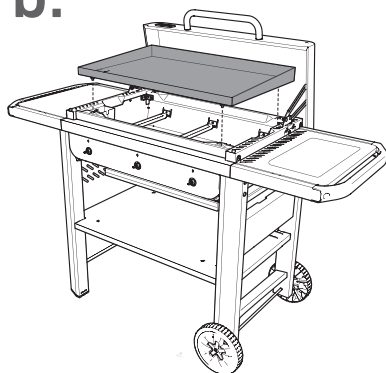

c.

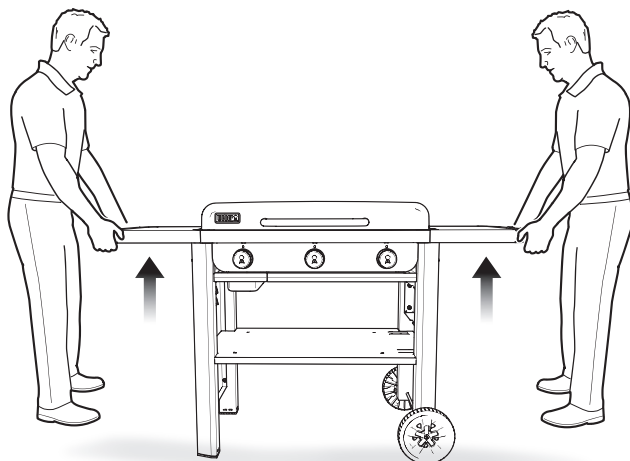

- ⚠ Zorg ervoor dat alle onderdelen zijn gemonteerd en de schroeven volledig zijn aangedraaid voordat je de barbecue in gebruik neemt.
- ⚠ Stelle sicher, dass alle Teile ordnungsgemäß zusammengebaut und sicher befestigt sind, bevor du den Grill in Betrieb nimmst.
- ⚠ Assurez-vous que toutes les pièces sont assemblées et que toutes les fixations sont serrées avant de faire fonctionner votre barbecue.
- ⚠ Prima di utilizzare il barbecue, assicurarsi che tutte le parti siano montate e che la minuteria sia serrata.

REGISTREREN.

Registreer je barbecue en ontvang exclusieve WEBER-content waarmee je de ultieme held van je achtertuin wordt.

HEUTE REGISTRIEREN.

Registriere deinen Grill, um exklusive WEBER Inhalte zu erhalten, mit denen du zum ultimativen Grillhelden wirst.

INSCRIVEZ-VOUS DÈS AUJOURD'HUI.

Enregistrez votre barbecue pour recevoir des informations exclusives de WEBER qui feront de vous le ou la spécialiste des grillades.

REGISTRATI OGGI.

Registra il tuo barbecue per ricevere contenuti WEBER esclusivi che ti faranno diventare un vero re della griglia.