



MiVue™ 618/698 Dual

User Manual

Table of Contents

Getting to know your recorder	2
Power button	3
Event button	3
Function keys	4
System icons	5
LED indicators	5
Using your recorder in a vehicle	6
Inserting a memory card	10
Formatting a card	10
Operating basics	11
Turning the recorder on	11
Setting the date and time	11
Recording in driving mode	12
Recording in Parking mode	13
Camera mode	14
Playback mode	14
Safety camera alerts	16
System settings	17
MiVue Manager	20
Installing MiVue Manager	20
Playing the recording files	20
For more information	23
Support	23
Caring for your device	23
Precautions and notices	24
Safety precautions	24
About GPS	25
WEEE	26

Getting to know your recorder

Note: The screenshots and other presentations shown in this manual may differ from the ones generated by the actual product.

MiVue 618 / 698 Dual

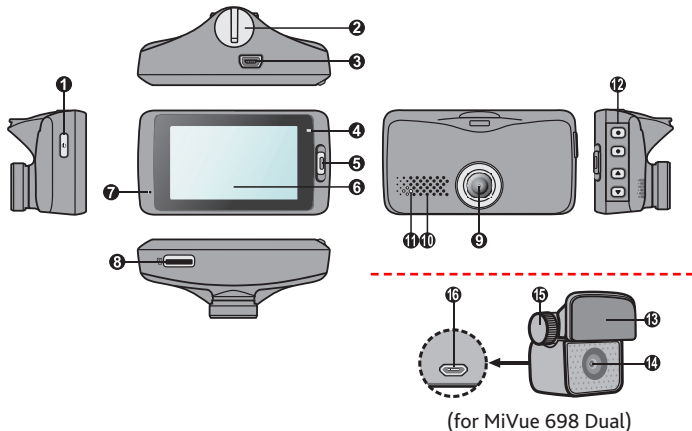

- | | | |
|-----------------------|----------------------|------------------------|
| 1 Power button | 7 Microphone | 13 Mounting pad |
| 2 Device mount socket | 8 Memory card slot | 14 Camera lens |
| 3 Mini-USB connector | 9 Camera lens | 15 Fixing bolt |
| 4 System indicator | 10 Speaker | 16 Micro-USB connector |
| 5 Event button | 11 Parking indicator | |
| 6 LCD screen | 12 Function keys | |

Power button

- Press and hold for 2 seconds to manually turn the recorder on and off.
- When the recorder is turned on, press to switch the LCD screen on and off.

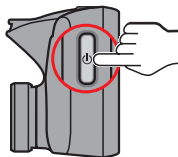

Note: If the system does not turn off by keeping the Power button pressed, you can force it to shut down by inserting a small rod (such as a straightened paperclip) into the Shutdown button on the top of the device.

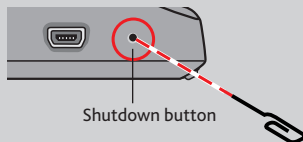

Event button

Press to manually start an event recording.



Function keys

The device provides 4 function keys to control the corresponding icons displayed on the LCD screen. The keys' functions may vary on different screens.



Recording screen

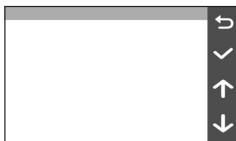
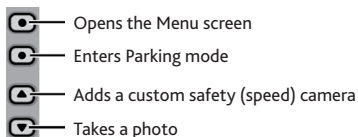

Menu screen

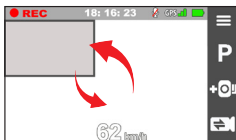
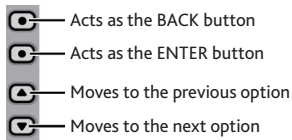

Switching screens*

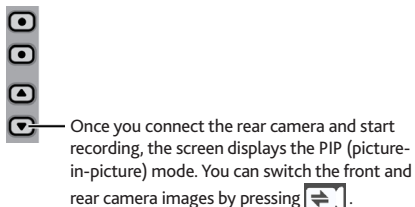

* For MiVue 698 Dual only.

System icons

Various System icons on the title bar at the top of the screen provide the status information of your device. The icons displayed will vary depending on your device model and state.

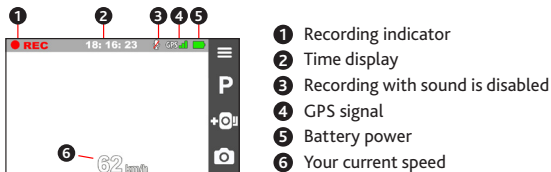

LED indicators

- **System indicator**

Glow in **green** when the recorder is charging. During charging, the LED flashes in **green** and **amber** alternately while the recording is in progress.

- **Parking indicator**

Flashes in **red** when Parking recording is in progress.

Using your recorder in a vehicle

Note:

- To ensure the highest quality recordings, you are advised to place the recorder near the rear view mirror.
- Select an appropriate location for mounting the device in a vehicle. Never place the device where the driver's field of vision is blocked.
- If the car's windshield is tinted with a reflective coating, it may be athermic and impact the GPS reception. In this instance, please mount your device where there is a "clear area."
- The system will automatically calibrate the G sensor of the device during start-up. To avoid G sensor malfunction, always turn the device on AFTER you mount it in the vehicle properly.

Make sure that your car is parked on level ground. Follow the instructions to securely mount your recorder and rear camera into a vehicle.

1. Mount the recorder.

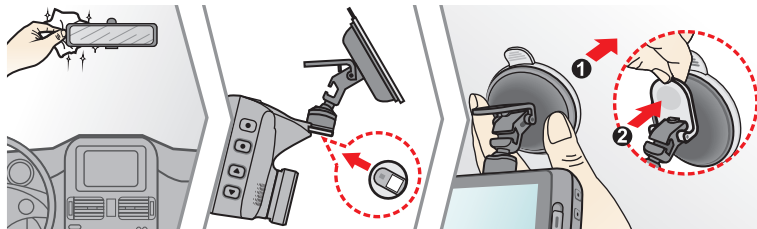

2. Mount the rear camera (for MiVue 698 Dual only).

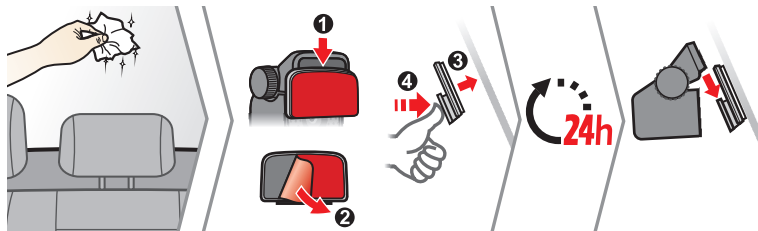

Note:

- Before sticking the mounting pad, you are recommended to clean the windscreen with rubbing alcohol.
- If the adhesion of the adhesive tape does not perform well, replace the tape with a new one.

3. Adjust the lens angle.

When adjusting the angle of mounting, make sure that the camera's view is parallel with the level ground and the ground/sky ratio is close to 6/4.

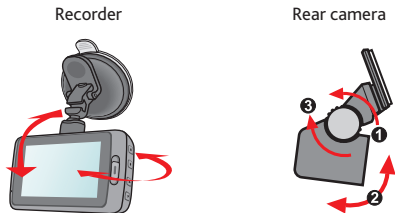

4. Connect the cables.

a. MiVue 618

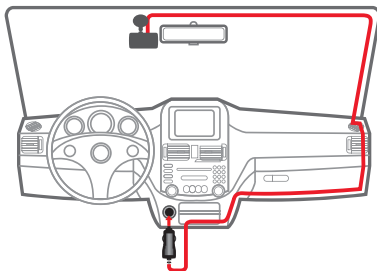

b. MiVue 698 Dual

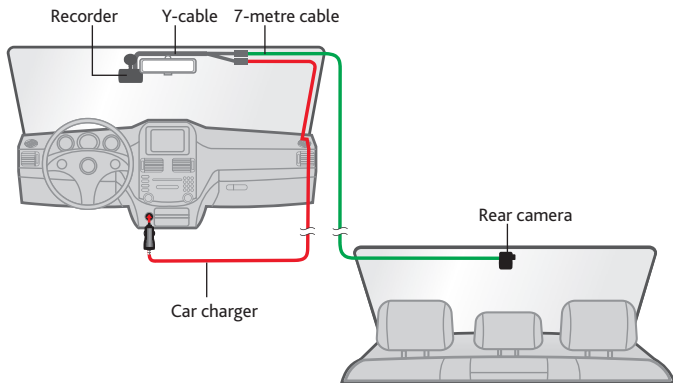

Note:

- Route the cables through the top ceiling and the A-pillar so that it does not interfere with driving. Make sure that the cable installation does not interfere with the vehicle's airbags or other safety features.
- The installation illustrations are for your reference only. The placement of the devices and cables may vary depending on the vehicle model. If you encounter any problems during installation, contact a skilled installer (such as the service personnel of the vehicle) for assistance.

Inserting a memory card

You must insert a memory card (not supplied) before you can start recording. The recorder supports Class 10 memory cards with 8 GB - 128 GB capacity (16 GB - 128 GB for MiVue 698 Dual).

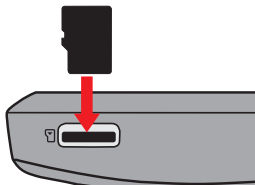

- Hold the card (MicroSD) by the edges and gently insert it into the slot as shown in the illustration.
- To remove a card, gently push the top edge of the card inwards to release it and pull it out of the slot.

Note:

- DO NOT apply pressure to the centre of the memory card.
- MiTAC does not guarantee the product's compatibility with memory cards from all manufacturers.
- Before you start recording, please format the memory card to avoid malfunction caused by files not created by the recorder.
- You are recommended to turn the device off before removing the memory card.

Formatting a card

If you need to format a memory card (all data will be erased), press  and select **Format**.







Operating basics

Turning the recorder on

Complete the installation according to the instructions in the “Using your recorder in a vehicle” section. Once the vehicle engine is started, the recorder automatically turns on.

Setting the date and time



To make sure that the date and time of your recordings are correct, check the settings before you begin recording.

1. Press  to access the Settings Menu.
2. Select **System > Date / Time** and press .
3. Select **Use GPS time** or **Manual**:
 - The default time zone for the system is **GMT +00:00**. When you select **Use GPS time**, you need to change the time zone setting and then select the Daylight Savings Time setting (**Off / +1 hour / +30 min / -1 hour / -30 min**) according to your location. When done, the system will set date and time automatically.
 - When you select **Manual**, the system will display the date and time setting screen. Use  /  to adjust the value of the selected field; press  and repeat the step until all fields have been changed. When completed, press .

Recording in driving mode

Continuous recording

By default, the system will automatically begin with continuous recording in a few seconds after start up. The recording may be divided into several video clips; recording will not stop between video clips.

- When continuous recording is in progress you can manually stop recording by pressing .
- Press  to return to the recording screen; the system will start continuous recording automatically.
- The continuous recordings can be found in the "Video" category for file playback.

Note: (For MiVue 698 Dual) The video files recorded by the front and rear cameras will be saved separately in the corresponding folders of the memory card.

Event recording



By default if an event happens such as a sudden impact, high speed driving, an aggressive turn or an accidental crash the G sensor* will prompt the recorder to start recording the event.

* You can change the sensitivity level (6 levels, from Low to High) of the G sensor by selecting  > Video Recording > G-Sensor Sensitivity.

- If you want to manually start an event recording while continuous recording is in progress, press the Event button on the device.
- The event recordings can be found in the "Event" category for file playback.

Recording in Parking mode

Your recorder supports the parking recording function. Depending upon how long the car is parked you may need an additional power source (e.g. an uninterruptible power cable like Mio Smart Box which is sold separately) to record the video during Parking mode.



- The Parking mode function is disabled by default. You have to enable the function by selecting  > **Parking Mode** > **Detection** > **On**.
- Before enabling Park mode, please check your device memory storage allocation. Go to  > **System** > **Storage Allocation** to set a proper allocation for parking recording. Changing the allocation will erase the memory card so save any videos or photos to your computer first.
- When the Parking mode detection is enabled the system will enter Parking mode when you:

- disconnect the device's power (e.g. the vehicle engine is stopped or the power cable is disconnected) or when the car stops moving for about 5 minutes*; or
- press  to manually start Parking mode while continuous recording is in progress.

* The feature is triggered by the G sensor of the device. You can change the configuration by selecting  > **Parking Mode** > **Auto Entry**.











- To stop Parking mode and resume continuous recording, press .
- If movements were detected and recorded during Parking mode, you will be asked to playback the video when you stop Parking mode.
- The parking recordings can be found in the "Parking" category for file playback.

Camera mode

- The recorder allows you to take a photo.
 - If the recording is in progress, press  to take a photo*.
 - Press  > **Camera** > .
- * This function is not available when the rear camera is connected (for MiVue 698 Dual).
- The photos can be found in the “Photo” category for file playback.

Playback mode

To select a video or photo for playback:

1. Press  > **File Playback**.
2. Select the desired type: **Video**, **Event**, **Parking** and **Photo**.
3. Press  /  to select the desired file from the list and then press  to start playback.
4. During playback, you can:
 - While playing videos, press  /  to play the previous/next video.
 - While viewing photos, press  /  to display the previous/next photo.
 - Press  to return to the list.
 - Press  to display the pop-up menu to select:
 - **Play/Pause**: Starts or pauses the playback.
 - **Play rear video**: The "D" icon displayed on the thumbnail on the playlist means that the video comes with a corresponding rear video. While playing the front video, you can use this option to switch to the rear video (for MiVue 698 Dual).
 - **Move to Event**: Moves the file to the “Event” category.

-
- **Delete:** Deletes the file.





Note: When you are moving or deleting the front video, the corresponding rear video will be processed synchronously (for MiVue 698 Dual).

Safety camera alerts

Caution: For legal reasons the safety camera function is not available in all countries.

Your recorder allows you to customize the safety camera database. You can add up to 100 custom safety cameras in your recorder.

Follow the steps to configure a custom safety camera:

1. To add a custom safety camera in the current location, press   on the recording screen. (You can add a custom safety camera only when a GPS fix is established.)
2. The next time when you pass by the location you will receive alerts by the recorder.
3. To view the information of the user-added safety camera, select  > **SafetyCam** > **Custom SafetyCam** and then select the safety camera that you want to check.
4. Press  to remove the custom safety camera from the recorder.

System settings

To customize the system settings press .

Note: Depending on your MiVue model, certain setting options may not be available.

- **File Playback**

Plays the recorded videos and photos.

- **Camera**

Press to enter Camera mode.

- **Sound Recording**

Sets if you want to include sounds in the recordings. The default setting is **On**.

- **Driving Safety**

The recorder provides advanced driving safety functions to make your driving safer.

- **Calibration:** After the Lane Departure Warning System (LDWS) function is enabled, follow the steps to calibrate the system:

1. Drive the vehicle in the middle of the lane.
2. Ask a passenger to select the option and then follow the on-screen instructions to complete calibration.

You are advised to calibrate the system constantly in order to be alerted properly.

- **LDWS:** The default setting is **Off**. You can enable this function by selecting **Beep** or **Voice**. Once enabled, the system will alert you when it detects that the car speed is over 60 km/h and the car has strayed from its intended lane.
 - **Headlight Reminder:** The default setting is **Off**. Once enabled, the system will remind you to turn the lights on when you are driving after dark.
 - **Driver Fatigue Alert:** The default setting is **Off**. Once enabled, the system will remind you to take a break after long-distance driving (**2 hours, 3 hours** or **4 hours**).
-

- **Eco Drive Indicator:** The default setting is **Off**. Once enabled, the system will display the Eco drive indicator on the screen. The color of the indicator will change (red, yellow or green) depending on your driving status to remind you to drive more efficiently.

▪ **SafetyCam**

- **Alert Sound:** The options are **Beep**, **Voice** and **Mute**.

- **Alert Distance:** The options are **Short**, **Medium** and **Long**.

- **Alert Method:** The options are **Smart Alert** and **Standard Alert**.

- **Cruise Speed Alert:** Sets the limit for cruise speed. When you drive at a cruise speed over the set value you will receive alerts by the recorder.

- **Custom SafetyCam:** Lists all user-added safety cameras which are sorted by created time.

▪ **Parking Mode**

Allows you to change the settings of Parking mode. The available settings include:

- **Detection:** When enabled, the recorder will automatically start recording when it detects movements or if an event happens in Parking mode.

- **Detection Method:** The options are **Only G-sensor**, **Only Motion** and **Both Motion & G-sensor**.

- **Auto Entry:** Sets the mode (**Low**, **Medium**, **High** or **Manual**) for the system to enter Parking mode automatically.

- **Motion Detection:** The options are **Low**, **Medium** and **High**.

- **G-Sensor Sensitivity:** Sets the sensitivity level (**Low**, **Medium** or **High**) of the G sensor that allows automatic triggering of the parking recording when the recorder is in Parking mode.

- **LED Indicator:** The options are **On** and **Off**.

▪ **Video Recording**

Changes the settings of recording, including:

- **Video Clip Length:** Sets the length of each video clip for a continuous recording (**1 min**, **3 min** or **5 min**).

- **EV:** Sets the proper exposure level (-1 ~ +1) to adjust the brightness of the image. The default setting is 0.
- **G-Sensor Sensitivity:** Sets the sensitivity level (6 levels, from **Low** to **High**) of the G sensor that allows automatic triggering of the event recording while continuous recording is in progress.
- **Stamps:** Sets the information (**Coordinates** or **G-Sensor**) that will be displayed on the recorded video.

▪ **System**

Allows you to change the system settings of the device.

- **Satellites:** Displays the status of GPS/GLONASS signal reception. You can press  and then select **GPS*** or **GLONASS** for better signal reception if the need arises.
* GPS is recommended for use in North America regions.
- **Date/Time:** Sets the system date and time. For more information, see the "Setting the date and time" section.
- **System Sound:** Enables or disables system notification sounds.
- **Volume:** Adjusts the volume level.
- **LCD Standby:** Selects **Always On** to keep the LCD on; or sets the timer for the LCD to turn off automatically (**10 sec**, **1 min** or **3 min**) after recording starts. Selecting **Standby** will turn off the LCD (in specified time) but still display the time and speed information.
- **Language:** Sets the language.
- **Distance Unit:** Sets the preferred distance unit.
- **Storage Allocation:** The system provides 3 default memory configurations to store the videos and photos. Select the proper configuration based on your usage.
- **Restore to Defaults:** Restores system settings to factory defaults.
- **Version:** Displays the software information.

▪ **Format**

Formats a memory card. (All data will be erased.)

MiVue Manager

MiVue Manager™ is a tool for you to view the videos recorded on a recorder.

Note: Not all features are available for every model.

Installing MiVue Manager

Download MiVue Manager from the Support page of our website (www.mio.com/support) and follow the on-screen prompts to install it. Make sure to download the correct software version (Windows or Mac) according to your computer's operating system.

Playing the recording files

1. Remove the memory card from the recorder and access the card on the computer via a card reader. You are advised to copy the recording files to your computer for backup and playback.
2. Start MiVue Manager on the computer.
 - By default, MiVue Manager shows the calendar and the file list on the right.
 - When a recording file exists, you will see the date marked with "●." Click that date to display the files that were recorded on that date.
 - You can choose the file type to display: **Event / Normal / Parking**.
 - To display all files in the current folder, click **All**. To return to the calendar view, click **Calendar**.
3. Double-click the desired file on the file list to start playback.
4. The playback controls are described as follows:

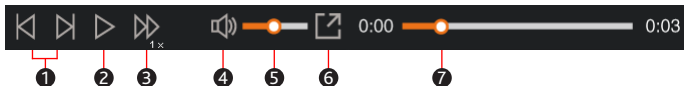

- 1 Skips to the previous / next file on the list.
- 2 Starts or pauses the playback.
- 3 Changes the playback speed to 1/4x, 1/2x, 1x (default), 1.5x, or 2x.
- 4 Mutes or unmutes the volume.
- 5 Adjusts the volume level.
- 6 Plays the video in full screen.
- 7 Displays the playback progress. You can click on a point along the track bar to move directly to a different location for the playback.

5. During playback, you can check more driving information from the dashboard panel and the G sensor chart that are displayed below the video playback screen.

- On the dashboard panel, click  to display the map screen*.
- G sensor chart displays data in 3-axis waveform about the car's shift forward/backward (X), to the right/left (Y) and upward/downward (Z).

* The map screen may not display when the computer is not connected to the Internet or when your MiVue model does not support the GPS function.

6. The tool bar allows you to do the following:



- 1 Selects the folder that stores the recording files.
- 2 Previews and prints the current video image.
- 3 Saves the selected files to the specified location on your computer.
- 4 Captures and saves the current video image to the specified location on your computer.

-
- ⑤ Opens the Settings Menu. The Settings items are described as follows:
 - **Change Language:** Sets the display language of MiVue Manager.
 - **Change Skin:** Sets the color scheme of MiVue Manager.
 - **Check for Update:** Checks if there is any new version of MiVue Manager. Internet access is required for this feature.
 - **About:** Displays the version and copyright information of MiVue Manager.
 - ⑥ Exports the GPS information of the selected file in the KML format to the specified location on your computer.
 - ⑦ Uploads the selected file to Facebook / YouTube™.

For more information

For regulatory identification purposes, Mio™ MiVue™ 618/698 Dual is assigned a model number of N489.

Support

Occasionally, MiTAC may offer free system updates to improve user experience. Please regularly check the Mio website (www.mio.com) to download the latest software and follow the on-screen prompts to install it.

Caring for your device

Taking good care of your device will ensure trouble-free operation and reduce the risk of damage.

- Keep your device away from excessive moisture and extreme temperatures.
- Avoid exposing your device to direct sunlight or strong ultraviolet light for extended periods of time.
- Do not place anything on top of your device or drop objects on your device.
- Do not drop your device or subject it to severe shock.
- Do not subject your device to sudden and severe temperature changes. This could cause moisture condensation inside the unit, which could damage your device. In the event of moisture condensation, allow the device to dry out completely before use.
- The screen surface can easily be scratched. Avoid touching it with sharp objects. Non-adhesive generic screen protectors designed specifically for use on portable devices with LCD panels may be used to help protect the screen from minor scratches.
- Never clean your device with it powered on. Use a soft, lint-free cloth to wipe the screen and the exterior of your device.
- Do not use paper towels to clean the screen.
- Never attempt to disassemble, repair or make any modifications to your device. Disassembling, modifying or any attempt to repair could cause damage to your device,

may inflict bodily harm or damage to property and will void any warranty.

- Do not store or carry flammable liquids, gases or explosive materials in the same compartment as your device, its parts or accessories.
- To discourage theft, do not leave the device and accessories in plain view in an unattended vehicle.
- Overheating may damage the device.

Precautions and notices

- For your own safety, do not operate the controls of the product while driving.
- A window mount is needed when using the recorder in a car. Make sure that you place the recorder in an appropriate place, so as not to obstruct the driver's view or deployment of airbags.
- Make sure that no object is blocking the camera lens and no reflective material is placed near the lens. Please keep the lens clean.
- If the car's windscreen is tinted with a coating, it may impact the recording quality.

Safety precautions

About charging

- Use only the charger supplied with your device. Use of another type of charger may result in malfunction and/or danger.
- This product is intended to be supplied by a LISTED Power Unit marked with "LPS", "Limited Power Source" and output rated + 5 V dc / 1.0 A.

About the charger

- Do not use the charger in a high moisture environment. Never touch the charger when your hands or feet are wet.
- Allow adequate ventilation around the charger when using it to operate the device or charge the battery. Do not cover the charger with paper or other objects that will reduce cooling. Do not use the charger while it is inside a carrying case.

-
- Connect the charger to a proper power source. The voltage requirements are found on the product case and/or packaging.
 - Do not use the charger if the cord becomes damaged.
 - Do not attempt to service the unit. There are no serviceable parts inside. Replace the unit if it is damaged or exposed to excess moisture.

About the battery

CAUTION! This unit contains a non-replaceable internal Lithium Ion battery. The battery can burst or explode, releasing hazardous chemicals. To reduce the risk of fire or burns do not disassemble, crush, puncture or dispose of in fire or water.

- Use a specified battery in the equipment.
- Important instructions (for service personnel only)
 - Caution! Risk of explosion if battery is replaced by an incorrect type. Dispose of used batteries according to the instructions.
 - Replace only with the same or equivalent type recommended by the manufacturer.
 - The battery must be recycled or disposed of properly.
 - Use the battery only in the specified equipment.

About GPS

- GPS is operated by the United States government, which is solely responsible for the performance of GPS. Any change to the GPS system can affect the accuracy of all GPS equipment.
- GPS satellite signals cannot pass through solid materials (except glass). When you are inside a tunnel or building, GPS positioning is not available. Signal reception can be affected by situations such as bad weather or dense overhead obstacles (e.g. trees, tunnels, viaducts and tall buildings).
- The GPS positioning data is for reference only.

WEEE



This product must not be disposed of as normal household waste, in accordance with the EU directive for waste electrical and electronic equipment (WEEE – 2012/19/EU). Instead, it should be disposed of by returning it to the point of sale, or to a municipal recycling collection point.

Revision: R00
(8/2016)

Disclaimer

Specifications and documents are subject to change without notice. MiTAC does not warrant this document is error-free. MiTAC assumes no liability for damage incurred directly or indirectly from errors, omissions or discrepancies between the device and the documents.

Notes

Not all models are available in all regions.

Depending upon the specific model purchased, the color and look of your device and accessories may not exactly match the graphics shown in this document.

Do not operate the device while driving. Using this product does not change the requirement for a driver to take full responsibility for his or her behavior. This responsibility includes observing all traffic rules and regulations in order to avoid accidents, personal injury or property damage.

MiTAC International Corp.
www.mio.com