



BOSCH



Register your
new device on
MyBosch now and
get free benefits:
[bosch-home.com/
welcome](https://bosch-home.com/welcome)

Washing machine

WGB266A7NL

[en] User Manual and Installation Instructions



You can find additional information and explanations online. Scan the QR code on the title page.



Table of contents

1 Safety	3	10 Accessories	2 8
1.1 General instructions	3	11 Laundry	2 9
1.2 Intended use of the device		11.1 Preparing laundry	29
honeycomb	4	11.2 Care instructions on care	
1.3 Restriction of users	4	labels	29
1.4 Safe installation	4	12 Detergent and fabric care	
1.5 Safer use	6	ing agent	2 9
1.6 Safe cleaning and maintenance		13 The Ministry in essence	3 0
d	8	13.1 Switching on the device	30
2 Avoid material damage	9	13.2 Set program	30
3 Environmental protection and saving		13.3 Saving program	
ring	1 0	settings	30
3.1 Disposal of packaging ...	10	13.4 Opening the door	31
3.2 Economical with energy and		13.5 Filling the drum with	
resources	10	laundry	31
3.3 Energy Saving Mode	11	13.6 Starting the program-	
4 Setting up and connecting	1 1	ma	31
4.1 Unpacking the device	11	13.7 Soaking laundry	31
4.2 Contents of the package	11	13.8 Loading laundry	31
4.3 Requirements regarding the installation		13.9 Program cancel	32
site	11	13.10 Resume program after rinse	
4.4 Removing transport		hold	32
protection	12	13.11 Removing laundry	32
4.5 Connecting the device	13	13.12 Putting the device to sleep	
4.6 Adjusting the appliance	14	(standby) mode	32
5 Before first use	1 5	14 Child Lock	3 2
5.1 Starting a wash cycle without		14.1 Enabling child lock	32
laundry	15	14.2 Deactivating child lock	32
6 Getting to know your device	1 7	15 Intelligent dosing system	3 2
6.1 Device	17	15.1 Filling the dispenser with liquid	
6.2 Detergent drawer	17	detergent and fabric	
6.3 Control panel	18	softener	33
6.4 Operating logic	18	15.2 Using the manual dosing	
7 Display	1 9	container	33
8 Keys	2 1	15.3 Dosing container  conversion	
9 Programs	2 4	len	34

15.4 Setting the basic dosing quantity	34	18.5 Cleaning rubber sleeve	43
16 Home Connect	3 4	19 Troubleshooting	4 3
16.1 Set up Home Connect	35	19.1 Emergency release	50
16.2 Disabling Wi-Fi on the device	35	19.2 Electronic card reset-ten	50
16.3 Activating Wi-Fi on the device	35	20 Transport, storage and disposal to feed	5 0
16.4 Install Software Update ...	35	20.1 Disassembling the appliance	50
16.5 Resetting the device's network settings	35	20.2 Installing transport protection	50
16.6 Remote Start	36	20.3 Reusing the appliance	51
16.7 Remote diagnosis	36	20.4 Disposal of your old appliance	51
16.8 Protection of personal data	36	21 Service Department	5 1
17 Basic Settings	3 6	21.1 Product number (E-No.), production number (FD) and serial number (Z-No.)	51
17.1 Overview of basic settings	37	21.2 AQUA-STOP guarantee	52
17.2 Changing basic settings	37	22 Consumption values	5 2
18 Cleaning and maintenance	3 7	23 Technical data	5 3
18.1 Maintaining the device	37	23.1 Information about Free Software and Open Source Software	54
18.2 Cleaning the drum	38	24 Declaration of Conformity	5 5
18.3 Cleaning the detergent drawer	38		
18.4 Cleaning the drain pump	40		



1 Safety

Please observe the following safety precautions.

1.1 General instructions



youRead these instructions carefully.

youKeep the instructions for use and product information for future reference.
for use or for subsequent owners.

youDo not connect the appliance if it has been damaged in transit.

1.2 Intended use of the device

Use the appliance only:

- to prepare machine washable textiles and wool for hand washing wash according to the care label.
- with tap water and standard washing-machine-safe detergent detergents and maintenance products.
- for domestic use and in closed spaces within the house-social environment.
- up to an altitude of 4000 m above sea level.

1.3 Restriction of users

This appliance may be used by children aged 8 years and older and by persons with limited physical, sensory, or mental capabilities, or by persons with limited experience and/or knowledge, provided they are supervised or have been instructed in the safe use of the appliance and understand the potential hazards. Children must not play with the appliance.

Cleaning and user maintenance shall not be made by children without supervision.

Keep children under 3 years of age and pets out of reach of the appliance.

1.4 Safe installation

⚠ WARNING – Risk of electric shock! Unskilled installations are dangerous.

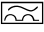
- ▶ Connect and use the appliance only in accordance with the information on the rating plate.
- ▶ Connect the appliance only to an alternating current power supply via a properly installed earthed socket.
- ▶ The earthing system of the electrical installation must be installed in accordance with electrical regulations. The system must have a sufficiently large conductor cross-section.
- ▶ When using a residual current device, only use a type with the symbol . 

- ▶ Never power the appliance via an external switching device, such as a timer or remote control.
- ▶ When the appliance is installed, the mains plug of the mains connection cable must be freely accessible or, if free access is not possible, an isolating device in accordance with the installation regulations must be installed in the permanent electrical installation.
- ▶ When setting up the appliance, ensure that the power cord is not pinched or damaged.

Damaged insulation on the power cord is dangerous.

- ▶ Never bring the power cord into contact with hot appliance parts or heat sources.
- ▶ Never allow the power cord to come into contact with sharp points or edges.
- ▶ Never kink, pinch or modify the power cord.

⚠ WARNING – Fire Hazard!

Using an extended power cord and unauthorized adapters is dangerous.

- ▶ Do not use extension cords or multiple sockets. Use only manufacturer-approved adapters and power cords.
- ▶ If the power cord is too short and a longer cord is not available, contact an electrical store to adjust the home installation.

⚠ WARNING – Risk of injury!

The heavy weight of the device may cause injuries when lifting.

- ▶ Do not lift the appliance alone.

If this appliance is installed in a washer-dryer column without proper care, the installed appliance may fall down.

- ▶ The dryer may only be stacked on a washing machine using the connection set provided by the dryer manufacturer. Any other installation method is not permitted.
- ▶ Do not install the appliance in a washer-dryer column if the dryer manufacturer does not supply a suitable connection set.

Safety

- ▶ Do not place appliances from different manufacturers and with different depths and widths in a washer-dryer column.
- ▶ Do not place a washer-dryer column on a platform, as the appliances may tip over.

⚠ WARNING – Risk of suffocation!

Children may pull packaging material over their heads and become entangled in it and suffocate.

- ▶ Keep packaging materials away from children. Do not
- ▶ allow children to play with packaging materials.

⚠ CAUTION – Risk of injury!

The appliance may vibrate or move during operation.

- ▶ Place the appliance on a clean, flat and sturdy surface.

- ▶ Level the appliance using the appliance feet and a spirit level.

Incorrectly laid hoses and power supply cables pose a tripping hazard.

- ▶ Lay the hoses and connection cables in such a way that they cannot be tripped over.

If the appliance is moved by protruding parts, such as the loading door, the parts may break off.

- ▶ Do not move the appliance by its protruding parts.

⚠ CAUTION – Risk of cuts!

Sharp edges on the device may cause cuts if touched.

- ▶ Do not touch the appliance by sharp edges. Wear safety gloves
- ▶ when installing and transporting the appliance.

1.5 Safer use

⚠ WARNING – Risk of electric shock!

A damaged appliance or a damaged power cord is dangerous

corpse.

- ▶ Never use a damaged appliance.

- ▶ Never pull the power cord to disconnect the appliance from the mains. Always pull the plug on the power cord.
- ▶ If the appliance or the power cord is damaged, immediately unplug the power cord from the socket or switch off the fuse in the fuse box and turn off the tap.
- ▶ Please contact customer service. *Page 51* Penetrating moisture may cause an electric shock.
- ▶ Only use the appliance in closed spaces.
- ▶ Never expose the appliance to excessive heat or humidity. Do not use a steam cleaner, pressure washer, hose, or sprayer to clean the appliance.

⚠ WARNING – Risk of health hazard! Children could lock themselves in the appliance and endanger their lives.

- ▶ Do not install the appliance behind a door that blocks or prevents the appliance door from opening.
- ▶ On discarded appliances, unplug the power cord, then cut through the power cord and damage the appliance door lock in such a way that the appliance door no longer closes.

When spinning larger, water-impermeable items of laundry, an imbalance may occur that could lead to injuries.

- ▶ Do not wash and spin larger, water-impermeable items of laundry such as blankets or mattress protectors in the appliance.

⚠ WARNING – Risk of suffocation!

Children may inhale or swallow small parts and suffocate.

- ▶ Keep small parts away from children. Do not allow children to play with small parts.

⚠ WARNING – Risk of poisoning!

If ingested, detergents and care products can cause poisoning to lead.

- ▶ If accidentally swallowed, seek medical advice.
- ▶ Keep detergents and care products out of reach of children.

⚠ WARNING – Danger of explosion!

If laundry has been pretreated with solvent-based, flammable cleaning agents, this may lead to an explosion in the appliance.

- ▶ Rinse pretreated laundry thoroughly with water before washing.

⚠ CAUTION – Risk of injury!

The cover plate may break when climbing or clambering on the appliance.

- ▶ Do not climb or clamber on the appliance.

Sitting or leaning on the open door may cause the appliance to tip over.

- ▶ Do not sit or lean on the appliance door. Do not place any objects on the appliance door.

Reaching into the rotating drum may cause injury to your hands.

- ▶ Wait until the drum has come to a complete stop before reaching into the drum with your hand.

⚠ CAUTION – Risk of burns!

The soap becomes hot when washing at high temperatures.

- ▶ Do not touch the hot soapy water.

⚠ CAUTION – Risk of chemical burns! When opening the detergent drawer, detergent and care products may splash out of the appliance.

Contact with eyes or skin may cause irritation.

- ▶ In case of contact with detergents or care products, rinse eyes or skin thoroughly with clean water.
- ▶ If accidentally swallowed, seek medical advice.
- ▶ Keep detergents and care products out of reach of children.

1.6 Safe cleaning and maintenance

⚠ WARNING – Risk of electric shock!

Unskilled repairs are dangerous.

- ▶ Never technically modify the device or its features.

- ▶ Only trained personnel may carry out repairs to the appliance.
- ▶ Only original spare parts may be used to repair the appliance.
- ▶ If the power cord of this appliance is damaged, it must be replaced by the manufacturer, its service agent, or a similarly qualified person to avoid a hazard. Penetration of moisture can cause an electric shock.
- ▶ Before cleaning, unplug the power plug or switch off the fuse in the meter cupboard.
- ▶ Do not use a steam cleaner, pressure washer, hoses or sprayers to clean the appliance.

⚠ WARNING – Risk of injury!

Using non-original spare parts and non-original accessories is dangerous.

- ▶ Use only original spare parts and original accessories from the manufacturer.

⚠ WARNING – Risk of poisoning!

When using solvent-based cleaning agents, toxic fumes may be generated.

- ▶ Do not use solvent-based cleaning agents.

2 Material damage avoid

NB

Incorrect dosage of fabric softeners, detergents, care products and cleaning agents can affect the functioning of the appliance.

- ▶ Follow the manufacturer's dosage recommendations. Exceeding the maximum load capacity will affect on the operation of the device.
- ▶ Observe and do not exceed the maximum load quantity for each programme.
→ *"Programs", Page 24*

The device is secured for transport with transport locks. Failure to remove transport locks can result in property damage and damage to the device itself.

- ▶ Before putting into operation, completely remove and store all transport protection devices.
- ▶ Before each transport, fully install all transport protection devices to avoid transport damage.

Incorrect connection of the water supply hose can lead to material damage.

- ▶ Hand-tighten the screw connections on the water supply. Connect the
- ▶ water supply hose directly without any additional connecting parts.

Environmental protection and saving

- ments, such as adapters, extensions or valves, to connect to the water tap.
- ▶ Install the valve housing of the water supply hose without contact with the environment and do not expose it to external forces.
 - ▶ Make sure that the internal diameter of the water tap is at least 17 mm.
 - ▶ Please ensure that the length of the thread on the connection to the water tap is at least 10 mm.

Too low or too high water pressure can hinder the appliance function.

- ▶ Ensure that the water pressure on the water supply system is at least 100 kPa (1 bar) and no more than 1000 kPa (10 bar).
- ▶ If the water pressure exceeds the specified maximum value, a pressure-reducing valve must be installed between the water connection and the hose set of the appliance.
- ▶ Do not connect the appliance to the mixing tap of a pressureless water heater or boiler.

Modified or damaged water hoses can lead to material damage and damage to the appliance.

- ▶ Never kink, pinch, modify, or cut water hoses. Use only the supplied water hoses.
- ▶ or use original spare hoses know.
- ▶ Never used water snakes re-to use.

Use with contaminated or too hot water may cause material damage and damage to the appliance.

- ▶ Exclude the device with cold tap water use n.

Unsuitable cleaning agents may damage the surfaces of the appliance.

- ▶ Do not use sharp or abrasive cleaning agents.
- ▶ Do not use strong alcoholic cleaning agents.
- ▶ Do not use harsh scouring pads or dishwashing sponges.
- ▶ Clean the appliance only with water and a soft, damp cloth.
- ▶ In case of contact with the appliance, immediately remove all detergent residue, spray mist residue or leftovers.

3 Environmental protection and savings

3.1 Disposal of packaging

The packaging materials are environmentally friendly and can be reused.

- ▶ Dispose of the individual components separately by type.

3.2 Economical with energy and resources

Following these instructions will help your appliance use less electricity and water.

- Use programs with low temperatures and longer wash times and use the maximum load capacity.
- Dose detergent according to the degree of soiling of the laundry.
- Reduce the washing temperature for lightly and normally soiled laundry.

- Set the maximum spin speed if the laundry is to be dried in the dryer afterwards.
- Wash laundry without pre-wash.

3.3 Energy saving mode

If you don't use the device for a short period, it automatically switches to energy-saving mode. All indicators disappear and the display flashes.

The energy saving mode will be exited when you operate the appliance again.

If you do not operate the device for a long time, it will automatically switch to standby.

4. Setting up and connecting

4.1 Unpacking the device

NB

Objects left in the drum that are not intended for use with the appliance can cause material damage and damage to the appliance.

- ▶ Before use, remove all these items and the supplied accessories from the drum.

1. Completely remove all packaging materials and protection from the device.

→ *"Disposal of packaging", Page 10*

2. Check the device for damage at sight.

3. Open the door. → *gina 31*

4. Remove the accessory it is out of the drum.

5. Close the door.

4.2 Contents of the package

After unpacking, check all parts for transport damage and the completeness of the delivery.

NB

Use with incomplete or defective accessories may impair the functioning of the device or cause material damage or damage to the device.

- ▶ Do not use the appliance with incomplete or defective accessories.
- ▶ Replace accessories before using the appliance.
→ *"Accessories", Page 28*

Remark: The appliance was factory-tested. This may cause water spots to appear inside the appliance, which will be removed during the first wash.

The delivery consists of:

- Washing machine
- Accompanying documents
- Transport security
→ *Page 12*
- Cover cap

4.3 Requirements regarding the installation site

WARNING

Risk of electric shock!

The device contains live parts.

Touching live parts is dangerous.

- ▶ Do not use the appliance without the cover plate.

†The number of cover caps varies depending on the model.

Set up and connect

⚠ WARNING

Risk of injury!

When used on a plinth, the appliance may tip over.

- ▶ The device feet for commissioning must be mounted on a plinth with the fasteners
→ Page 28 confirm from the manufacturer.

NB

Freezing residual water in the appliance can damage the appliance.

- ▶ Do not place or use the appliance in places prone to frost or outdoors.

If the appliance is tilted more than 40°, residual water may leak out of the appliance and cause material damage.

- ▶ Carefully tilt the appliance.
- ▶ Transport the appliance upright.

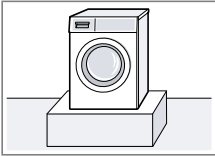
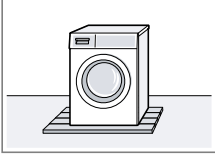
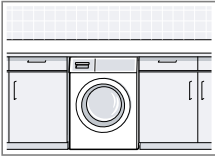
Depot	Requirements
<p>Holder</p> 	<p>The device with locking tabs → Page 28 to settle.</p>
<p>Floor with wooden beams</p> 	<p>Place the device comb on a water-resistant wooden plate (thickness minimum 30 mm) which is fixed to the floor screwed.</p>
<p>Kitchenette</p> 	<p>The device borrow under a door running w work-place sheet, that fixed with the next-light the closet is w bonds. Re-</p>

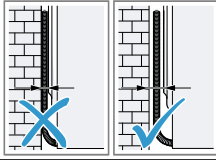
Depot	Requirements
	<p>dug niche width: 60 cm.</p>
<p>On a wall</p> 	<p>No mains connection cable and no snakes between wall and device to clamp.</p>

4.4 Removing transport protection

The appliance is secured for transport with transport locks at the rear of the appliance.

Remark: Save the transport lock bolts and sleeves for later transport.

1. Remove the hose and the power connection cable from the holders.

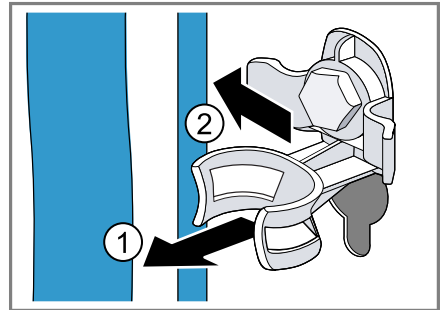

2. Tighten all bolts of the 4 transport locks with a wrench

Using a 13 key width, loosen and remove . ②

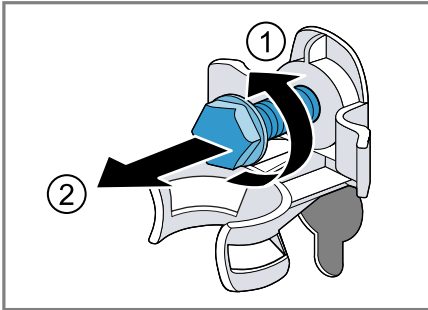

Use the third left opening for transport security.

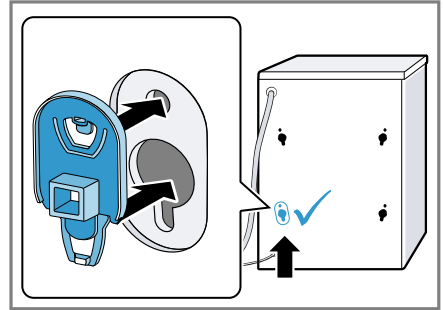

3.Remove the 4 sleeves.

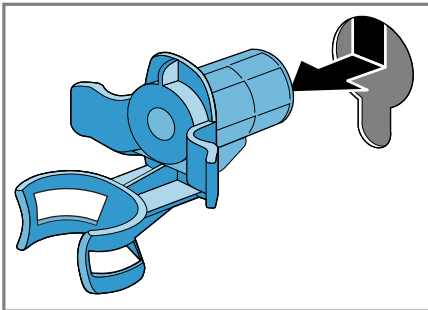

Remark:To install the transport locks in the appliance for transport, undo these steps in reverse order.

4.5 Connecting the device

Connect water supply hose

⚠ WARNING

Risk of electric shock!

The device contains live parts.

Touching live parts is dangerous.

4.Place the cover cap and slide it downwards.

Comments

- Please note the number of cover caps included in the scope of delivery
- If four cover caps are included in the scope of delivery, insert the cover caps into the four openings for the transport protection.

- ▶ Do not immerse the electric Aquastop valve in water.

NB

Incorrect connection of the water supply hose can lead to material damage.

- ▶ Hand-tighten the screw connections on the water supply.

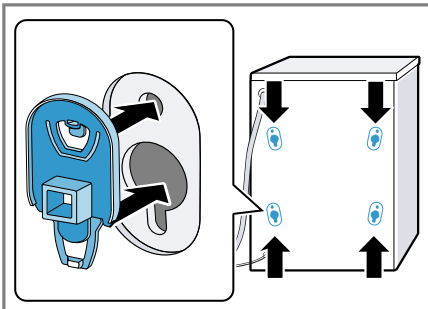

- With one cover cap the delivery in size, the cover monkey in the un-

Set up and connect

1. Connect the water supply hose to the tap (26.4 mm = 3/4").

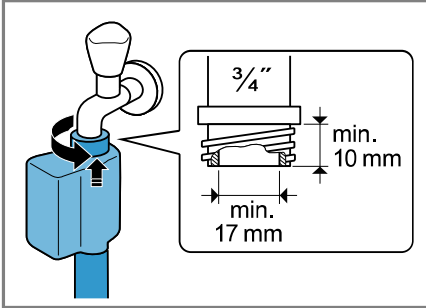

2. Carefully open the tap and check that the connections are tight.

Connection types for water drainage

The information will help you connect this appliance to the water drain.

NB

When pumping, the water drain hose is under pressure and may become loose from the installed connection position.

- ▶ Secure the water drain hose to prevent it from accidentally coming loose.

A clogged or blocked drain can cause accumulated waste water to flow back into the appliance.

- ▶ Before using the appliance, ensure that waste water flows away quickly and remove any blockages.

Remark: Observe the pumping heights.
The maximum pumping height is 100 cm.

Siphon

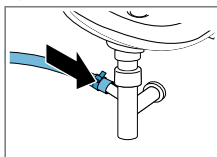

The connection position with a snake-klthem (24-40 mm) above rgen.

Washbasin

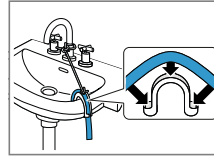

The water drain-feed hose with a curved section fix and secure.
→ "Accessories", Page 28

Plastic stand-pipe with rubber run mof or a drain

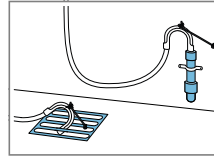

The water drain-feed hose with a curved section fix and secure.
→ "Accessories", Page 28

Connecting the appliance electrically

Remark: Your electrical installation for this appliance must comply with local statutory and safety regulations and must include a residual current device (RCD).

1. Plug the appliance's power cord into a socket near the appliance.

The connection data of the device can be found in the technical data Page 53→

2. Check the power plug for tightness.

4.6 Setting up the appliance

To reduce noise and vibrations and to prevent the appliance from walking, place the appliance horizontally.

1. Turn the lock nuts clockwise using a wrench with a key width of 17.

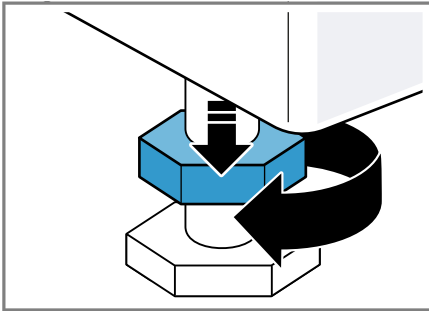

2. To level the appliance, turn the feet. Check the appliance's horizontal alignment with a spirit level.

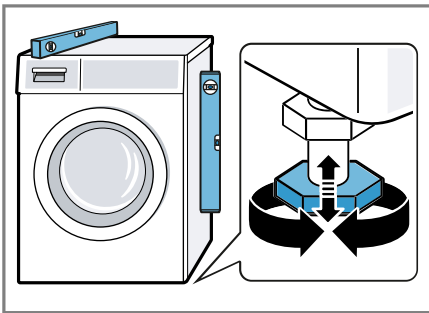

All appliance feet must stand firmly on the floor.

3. Tighten the lock nuts with a wrench with a key width of 17

hand-tighten against the housing.

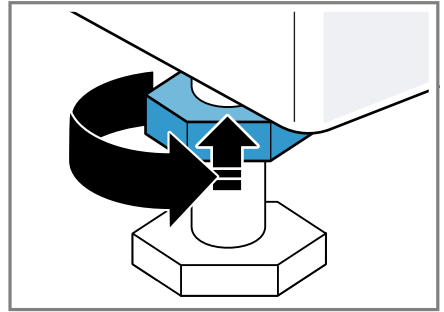

Hold the device foot and do not adjust its height.

5 Before first use

Prepare the appliance for use.

5.1 Start wash cycle without laundry

Your appliance was thoroughly inspected before leaving the factory. To remove any residual water, wash the first time without any laundry.

1. Press . 
The power on process takes a few seconds.
2. The program **Cotton 90°C** set or select the drum cleaning program in the Home Connect app.
3. Close the door.
4. Pull out the detergent drawer.

Before first use

5. Pour approximately 1 litre of tap water into the manual dosing compartment.

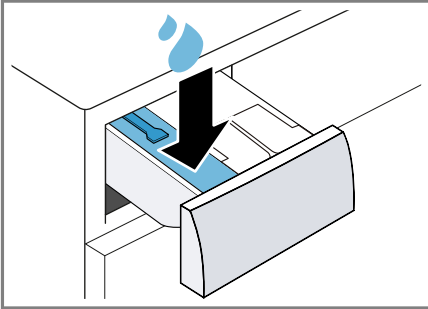

6. Powder detergent with oxygen bleach in the compartment

for manual dosing.

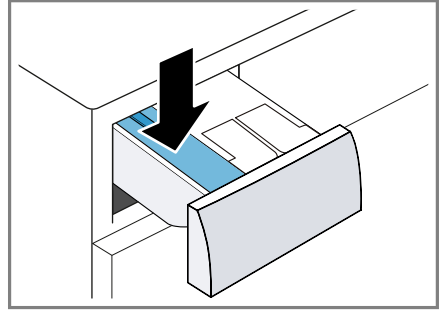

To avoid foaming, use only half the amount recommended by the detergent manufacturer for light soiling. Do not use wool or delicate detergent.

7. Slide the detergent drawer into the appliance.

8. Start the program. *Page 31*→

9. Start the first wash or press , to put the appliance in standby mode.

→ *"The Ministry in Essentials",
Page 30*

6 Getting to know your device

6.1 Device

Here you will find an overview of the parts of your device.

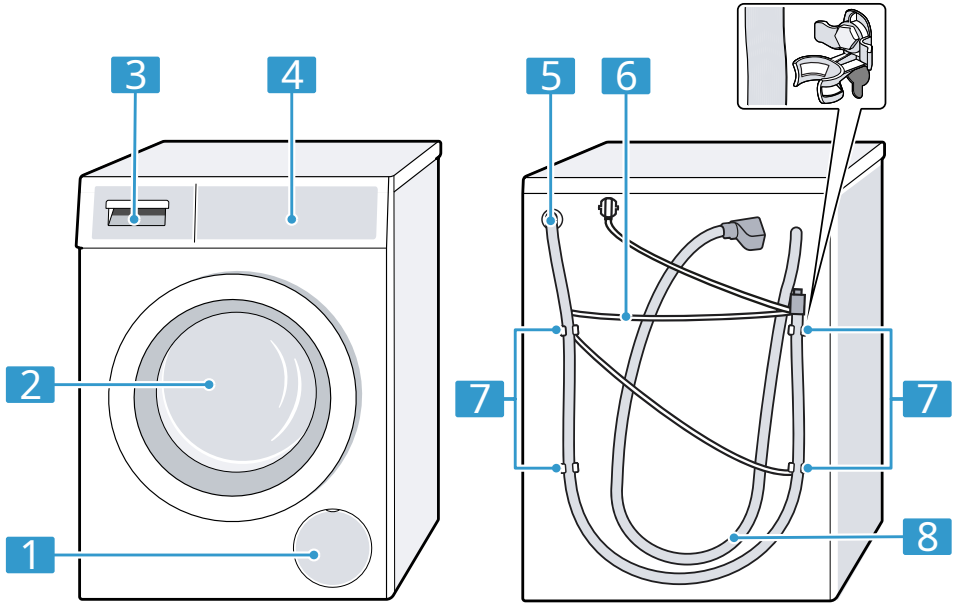

Depending on the device type, details in the image may differ, e.g. the color or shape and .

1	Service valve and pump → Page 40
2	Door Page 31
3	Detergent drawer → Page 17
4	Control panel and → Page 18

5	Water drain hose → Page 14
6	Power connection cable → Page 14
7	Transport security → Page 12
8	Water supply hose Page 13

6.2 Detergent drawer

Remark: Take the manufacturers' information on the use and dosage of the detergents and maintenance products and the information

Getting to know your device

please note the tie in the program descriptions.

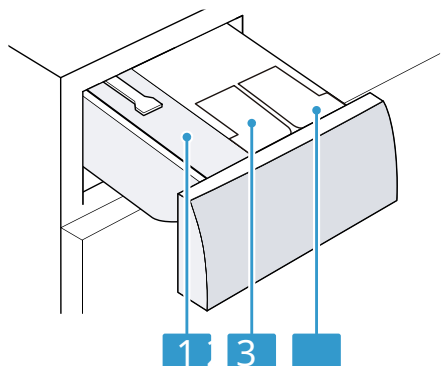

Container for manual dosing

1 → "Using the manual dosing container", Page 33

⊗ / ⊙: dosing compartment for fabric softener or liquid detergent
2 → "Intelligent dosing system", Page 32

⊖: dosing compartment for liquid detergent
3 → "Intelligent dosing system", Page 32

6.3 Control panel

You can use the control panel to set all functions of your device and obtain information about its operating status.

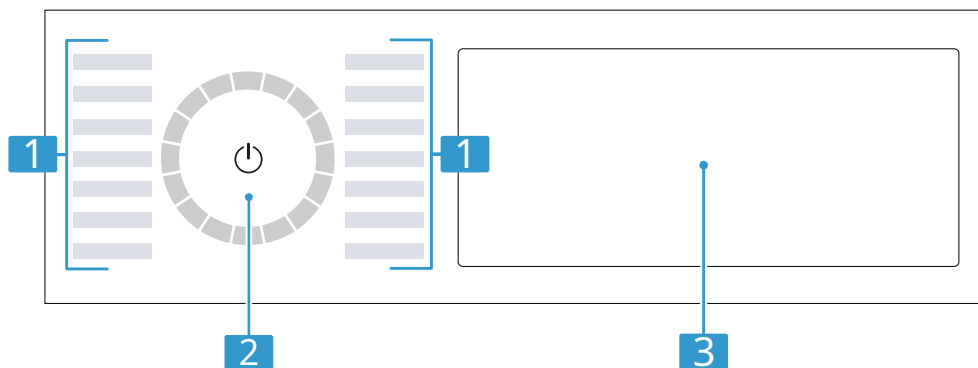

1 Programs *Page 24*

2 Program selector → *Page 30*

3 Tests → *Pagina 21* and display *Page 19*

They activate, deactivate, or change settings by pressing the buttons; the activated settings are clearly indicated on the display.

6.4 Operating logic

Some areas of the display are keys and respond to touch

NB

Forcibly impacting the display may cause damage.

- ▶ Do not apply strong pressure to the display.
- ▶ Do not press the display with pointed or sharp objects.

Show or hide additional keys

Some keys are hidden for a reduced display size. If you display these additional keys on the display, you can activate or deactivate the corresponding settings.

1. To display the additional keys, press briefly **More** to print.

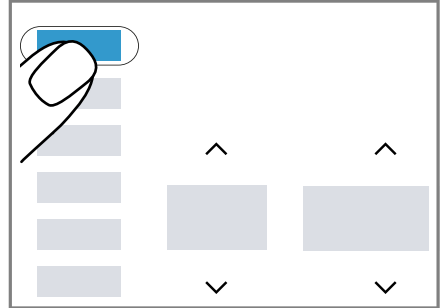

- ✓ The display shows all additional keys.

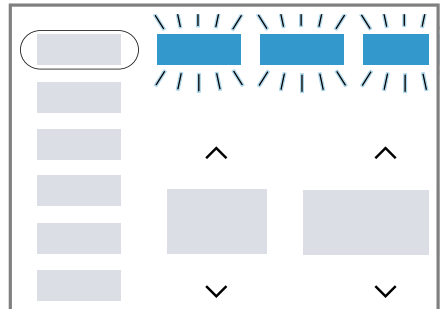

2. To hide the extra keys, press again briefly **More** to print.

Change setting value

When you activate certain settings, the display shows selection buttons and you can change the setting value.

- ▶ Press the selection buttons
→ *Page 22*.
The display shows the setting value.

7 Display

The display shows the current setting values, options or instructions. song lyrics.

The display shows afha probably some indications from the program status the range,  End.

Remark: By soft Software updates may include additional features.
→ *Page 35*

Display



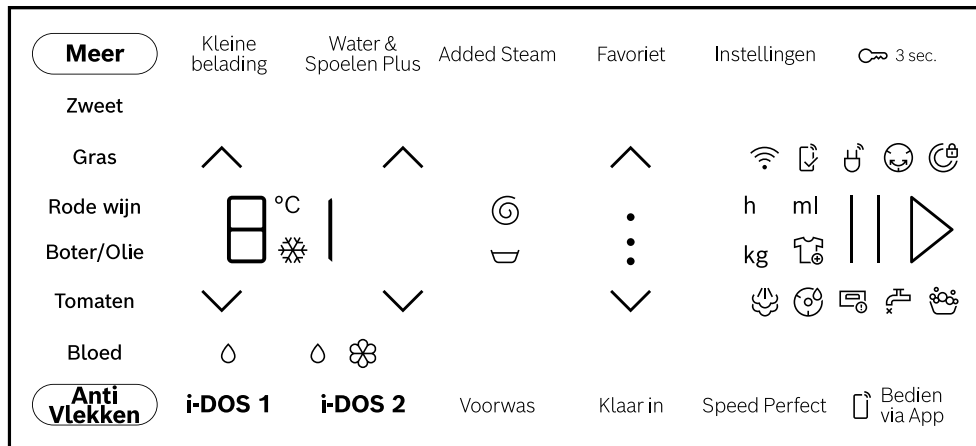







If a software update is available, you will find more information in the Home Connect app.



Example display indication

Indication	Description
0:40 ₁	Expected program duration or remaining time of the program in hours and minutes.
10 h ₁	Program end time <i>Page 23</i>
11.0 ₁	Recommendation of the maximum load quantity for the set program in kg.
▽ - 1600	Set spin speed in rpm. <i>Page 230</i> : no final spin, only pumping ▽: Flush stop, without pumping out
❄ - 90	Set temperature in °C. <i>Page 23</i> → ❄ (cold)
End	Program status: program end
☁	Program status: steaming
👤	You can remove or add laundry and view the current interrupt program. <i>Page 31</i> →
Blood	The blood stain type is activated.
Grass	The grass stain type is activated.
Red wine	The red wine stain type is activated.
Sweat	The sweat stain type is activated.
Butter/Oil and	Handy theft type spj jswe t/spj jsoil e is activated.
Tomatoes	The tomato stain type is activated.

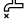
¹Example

Indication	Description
	Flashing: Drum cleaning required. Run the Cotton 90°C program to clean and maintain the drum and the lye reservoir. → Page 38
	Remote start is activated. → Page 23
	<ul style="list-style-type: none"> ■ lit: the device is connected to the home network via Wi-Fi. ■ Flashing: The device is trying to connect to the home network via Wi-Fi.
	<ul style="list-style-type: none"> ■ lights up: the intelligent dosing system for liquid detergent is activated. ■ flashing: the minimum filling level of the dosing container has fallen below. Page 33
 	<ul style="list-style-type: none"> ■ Lit: The intelligent dosing system for liquid detergent or fabric softener is activated. Flashing: The minimum fill level in the dispenser has fallen below the minimum level. Page 33
50 ml ¹	Basic dosage amount for the detergent or fabric softener. Page 34 →
	The appliance has detected too much foam. → Page 46
	<ul style="list-style-type: none"> ■ lit: the door is locked. <ul style="list-style-type: none"> - To add laundry, the door can be unlocked when the light is on. Page 31 → - To be able to open the door, you can cancel the program. Page 32 ■ flashing: the door is not closed.
	<ul style="list-style-type: none"> ■ No water pressure. Page 45 ■ The water pressure from the tap is too low.
	The detergent drawer is not fully pushed in. → Page 46
E:35 ¹	Error code, error indication, signal. Page 43

8 Keys

Comments

- Due to software updates additional features may be available. Page 35 If a software update available, you will find more information in the Home Connect app.

¹Example





Tests

- You will find additional functions or settings in the Home Connect app.
You can only adjust some settings via the Home Connect app.

Some keys are hidden for a reduced display size. You can display these additional keys on the display. *Page 19* →

The selection of the program settings depends on the set program.

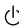
T-test	Description
▷	Start, cancel or pause a program. If is displayed, you can pause the program run. If ▷ is displayed, you can start the program.
∧ ∨	Change settings. → <i>Page 18</i>
Speed Perfect	Activate or deactivate shortened program duration. Remark: Energy consumption will increase. This will not affect the washing results.
Anti Stain	Choosing the type of stain. The temperature, drum movement and soaking time are adapted to the type of stain.
Added Steam	Activate or deactivate heating and steaming of the textile with water vapour. To loosen the laundry and prevent creasing, the spin cycle and spin speed are adjusted and the textiles are steamed at the end of the program. Comments <ul style="list-style-type: none"> Hang up laundry immediately after washing to reduce wrinkling. For programs with a load of more than 4 kg, the maximum load is reduced to 4 kg.
i-DOS 1	When you press the key briefly, you activate or deactivate the intelligent dosing system for liquid detergent ∅. WaWhen you press the button for about 3 seconds, you can hisset dispensing quantity. <i>Page 34</i>
i-DOS 2	WaWhen you press the key briefly, you activate or deactivate the iIntelligent dosing system for fabric softener or ⊗ flowdetergent. ∅ WaWhen you press the button for approx. 3 seconds, you can set you ⊗ the dosing container/change or the basic dosing quantity. → <i>Ppage 32</i>

T-test	Description
Ready in	Set the program end time. The program duration is already included in the set number of hours. After the program starts, the program duration is displayed.
^ v	Adjust the temperature.
^ v	Adjust or soften the spin speed.  (flush stop) acti- With the selection  the water at the end of the The wash cycle wasn't drained and the spin cycle was deactivated. The laundry remained in the rinse water.
	Turn the device on or put it in standby mode. If the control panel is unresponsive, press and hold for approximately 5 seconds to restart the device. → Page 47
 Control via App	Pressing the button briefly activates or deactivates the remote start. <i>Page 36</i> → Pressing the button for approximately 3 seconds opens the Home Connect settings. <i>Page 34</i>
 3 sec.	Activate or deactivate the child lock. → <i>Page 32</i>
Institutions	Call up basic settings. <i>Page 36</i> →
More	Show or hide additional keys. → <i>Page 19</i>
Small load	No need to wash loads of delicate or durable textiles. The program duration is shortened, water and energy consumption are adjusted accordingly, and the maximum load size is reduced to 0.5 kg.
Prewash	Activate or deactivate prewash, e.g. for washing heavily soiled laundry. Remark: When the intelligent dosing system is activated, the detergent is automatically dosed for the pre-wash and main wash. If the intelligent dosing system is deactivated, add the detergent for the prewash directly into the drum and for the main wash into the manual dosing compartment. <i>Page 17</i> →
Water & Rinsing Plus	Wash with more water and activate or deactivate an extra rinse cycle. Recommended for particularly sensitive skin or in areas with very soft water.
Favorite	If you press the button for approximately 3 seconds, you will save your individual program settings. <i>Page 30</i>

T-test	Description
	Pressing the button briefly will set your saved program with individual program settings.

9 Programs

Comments

- The laundry care labels provide additional guidance on program selection.
→ *"Care instructions on care labels", Page 29*
- The program's temperature setting ensures that the recommended temperature on the care label is not exceeded. The temperature reached in the appliance may deviate from the set temperature. This ensures the best possible washing results with optimal energy efficiency.
- Software updates may make additional features available. *Page 35* If a software update is available, you will find more information in the Home Connect app.

Program	Description	Maxi- male bela- thing (kg)
Cotton	Washing durable cotton and linen textiles. Also suitable as a shortened program for normally soiled laundry when you activate Speed Perfect. Program setting: <ul style="list-style-type: none"> ■ max. 90 °C ■ max. 1600 rpm 	10.0 5.0 ¹
Eco 40-60	Washing cotton and linen textiles.	11.0

Program	Description	Maxi- male bela- thing (kg)
	<p>Remark:Textiles that are washable at 40°C to 60°C according to the care symbol can be washed together. The washing result corresponds to the best possible washing performance class and complies with legal requirements.</p> <p>For this program, the wash temperature is automatically adjusted based on the load capacity to achieve optimal energy efficiency and the best possible wash results. The wash temperature cannot be adjusted.</p> <p>The spin speed is a maximum of 1600 rpm.</p>	
Wrinkle recovery- lend	<p>Washing synthetic textiles. Program setting:</p> <ul style="list-style-type: none"> ▪ max. 60 °C ▪ max. 1400 rpm 	4.0
Quick/Mix	<p>Wash textiles made of cotton, linen and synthetic materials. Suitable for lightly soiled laundry. Program setting:</p> <ul style="list-style-type: none"> ▪ max. 60 °C ▪ max. 1600 rpm 	4.0
Fine/Silk	<p>Wash delicate, washable textiles made of silk, viscose and synthetic fabrics. Use a detergent for delicate fabrics or silk.</p> <p>Remark:Wash particularly sensitive textiles or textiles with hooks, eyes or brackets in a laundry net.</p> <p>Tip:D for the gentle cleaning of the laundry rings s wear of textile fibres and microplastics even.</p> <p>Program mma setting:</p> <ul style="list-style-type: none"> ▪ max. 40 °C ▪ max. 800 rpm 	2.0
 Wool	<p>With the hand or machine washable textiles with a wool or high wool content.</p>	2.0

Program	Description	Maxi- male bela- thing (kg)
	<p>To prevent the laundry from shrinking, the drum with the textiles moves very gently with long pauses. Use a wool detergent. Program setting:</p> <ul style="list-style-type: none"> ▪ max. 40 °C ▪ max. 800 rpm 	
To rinse	<p>Rinsing followed by spinning and pumping off the water. Program setting: max. 1600 rpm</p>	-
Centrifuge/ Pumping off	<p>Centrifuge and drain the water. If you only want to drain the water, activate 0. The laundry will not be spun. Program setting: max. 1600 rpm</p>	-
 App program- moms	<p>Select other programs directly via the Home Connect app. The description of the programs can be found in the Home Connect app. Remark:Your device must be connected to your home network and registered in your Home Connect app. <i>Page 34</i></p>	-
Hygiene Plus	<p>Wash durable cotton and linen textiles. Suitable for allergy sufferers and those with high hygiene standards. Remark:Once the set temperature is reached, it remains constant throughout the entire washing process. Program setting:</p> <ul style="list-style-type: none"> ▪ max. 60 °C ▪ max. 1600 rpm 	6.5
Sport	<p>Sports textiles and leisure textiles made of synthetic fabrics. Used I use a detergent for sportswear. I Used don't use fabric softener. Tip: Wash heavily soiled laundry with program Crease Recovery.</p>	2.0

Program	Description	Maxi- male bela- thing (kg)
Iron Assist 	<p>Program setting:</p> <ul style="list-style-type: none"> ▪ max. 40 °C ▪ max. 800 rpm <p>Suitable for shirts, t-shirts and similar textiles made of cotton and linen.</p> <p>Program to heat and humidify dry textiles with water vapour so that the textiles can be hung up after the end of the program or to make ironing easier.</p> <p>The program load is a maximum of five shirts or five t-shirts.</p> <p>Activate Speed Perfect if you only want to steam one piece of laundry.</p> <p>Comments</p> <ul style="list-style-type: none"> ▪ Immediately after the program has ended, hang up warm and damp textiles or iron them. ▪ The textiles are not washed or cleaned. Do not use detergents or care products. ▪ The water vapor is hot and can damage certain types of fabric or textiles. Therefore, this program is not suitable for outdoor textiles or textiles made of silk or wool, such as sweaters. 	– 1
Car 40°C	<p>Wash sturdy textiles made of cotton and synthetic fabrics.</p> <p>The level of soiling and type of fabric are automatically detected. The washing process is adjusted accordingly.</p> <p>Remark:The temperature and the spin speed are not adjustable in this program and are automatically recorded.</p> <p>The temperature is maximum 40 °C.</p> <p>The maximum centrifuge speed is 1400 rpm.</p> <p>min.</p>	6.0

¹Washing not possible

Program	Description	Maxi- male bela- thing (kg)
Super Short 15/30 min.	Wash cotton and synthetic textiles. Short program for lightly soiled small items.	4.0 2.0 ₁
	<p>The program duration is approximately 30 minutes. To shorten the program duration to 15 minutes, activate Speed Perfect. The maximum load capacity will be reduced to 2.0 kg. Program setting:</p> <ul style="list-style-type: none"> ▪ max. 40 °C ▪ max. 1200 rpm 	

10 Accessories

Use only original accessories. These are designed for the device.

Tip: Some accessories are available in other colors. Please contact customer service. → *Page 51*

	Usage	Order number- sea
Extension of water supply feed hose	Extend cold water or Aquastop water supply hose (2.50 m).	WMZ2381
Extension of water drain feed hose	Extend water drain hose (2.20 m).	11057910
Mounting brackets	Improve the stability of the device.	WMZ2200
Bend	Fix the water drain hose.	00655300
Elevation	Place the appliance higher so that it can be easily filled and emptied.	WMZPW20W
Microplastic filter	External filter for the reduction of textile microplastics in wastewater.	WMZMPF10

11 Laundry

11.1 Preparing laundry

NB

Objects left in the laundry can damage the laundry and the drum.

- ▶ Before use, remove all items from laundry pockets.





Remark

When you prepare your laundry, you protect the appliance and the textiles.

- Brush out sand and soil. Sort laundry by color and fabric type, observing the care labels.
- Zippers, Velcro fasteners, hooks and eyes closures. Fabric belts, fabric straps and cords tied together.
- Removing curtain rollers and lead edges
- wash small or delicate items in a laundry net
- wash large and small items of laundry together
- Wash stained laundry immediately
- Pre-treat laundry with dried stains and wash several times
- Place laundry unfolded in the drum
- Laundry prepared with chlorine bleach a detergent, multiple rinse before that it is in the drum is done

11.2 Care instructions on care labels

Care instructions wash

Sym-bool	Recommended program
	Cotton (normal)
	Wrinkle recovery (careful)
	Delicate/silk for hand washing (very gentle)
	Wool (hand wash)
	(not machine washable)

12 Detergent and laundry care product

By selecting and using the right detergents and care products, you protect your appliance and your laundry.

Manufacturer's information on use and dosage can be found on the packaging.

Comments

- when using liquid detergents, use only self-flowing liquid detergents; do not mix different liquid detergents
- do not mix detergent and fabric softener
- Do not use products that have been stored for too long or have thickened significantly. Do not use solvent-based, caustic, or gas-forming agents.
- Do not use chlorine bleach. Use the colorant rarely because the fixing salt can damage the stainless steel.

The Operation in essence

- do not use bleach in the appliance
- Do not add vinegar to the dosing reservoir *Page 33* for the intelligent dosing system

13 The Ministry in essence

13.1 Switching on the device

Remark:When you switch on the appliance for the first time after connecting it to the electrical supply, the switching on operation will take up to one minute.

Requirements:The device is correctly set up and connected. *Page 11*

- ▶ Press . 
The power on process takes a few seconds.
- ✓ An audible function test is performed.

Remark:The drum light turns off automatically.

13.2 Program settings

- 1.Press the desired program. *Page 24*
→

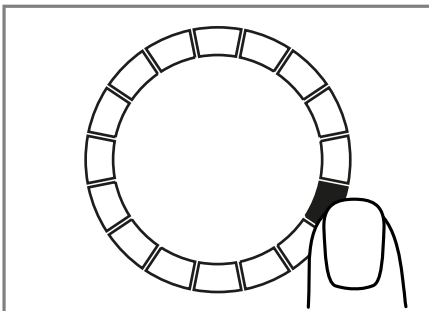

- ✓ The display shows the program-institutions.

- 2.Adjust the program settings. *Page 21* →

Take the information on the topic of operating logic

→ *Page 18* in consideration.

The program settings are not permanently saved for the program.

Remark:When you activate or deactivate the intelligent dosing system, the setting is saved.

Set up other programs

Requirements:Home Connect is installed. *Page 35*

- 1.The program **App programs** set up.

- ✓  **Control via App** blinks.

- 2.Press **Control via App** The Home

- ✓ Connect app shows the selectable programs.

- 3.Set a program in the Home Connect app.

- 4.Adjust the program settings if necessary. *Page 21* →

- 5.Start the program. *Page 31* →

13.3 Saving program settings

You can save your individual program settings as favorites.

Requirements:A program has been set. *Page 30*

- ▶ Press for about 3 seconds

Favorite.

Press **Favorite** to recall the saved program. **Remark:**To overwrite the

saved program, repeat the steps.

13.4 Opening the door

1.Reach under the door and pull the door.

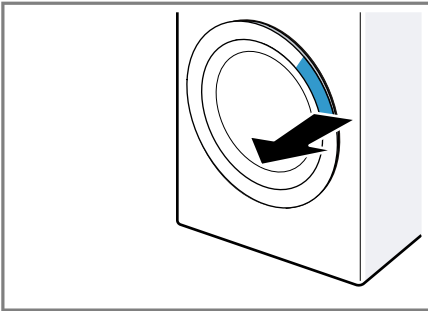

2.Open the door.

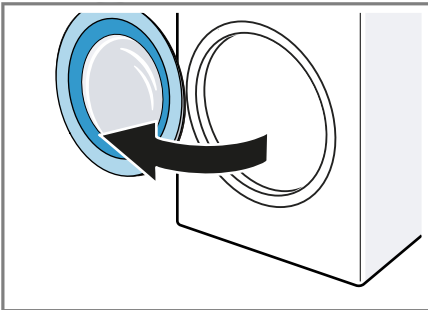

13.5 Filling the drum with laundry

Remark:To avoid creasing, please observe the maximum load for each program.*Page 24*

→

Requirements

- The laundry has been prepared and sorted*→Page 29*
- The drum is empty.

- 1.Open the door.*Dad→ gina 31*
- 2.The laundry in the mmel leg-troughs.
- 3.Close the door.

Make sure there are no a small one pieces of laundry between and the door to be stuck.

13.6 Starting the program

Remark:If the intelligent dosing system is activated, make sure the dosing containers are filled*Page 33*and the basic dosing amount is set

→ *Page 34.*

Requirements

- A program has been set.
→ *Page 30*
- The door is closed.
- ▶ Press . II ▷
- ✓ The drum rotates and a load recognition process takes place, which can take up to 2 minutes, after which water flows into the appliance.
- ✓ The display shows the program duration or the program end time.
- ✓ After the program ends, the display shows:**End**.

13.7 Soaking laundry

Remark:No additional detergent is needed for soaking. The appliance uses the rinsed-in detergent to soak and wash.

Requirements

- The laundry is placed.
→ *Page 31*
- The program has started.
→ *Page 31*

- 1.Press approximately 10 minutes after the program starts.
The program pauses and the laundry can soak.
- 2.After the desired soaking time, II ▷ press .

13.8 Adding laundry

After starting the program, you can remove or add laundry depending on the program status.

1. Press . II ▷

The device pauses.

Remark: If you want to add more laundry, please follow the instructions on the display. *Page 20*

2. Open the door. *Page 31*

3. Add or remove the laundry.

4. Close the door.

5. Start the program. *Page 31* →

13.9 Cancel program

1. Press . II ▷

2. Open the door. *Page 31* At high temperatures and high water levels, the appliance door remains locked for safety reasons.

- Start the program at a high temperature **To rinse**.
- Start the program at a high water level **Centrifuge** or select a suitable program for pumping out. *Page 24* →

3. Remove the laundry. *Page 32* →

13.10 Resume program after rinse hold

Requirements

- The flush stop has been activated. → *"Keys", Page 23*
- The last rinse of the set program has ended and the laundry is in the rinse water.

1. The program **Centrifuge** or a program for the pumping set pen. *Page* → *a 24*

2. Press . II ▷

13.11 Take out laundry **emen**

1. Open the door. *P* → *page 31*

2. The laundry from the tr **ommel** **nen**.men.

13.12 Putting the device into sleep (standby) mode

1. Press . ⏻

2. Cleaning the rubber cuff. → *Page 43*

Remark: Leave the appliance door and the detergent drawer open to dry.

14 Child lock

Protect your device against unwanted operation via the controls.

14.1 Enabling child lock

- ▶ Approx. 3 seconds on ⏻ **3 sec.** Busy-ken.
- ✓ The controls are locked.
- ✓ The child lock also remains active when the appliance is in standby mode and during a power failure.

14.2 Disabling child lock

Requirements: To deactivate the child lock, the appliance must be switched on.

- ▶ Approx. 3 seconds on ⏻ **3 sec.** Busy-ken.

15 Intelligent dosing system **teem**

The appliance's intelligent dosing system is activated at the factory and automatically doses liquid detergent and fabric softener for programmes where intelligent dosing is possible.

Remark: You can operate the intelligent dosing system with the keys → *Page 21* deactivate, e.g. to

powder detergent to be dosed manually *Page 33*.

15.1 The liquid detergent dispenser and fill fabric softener

If you use the intelligent dosing system or if the appliance displays an indication during use, fill the dosing containers.

Comments

- Fill the dosing compartments only with suitable liquid detergent and fabric softener. *Page 29* When adding liquid detergent or fabric softener to the dispenser, use the same product. If you replace the liquid detergent or fabric softener in the dispenser with a different product, clean the detergent drawer first. → *Page 38*.
- When using the intelligent dosing system, do not add extra detergent or fabric softener to the manual dosing compartment to avoid overdosing or foaming.

1. Pull out the detergent drawer.
2. Open the lids and add liquid detergent and fabric softener ☒

in the relevant dosing containers → *Page 17* doing.

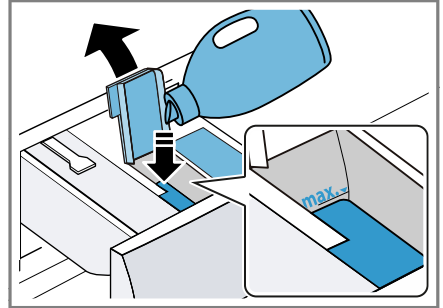

When filling, do not exceed the maximum filling level marking.

Remark: You can also use both liquid detergent dispensers. Simply adjust the dispenser to do this. *Page 34* →

3. Close the lids. **Remark:** Close the lids immediately after filling to ensure that the liquid detergent or fabric softener does not dry out.
4. Slide the detergent drawer into the appliance.

15.2 Using the manual dosing container

If you are not using the intelligent dosing system, if intelligent dosing is not possible with a programme, or if you want to add other care products, e.g. stain remover or starch, use the manual dosing container.

Remark: Follow the instructions for detergent and care products *Page 29* On. →



1. Pull out the detergent drawer.
2. The detergent or care product in the manual compartment

the dosage → *Page 17* add-gene.

3. Slide the detergent drawer into the appliance.

15.3 Dosing container Change-

to lend

The dosing container   can wash Dose softer or liquid detergent. The fabric softener dispenser is factory-set. If you are automatically dosing a second liquid detergent, adjust the dispenser.

Comments

- When you change the contents of the dosing reservoir, the basic dosage for this dosing reservoir is reset.
- When using both liquid detergent dispensers, you must set which dispenser to use during the wash. *Page 21*

→

1. Approx. 3 seconds oni-DOS 2 to print.

2. So often oni-DOS 2 press until the display shows (liquid detergent) or (fabric softener).

3. Wait briefly to save the setting.

15.4 Setting the basic dosing quantity

To create an intelligent ering possible dose, set the amount for basic dosage the do The basic dosing put in seeping trays. amount heath comes corresponds to the dosage of recommendation the detergent manufacturer ant on the ver-packing. Set a base oseerhoe-multiplicity that matches thto be added d scale for 4.5 kg standard eel polluted

laundry matches the water hardness.

Tip: You can also set the basic dosing amount in the Home Connect app.

1. Approx. 3 seconds oni-DOS 1 to print.

✓ The display shows the set basic dosing quantity.

2. Press / to adjust the setting.

3. Wait briefly to save the setting.

Remark: To set the basic dosing amount for the other dosing container, repeat the steps withi-DOS 2.

16 Home Connect

This device is network-enabled. Connect your device to a mobile device to control functions via the Home Connect app, adjust basic settings, or monitor the current operating status.

Home Connect services are not available in every country. The availability of the Home Connect feature depends on the availability of Home Connect services in your country. Information about this can be found at: www.home-connect.com The Home Connect app will guide you through the entire registration process. Follow the prompts and adhere to the instructions in the Home Connect app.

Comments

- Please observe the safety instructions in this manual and ensure that they are also observed when operating the appliance via the Home Connect app. → "Safety", Page 3

- Operation on the appliance always has priority. During this time, operation via the Home Connect app is not possible.

16.1 Setting up Home Connect

Requirements:The device must have reception of the home network (WiFi) at the installation location.

1.Scan the following QR code.



You can install the Home Connect app and connect your appliance via the QR code.

2.Follow the instructions in the Home Connect app.

16.2 Disabling Wi-Fi on the device

- 1.Approx. 3 seconds on **Control via App** print.
- 2.So often on **Control via App** press until the display shows "on".
- 3.Press **to** deactivate Wi-Fi.

- ✓ The display shows "oFF".

Opmerking:To the Home C
icn on te v and Dr. you kt you approx. 3
second n on **Control v ia App**.

16.3 Wi-Fi mandt apparat ac- TV en

1. Ca . 3 seconds **and** **Bedi and via App** and **n**.

2.So often on **Control via App** press until the display shows "oFF".

3.Press **to** activate Wi-Fi.

- ✓ The display shows "on".

Comments

- When Wi-Fi is activated, the display alternates between "on" and the signal strength of the Wi-Fi connection.
- To exit the Home Connect settings, press for approximately 3 seconds **Control via App**.

16.4 Installing a software update

Remark:If a software update is available, a notification will appear in the Home Connect app.

- ▶ To install the software update, follow the instructions in the Home Connect app.
- ✓ During installation the control panel is partially blocked.
- ✓ In the event of a malfunction, installation may take up to 40 minutes. Do not reset the network settings or the device to the factory defaults.

16.5 Resetting the device's network settings

- 1.Approx. 3 seconds on **Control via App** to print.
- 2.So often on **Control via App** press until the display shows "rES".

- 3.Press and hold for **about** 3 seconds.
- ✓ The network settings will be reset.

16.6 Remote Start

Release the device for remote start via the Home Connect app.

Remark

Remote start is deactivated under the following circumstances:

- The appliance door is opened.
-  **Control via App** is pressed. After
- a power outage.

Activate remote start

Requirements

- The appliance door is closed. The
- detergent drawer is slid shut.

▶ Press **Control via App**.

- ✓  lights up and the appliance has been released for remote start via the Home Connect app.

Disable remote start

▶ Press **Control via App**.

- ✓  goes out.

16.7 Remote diagnosis

Customer Service can access your appliance via remote diagnosis if you contact Customer Service with your request, your appliance is connected to the Home Connect server, and remote diagnosis is available in the country where you are using the appliance.

Tip: More information and instructions You can find information nature of about the available remote in your country diagnosis in the sports service/sup-section of the local website at: www.home-connect.com .

16.8 Protection of personal data

Please observe the instructions regarding the protection of personal data.

When your device is connected to an internet-enabled home network for the first time, it transmits the following categories of data to the Home Connect server (initial registration):

- Unique identification of the device (consisting of device keys and the MAC address of the built-in WiFi communication module).
- Security certificate of the WiFi communication module (for IT security of the connection).
- The current software and hardware version of your appliance. Status of
- any previous factory reset.

Initial registration prepares you for use of Home Connect features. This registration only needs to be completed when you first want to use Home Connect features.

Remark: Please note that Home Connect features can only be used in conjunction with the Home Connect app. Information on data protection can be found in the Home Connect app.

17 Basic Settings

You can configure the basic settings of your device according to your wishes.

Remark:You can also adjust the basic settings in the Home Connect app.

17.1 Overview of basic settings

Remark:Software updates may make additional features available.
Page 35

If a software update is available, you will find more information in the Home Connect app.

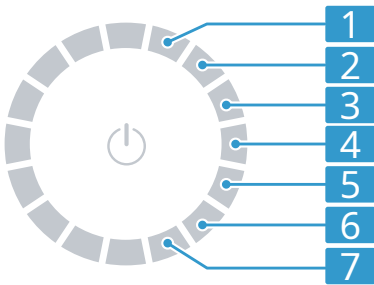

Program selector with program positions

1	Set the volume of the signal after program end: 0 (off) to 4 (very loud) Factory setting: 3
2	To set the volume of the signal when selecting keys: 0 (off) to 4 (very loud) Factory default: 3
3	The brightness of the display set: 1 (low) to 4 (high) (el high) Factory setting: 4
4	No basic settings g.
5	The memory for the drum-active cleaning powder and (on) or deactivate (oFF). Factory setting: o n

6	Display the number of terminated programs (PC).
7	Reset device to factory settings (rES).

17.2 Changing basic settings

Requirements:The display shows all additional keys. *Page 19*

1. Press **Institutions** to call up the basic settings.
2. Select the desired basic setting with the program selector.
→ *Page 37*
3. To adjust the basic setting: Press or ▶ to change the value.
 - ▶ To reset the device to factory settings, press and hold for approximately 13 seconds.
4. Press **Institutions** to exit the basic settings.

18 Cleaning and main- loves

18.1 Maintaining the device

Measure	Circumstance/inter-fall
Drum clean → <i>Page 38</i>	<ul style="list-style-type: none"> ■ ☹️ blinks. ■ You have performed 20 washes at a temperature of 40°C or lower. ■ You have not used the device for a long time.

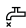
Measure	Circumstance/inter-fall
Sift in the water supply feed clean ¹	<ul style="list-style-type: none"> The display shows the error code E:30 -10 / .
Disposal-pump cleaning gene → Page 40	<ul style="list-style-type: none"> You hear clacking sounds. The display shows the error code E:36 -25 - 26. The display shows the error code E:38 -25 - 26.
Laundry detergent-drawer cleaning gene → Page 38	<ul style="list-style-type: none"> You switch from fabric softener to a second detergent share or vice versa. The dosing function falls out. The display shows the error code E:10 -00 - 10 -20. Every two months.
Rubber-cuff and inlet open-cleaning gene → Page 43	<ul style="list-style-type: none"> After every wash.
Device descaling	<ul style="list-style-type: none"> You see lime stains on the inside of the door or on the rubber collar.

18.2 Drum cleaning and

Clean the drum if you have performed at a lower temperature, although

or if you do not use the device for a long time

20 washes-
from 40°C or
sinks
not at the time

have used, at least once a year.

CAREFULLY Risk of injury!

Permanent washing at low temperatures and lack of ventilation of the appliance can damage the drum and cause injuries.

- ▶ Regularly run a drum cleaning program or wash at temperatures of at least 60 °C.
- ▶ Allow the appliance to dry with the door and detergent drawer open after each use.
- ▶ The program **Cotton 90°C** or select the drum cleaning program in the Home Connect app.

Run the programme without laundry using a powder cleaning agent containing oxygen bleach or a cleaning agent for maintaining the interior of the appliance.

18.3 Cleaning the detergent drawer

If you want to replace the liquid detergent or fabric softener in the dosing reservoir with another product or if the detergent drawer is dirty, clean the detergent drawer.

NB

The pump unit contains electrical components.

Electrical components may be damaged by contact with water.

- ▶ Do not put the pump unit in the dishwasher clean or immerse in water.

¹ More information can be found via the digital user manual by scanning the information or on QR code in the table of contents. www.bosch-home.com.

- ▶ Protect the electrical connections at the rear from moisture, detergent and fabric softener residue.

Remark: Scan the QR code to see an animation of the progression.



1. Put the device in standby mode.
Page 32→
2. Pull out the detergent drawer.
3. Press the insert down and remove the detergent drawer.

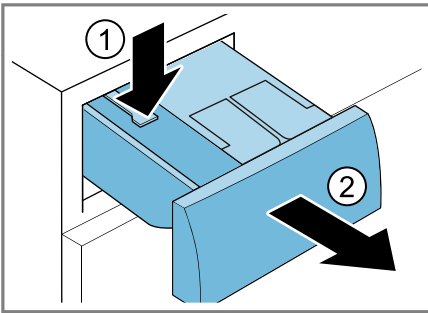

4. Remove the pump unit.

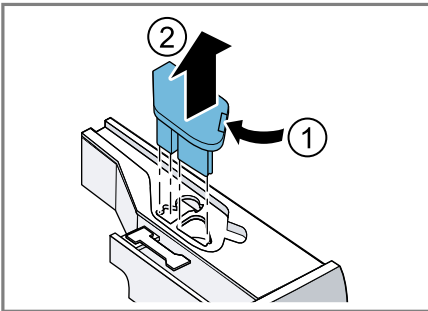

5. Unlock and remove the detergent drawer lid.

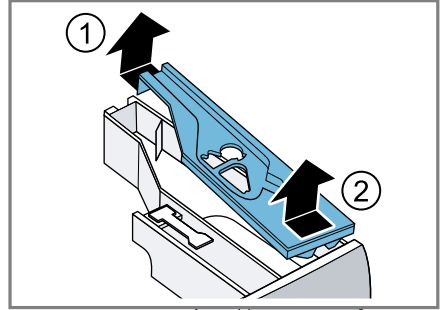

6. Empty the detergent drawer.

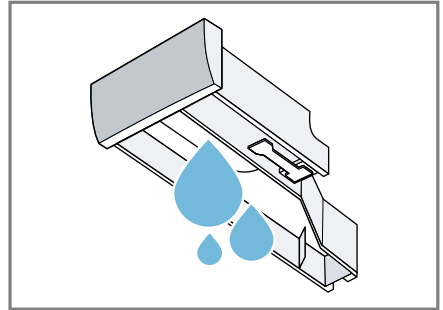

7. Clean the pump unit with a damp cloth.

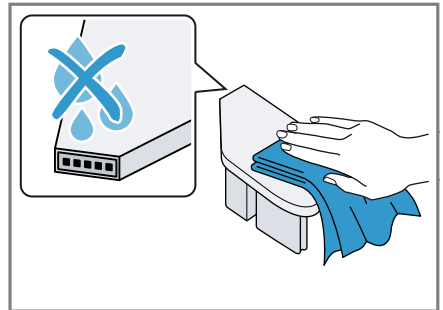

8. Clean the detergent drawer and lid with a soft, damp cloth or hand shower.

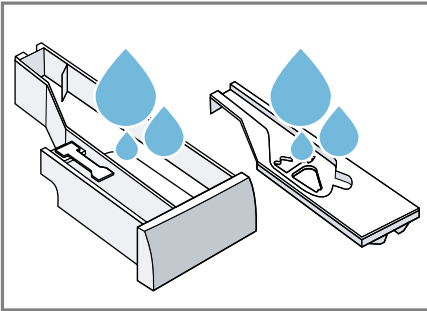

9. Insert the detergent drawer, dry the lid and pump unit and replace.

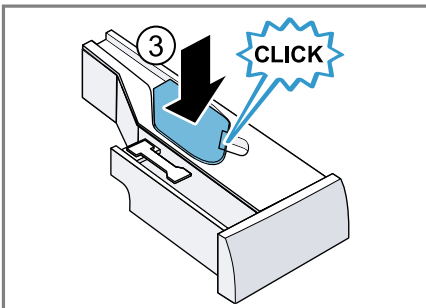
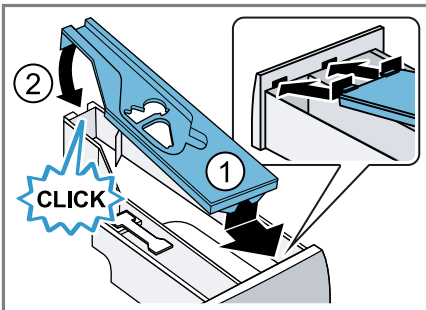

10. Clean the housing of the detergent drawer in the appliance.

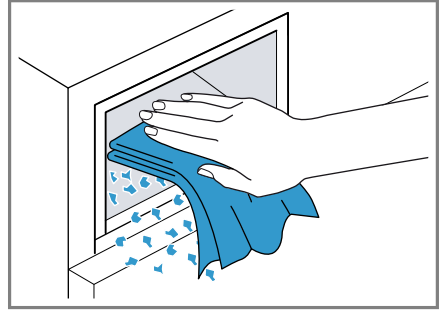

11. Slide the detergent drawer into the appliance.

18.4 Cleaning the drain pump

Clean the drain pump regularly, at least once a year and in case of malfunctions, e.g. blockages or chattering noises.

Remark: Scan the QR code to see an animation of the process. Before starting the animation, please observe the following safety precautions.



Emptying the drain pump

1. Close the water tap.
2. Put the device in standby mode.
Page 32→
3. Disconnect the appliance from the power supply.

4. Open and remove the service valve.

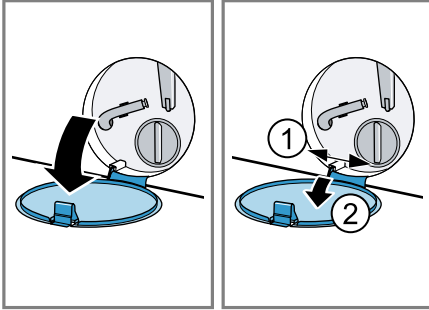

5. Slide a suitable collecting container for draining the wash water under the opening.

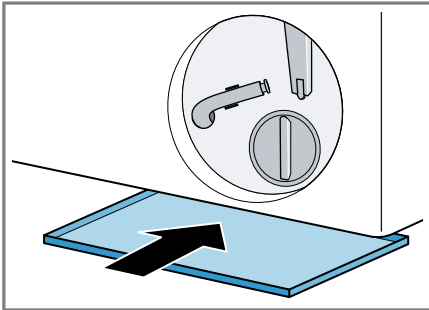

6. Remove the drain hose from the holder.

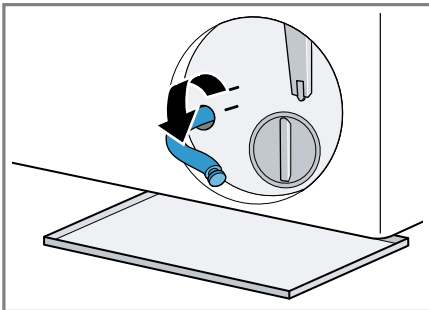

7. **⚠ CAUTION – Risk of burns!**

The soap gets hot when washing with high temperatures.

▶ **Ra** do not touch the hot soapy water.

Remove the sealing plug to allow the washing solution to flow into the collection container.

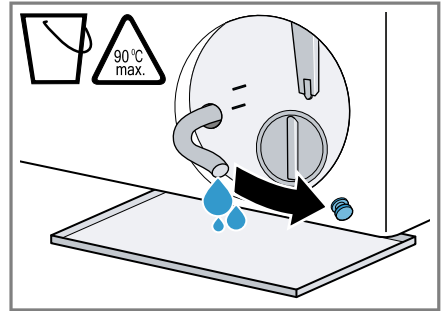

8. After emptying, press the sealing cap back on.

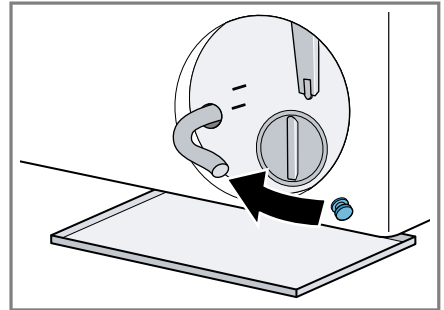

9. Clamp the drain hose into the holder.

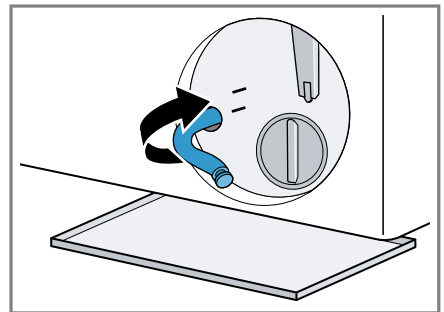

Cleaning the drain pump

Requirements: The drain pump is empty.

→ Page 40

1. Because there may still be residual water in the pump, carefully unscrew the cover.

- ▶ Large contaminants can cause the filter element to become stuck in the pump housing. Loosen the contaminants and remove the filter element.

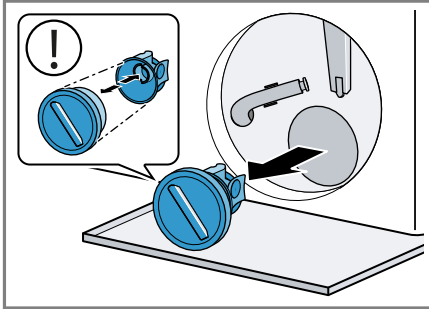

The pump cover consists of two components that can be dismantled for cleaning.

2. Clean the interior, pump cover threads and pump housing.

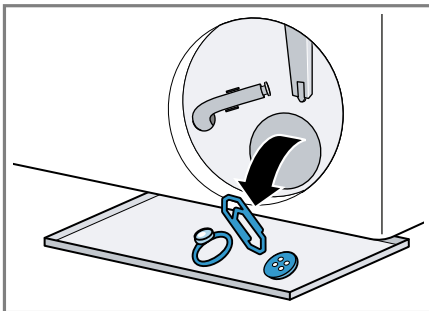

3. Make sure that both wing wheels can be turned.

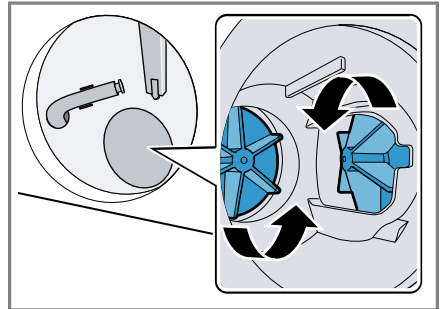

4. Replace the pump cover. Check that
▶ the pump cover components are correctly installed.

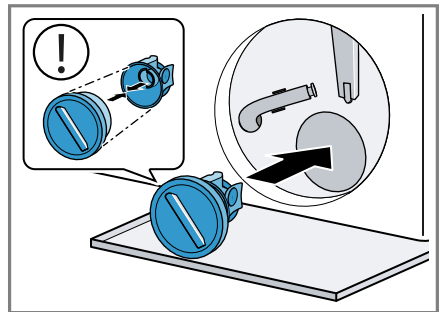

5. Tighten the pump cover as far as it will go.

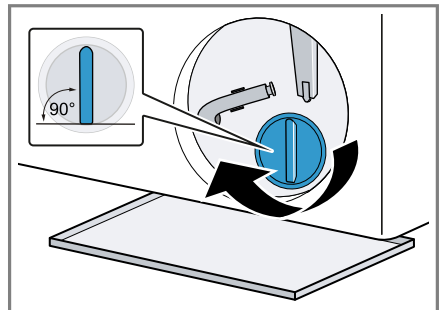

The pump cover handle should be vertical.

6. Install and close the service valve.

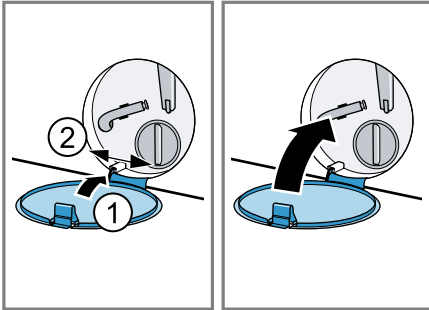

3. Remove any blockages from the inlet opening.

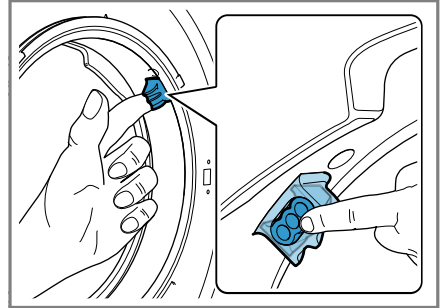

18.5 Cleaning the rubber sleeve

Clean the rubber cuff regularly.

1. Open the door. *Page 31*
2. Remove foreign objects and fluff from the drum and rubber gasket.

4. Clean the rubber cuff inside and out with a damp cloth and rub dry.

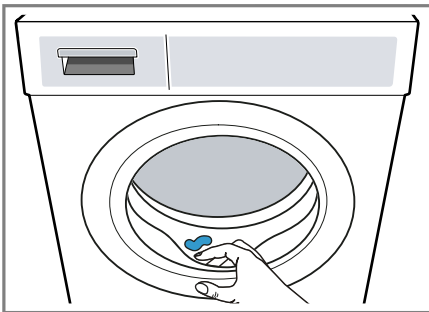

19 Troubleshooting

You can fix minor appliance malfunctions yourself. Before contacting customer service, consult the troubleshooting information. This will help you avoid unnecessary costs.

⚠ WARNING

Risk of electric shock! Unskilled repairs are dangerous.

- ▶ Never technically modify the device or its features.
- ▶ Only trained personnel may carry out repairs on the appliance.



execution honor n.



- ▶ There may be additional costs. The original spare parts are used for repairs at the expense of the customer.

Troubleshooting

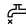
- ▶ If the power cord of this appliance is damaged, it must be replaced by the manufacturer, its service agent or a similarly qualified person in order to avoid a hazard.

Storage	Cause and Troubleshooting
The display is off and flashing.	Energy saving mode is active. ▶ Press . II ▶
E:36 -10 / E:30 -80 Wash water is not pumped away.	The water drain hose is connected too high, kinked, pinched or extended beyond acceptable limits. ▶ Check the installation of the water drain hose. → <i>Page 13</i>
	Drain pipe or water drain hose is clogged. ▶ Clean the drain pipe and the water drain hose.
	Pump is clogged or pump cover is not installed correctly. ▶ Check that the pump cover is installed correctly. <i>Page 40</i> ▶ Clean the drain pump. <i>Page 40</i>
	Detergent dosage is too high. ▶ When intelligent dosing is activated, reduce the basic dosing amount. → <i>Page 34</i> ▶ When dosing manually, reduce the amount of detergent the next time you wash with the same load.
	☐ has been activated. ▶ The program Centrifuge or start a suitable program to pump out. <i>Page 24</i> →
E:36 -25 -26	Drain pump is clogged. ▶ Clean the drain pump. <i>Page 40</i>
E:38 -25 -26	Drain pump is clogged. 1. Clean the drum. <i>Page 38</i> 2. If the problem persists, clean the pump. <i>Page 40</i> →
	The inlet opening of the rubber cuff is clogged. ▶ Clean the inlet opening in the rubber sleeve.
E:10 -00 -10 -20	The pump of the intelligent dosing system is blocked. 1. Clean the detergent drawer. <i>Page 38</i> 2. If the problem persists, please contact customer service. <i>Page 51</i> →

Storage	Cause and Troubleshooting
E:10 -00 -10 -20	<p>Remark:Until the fault is resolved, you can deactivate the intelligent dosing system and dose manually. <i>Page 21</i> →</p>
H:32	<p>The appliance has aborted the spin cycle due to uneven distribution of the laundry.</p> <ul style="list-style-type: none"> ▶ Redistribute the laundry in the drum.
E:30 -10 / 	<p>The water tap is closed.</p> <ul style="list-style-type: none"> ▶ Open the water tap. <hr/> <p>Water supply hose is kinked or pinched.</p> <ul style="list-style-type: none"> ▶ Check the installation of the water supply hose. → <i>Page 13</i> <hr/> <p>The sieve in the water supply is clogged.</p> <ul style="list-style-type: none"> ▶ Clean the sieve in the water supply. Scan the QR code to see an animation of the progression. <div data-bbox="396 651 542 799" style="text-align: center;">  </div>
	<p>Water pressure is low.</p> <ul style="list-style-type: none"> ▶ Check whether the water tap has sufficient water pressure.
	<p>Water level measuring system is defective.</p> <p>If the error message appears, the appliance will start a pump-down procedure.</p> <ol style="list-style-type: none"> 1.Wait approximately 5 minutes until the pumping procedure is completed. 2.Restart the device. If necessary, the pump-down procedure starts again. 3.If the problem persists, please contact customer service. <i>Page 51</i> →
E:35 -10	<p>Device is leaking.</p> <ol style="list-style-type: none"> 1.Close the water tap. 2.Please contact customer service. <i>Page 51</i> →
E:30 -20	<p>Critical function failure.</p> <ul style="list-style-type: none"> ▶ Close the tap. <p>If the error message appears, the appliance will start a pump-down procedure.</p>

Storage	Cause and Troubleshooting
E:30 -20	<ol style="list-style-type: none"> 1.Wait approximately 5 minutes until the pumping procedure is completed. 2.Restart the device. If necessary, the pump-down procedure starts again. 3.If the problem persists, please contact customer service.<i>Page 51</i> →
	<p>Detergent dosage is too high.</p> <ul style="list-style-type: none"> ▶ When dosing manually, reduce the amount of detergent the next time you wash with the same load.
	<p>Extra water was filled.</p> <ul style="list-style-type: none"> ▶ Do not add additional water to the appliance during operation.
All other error codes.	<p>Storage</p> <ol style="list-style-type: none"> 1.Press for about 5 seconds to restart the device. 2.If the fault occurs again, disconnect the appliance from the mains for at least 30 seconds. Unplug the power cord from the socket or switch off the fuse in the meter box. 3.If the problem persists, please contact customer service.<i>Page 51</i> → Provide the exact error message during the call. If possible, document the problem with photos and videos.
	<p>The detergent drawer is not fully pushed in.</p> <ul style="list-style-type: none"> ▶ Slide in the detergent drawer. <hr/> <p>Pump unit is not installed correctly.</p> <ul style="list-style-type: none"> ▶ Check that the pump unit is installed correctly. → <i>Page 38</i>
 or strong foaming.	<p>Detergent dosage is too high.</p> <ul style="list-style-type: none"> ▶ Immediate action: Mix one tablespoon of fabric softener with 0.5 liters of water and pour this mixture into the manual dosing compartment (not for outdoor, sportswear and down textiles). ▶ When intelligent dosing is activated, reduce the basic dosing amount. → <i>Page 34</i> ▶ When dosing manually, reduce the amount of detergent the next time you wash with the same load.
	<p>Drum cleaning required.</p> <ul style="list-style-type: none"> ▶ Clean the drum.<i>Page 38</i>

Storage	Cause and Troubleshooting
Display and buttons do not respond.	<p>Software error.</p> <ol style="list-style-type: none"> 1. Press for about 5 seconds to restart the device. 2. If the error occurs again, disconnect the appliance from the power supply for at least 30 seconds. Unplug the power cord or switch off the fuse in the fuse box.
Home Connect function does not dishonor correctly.	<p>There may be several possible causes.</p> <ol style="list-style-type: none"> 1. Reset the device's network settings. <i>Page 35</i> → 2. Reset Home Connect. <i>Page 35</i> Go to ▶ www.home-connect.com.
i-DOS 1/i-DOS 2 cannot be pressed.	<p>Selected program or program progress does not allow intelligent dosing.</p> <ul style="list-style-type: none"> ▶ Use the container for manual dosing. → <i>Page 33</i>
Program does not start.	<p>Child lock is activated.</p> <ul style="list-style-type: none"> ▶ Deactivate the child lock. <i>Page 32</i> <hr/> <p>Ready in has been activated.</p> <ul style="list-style-type: none"> ▶ Check if Ready in has been activated. <i>Page 23</i> <hr/> <p>The detergent drawer is not fully pushed in.</p> <ul style="list-style-type: none"> ▶ Slide in the detergent drawer.
Program is paused hurt or broken, but door cannot be opened.	<p>Temperature is too high.</p> <ul style="list-style-type: none"> ▶ Start the program To rinse or wait until the temperature has dropped. <hr/> <p>Water level is too high.</p> <ul style="list-style-type: none"> ▶ Start the program Centrifuge or a suitable program for pumping out. <i>Page 24</i> →
Door cannot be closed in case of power failure opened.	<p>Door is locked.</p> <ul style="list-style-type: none"> ▶ Open the door with the emergency release. → <i>Page 50</i>
Drum shakes after program start.	<p>No fault. Internal engine test started. No action required.</p>
Drum is turning, there no water flows into the appliance.	<p>No malfunction. Load detection is active for 2 minutes.</p> <p>No action required. No action required.</p>
The water is not visible in the drum-bar.	<p>No fault. Water is below the visible range. No action required.</p>

Storage	Cause and Troubleshooting
Start multiple times with centrifugation.	No malfunction. The appliance compensates for imbalance by redistributing the laundry several times. No action required.No action required.
Vibrations, movements and loud noises from the appliance during spinning.	The appliance is not properly levelled. ▶ Align the device. <i>Page 14</i> Device feet are not fixed. ▶ Secure the appliance feet. <i>Page 14</i> Transport protections have not been removed. ▶ Remove the transport protection devices.
High spin speed rental is not reached.	The appliance compensates for imbalance by reducing the spin speed. No action required.No action required.
The program duration changes during the wash cycle.	No malfunction. Program flow is electronically optimized, additional rinse cycle is triggered due to excessive foaming, or imbalance is compensated. No action required.No action required.
Rustling, hissing, buzzing or sucking-the sounds.	No malfunction. Water is being rinsed in, detergent and care products are being dispensed, function tests are being performed, or wash water is being pumped out. No action required.No action required.
Clapping, rattling in the pump.	There is a foreign object in the pump. ▶ Clean the drain pump. <i>Page 40</i>
Insufficient cleaning washing effect or washing middle residues on the laundry.	Detergents may contain water-insoluble substances, which are deposited on the laundry. ▶ Start the program To rinse or brush the laundry after drying. The detergent in the detergent dispenser is not suitable or has thickened. 1. Check whether the detergent is suitable. → <i>Page 29</i> 2. Check whether the detergent in the dispenser has thickened. 3. If the detergent is unsuitable or thickened, empty and clean the detergent dispensers: <i>Page 38</i> Basic dosing amount is not set correctly. ▶ Set the basic dosing amount. <i>Page 34</i> →

Storage	Cause and Troubleshooting
<p>After the end of the program, the textiles have Iron Assist moist spots formed.</p>	<p>Water droplets from the drum or the door have dampened the fabric. These droplets are either condensed steam or residual moisture from the previous wash cycle.</p> <ul style="list-style-type: none"> ▶ Iron the textile or hang it up to dry.
<p>Laundry is too wet after spinning.</p>	<p>Low spin speed is set.</p> <ul style="list-style-type: none"> ▶ Start the program Centrifuge. ▶ Next time you wash, set a higher spin speed.
	<p>The appliance compensates for imbalance by reducing the spin speed.</p> <ol style="list-style-type: none"> 1.Redistribute the laundry in the drum. 2.Start the program Centrifuge.
<p>Wrinkling.</p>	<p>The selected program is not suitable for the textile type.</p> <ul style="list-style-type: none"> ▶ Set a suitable program. <i>Page 24</i> →
	<p>High spin speed is set.</p> <ul style="list-style-type: none"> ▶ Next time you wash, set a lower spin speed.
	<p>Load is not suitable.</p> <ul style="list-style-type: none"> ▶ Please observe the maximum load capacity of the programmes. <i>Page 24</i> Prepare the laundry. <i>Page 29</i> ▶ →
<p>At the water supply feed hose leaks water.</p>	<p>The water supply hose is not connected or damaged.</p> <ul style="list-style-type: none"> ▶ Check the installation of the water supply hose. → <i>Page 11</i> In case of damage, please contact customer service. <i>Page 51</i> →
<p>There is water leaking from the drain hose.</p>	<p>Water drain hose is not connected correctly or is damaged.</p> <ul style="list-style-type: none"> ▶ Check the installation of the water drain hose. → <i>Page 11</i> If the water drain hose is damaged, replace it.
<p>Water is coming out from under the door.</p>	<p>Contamination on door or cuff causes leakage.</p> <ul style="list-style-type: none"> ▶ Clean the door and the cuff.
<p>An odor has formed in the appliance the.</p>	<p>Humidity and detergent residue can encourage bacterial growth.</p> <ul style="list-style-type: none"> ▶ Clean the drum. <i>Page 38</i> ▶ When not in use, leave the door and detergent drawer open to allow residual water to dry.

Transport, store and dispose of

19.1 Emergency release

Unlock door

Requirements:The drain pump is empty.

→ *Page 40*

- NOTE** –Runoff water can cause material damage.
 - ▶ Do not open the door if water is visible behind the glass.

Using a tool, pull the emergency release downwards and release.

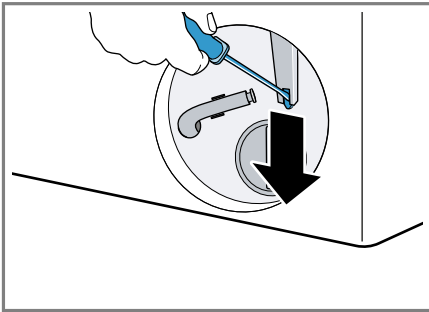

- ✓ The door lock is unlocked.
- 2.Replace the service valve and click it into place.
- 3.Close the service valve.

19.2 Resetting the electronic card

- 1.Press for about 5 seconds to restart the device.
- 2.If the fault occurs again, disconnect the appliance from the mains for at least 30 seconds.

Unplug the power cord from the socket or switch off the fuse in the meter box.

- 3.If the problem persists, please contact your customer service tenseservice. *Page a 51*

Please provide the exact error message during counting. phone call ing door. Docu-

if possible, please describe the fault with photos and videos.

20 Transport, on-hit and run

20.1 Disassembling the device

- 1.Close the water tap.
- 2.Empty the water supply hose.
- 3.Put the device in standby mode. *Page 32*→
- 4.Unplug the appliance from the wall socket.
- 5.Let the soap drain. "*Cleaning → the drain pump*", *Page 40*
- 6.Disassemble the hoses.
- 7.Empty the dosing reservoirs.

20.2 Installing transport security

To avoid transport damage, secure the device with transport protection devices before transporting.

- 1.The cover cap₁ remove with a screwdriver.

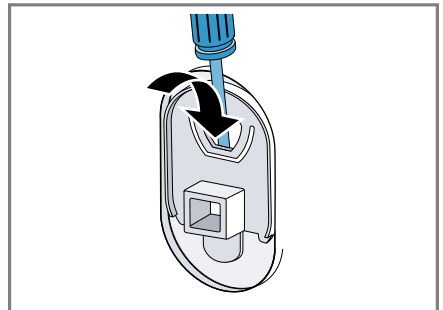

Save the cover cap.

- 2.Place the 4 transport protection devices.

₁The number of cover caps and varies depending on the model.

20.3 Reusing the appliance

- ▶ For more information, see Setting up and connecting *Page 11* and start empty wash cycle *Page 15*.

20.4 Disposal of your old appliance

Environmentally friendly disposal allows valuable raw materials to be reused.

WARNING **Risk of health hazard!**

Children could lock themselves in the appliance and endanger their lives.

- ▶ Do not install the appliance behind a door that blocks or prevents the appliance door from opening.
- ▶ On discarded appliances, unplug the power cord, then cut through the power cord and damage the appliance door lock in such a way that the appliance door no longer closes.

1. Unplug the power cord from the electrical outlet.

2. Cut the power cord.

3. Dispose of the appliance in an environmentally friendly manner.

You can obtain information about current disposal methods from your dealer and your municipal or district council office.



This appliance is marked in accordance with compliance with the European Directive 2012/19/EU on waste electrical and electronic equipment (waste electrical and electronic equipment)

cal and electronic equipment - WEEE). The Directive sets the framework for the take-back and processing of old equipment.

21 Service Department

You can obtain original replacement parts relevant to operation in accordance with the relevant Ecodesign Regulation from our service department for a period of at least 10 years from the date the appliance is placed on the market within the European Economic Area.

Remark: Activating the service department within the framework of the manufacturer's warranty conditions is free of charge.

You can obtain detailed information about the warranty period and terms and conditions in your country via the QR code on the enclosed document regarding service contacts and warranty conditions, from our customer service, your dealer, or on our website.

When contacting customer service, you will need the product number (E-No.), production number (FD) and serial number (Z-No.) of the appliance.

You can find customer service contact details via the QR code on the enclosed document about service contacts and warranty conditions or on our website.

21.1 Product number (E-No.), production number (FD) and serial number (Z-Nr.)

The product number (E-Nr.), the production number (FD) and the serial number

Consumption values

You will find the identification number (Z-Nr.) on the type plate of the appliance.

Depending on the model, the type plate is located:

- on the inside of the door. on the
- inside of the maintenance flap.
- on the back of the device.

To quickly find your device information and service phone numbers, you can write down the information.

21.2 AQUA-STOP warranty

In addition to the warranty claims against the seller based on the purchase agreement and our manufacturer's warranty, you will be compensated if the conditions below are met.

- If a fault in the AquaStop system causes water damage, we will compensate private users for the damage.

To ensure safety the appliance must be connected to the mains.

- The liability warranty applies for the lifetime of the device.
- The condition for a warranty claim is that the appliance with AquaStop has been installed and connected professionally and in accordance with our installation instructions; this also includes the professionally fitted extension of the AquaStop (original accessory). Our warranty does not cover defective supply lines or fittings up to the AquaStop connection on the tap.
- While using an AquaStop appliance, you generally don't need to be present or turn off the tap for safety reasons after use. Only during extended absences, such as a few weeks' vacation, should the tap be turned off.

22 Consumption values

The following information is provided in accordance with the EU Ecodesign Regulation. The values given for other programs such as **Eco 40-60** These are guidelines only and were determined in accordance with the applicable standard EN60456. The automatic dosing function has been deactivated for this purpose.

Note regarding the comparison test: deactivate the automatic dosing function tie, unless this function has the object of the test is.

Program	Bela-thing (kg)	Pro-gram-maduur (h:min) ₁	Energy-giver-use (kWh/cycle) ₁	Water-far-use (l/cycle) ₁	Maxi-male tempe-nature (°C) 5 min ₁	Centri-fugue-touring tal (t/ min) ₁	Rest-moisture-content (%) ₁
Eco 40-60 ₂	11.0	3:59	0.870	61.0	38	1551	45.90
Eco 40-60 ₂	5.5	2:59	0.380	47.0	27	1551	44.60
Eco 40-60 ₂	3.0	2:59	0.210	34	24	1551	44.60
Cotton 20 °C	10.0	2:59	0.410	91.0	22	1600	48.00
Cotton 40 °C	10.0	2:59	1,230	91.0	41	1600	48.00
Cotton 60 °C	10.0	2:59	2,090	91.0	61	1600	48.00
Cotton 40 °C + Prewash	10.0	3:33	1,470	107.0	42	1600	48.00
Wrinkle recovery-tender 40 °C	4.0	2:29	0.850	60.0	44	1200	35.00
Quick/Mix 40 °C	4.0	1:00	0.720	45.0	42	1400	52.00
 Wool 30 °C	2.0	0:40	0.240	42.0	27	600	32.00

23 Technical data

Device height	84.5 cm
Device width	59.8 cm
Device depth	59.0 cm
Device depth with closed door	64.8 cm
Device depth with open door	109.0 cm
Weight	81.5 kg
Maximum tax thing	11.0 kg

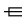
Mains voltage	220-240 V, 50 Hz
 Minimum in-installation fuse	10 A
Nominal power gene	2300 W

¹ Actual values may differ from the stated values due to the influence of water pressure, hardness and inlet temperature, ambient temperature, type, quantity and soiling of laundry, detergent used, fluctuations in the power supply and selected additional functions.

² Test programme according to the EU Ecodesign Regulation and the EU Energy Label Regulation with cold water (15°C).

Recorded ver- to be allowed to	<ul style="list-style-type: none"> ■ Standby mode: 0.50 W ■ Not Disabled basement condition: 0.50 W ■ Time to Network-bound standby is set up (Wi-Fi): 5 min ■ Network-bound the standby (WiFi): 2.00 W
Water pressure	<ul style="list-style-type: none"> ■ At least: 100 kPa (1 bar) ■ Maximum: 1000 kPa (10 bar)
Length of the water supply feed hose	150 cm
Length of the water drain hose	150 cm
Length of the power connection cable	160 cm

This product contains light sources of energy class F. The light sources are available as spare parts and may only be replaced by a trained technician.

You can find more information about your model on the internet under <https://eprel.ec.europa.eu/qr/2321943>; This web address refers to the official EU Product Database EP REL.

23.1 Information about free software and open source software

This product includes software components licensed as free software or open source software by their intellectual property holders.

The information about the relevant license is stored in the home appliance. You can also view this license information via the Home Connect app: 'Profile -> Legal information -> License information'.²You can also download the license information from the product website. (Search the product website for your device model and its documentation.) Alternatively, you can request the information by emailing ossrequest@bshg.com or contacting BSH Hausgeräte GmbH, Carl-Wery-Str. 34, D-81739 Munich.

The source code will be made available to you upon request.

Please send a request to ossrequest@bshg.com or to BSH Hausgeräte GmbH, Carl-Wery-Str. 34, D-81739 Munich.

Subject: "OSSREQUEST" You will be charged for processing your request. This offer is valid for three years from the date of purchase, or at least for the duration of the support and spare parts period for the device in question.

¹ Applies only to countries in the European Economic Area

² Depending on the device implementation

24 Declaration of Conformity

BSH Hausgeräte GmbH hereby declares that the appliance with Home Connect functionality complies with the essential requirements and other applicable provisions of Directive 2014/53/EU.

A detailed RED declaration of conformity can be found on the internet at www.bosch-home.com on the product page of your device in the additional documents.



2.4 GHz band (2400–2483.5 MHz): max. 100 mW 5 GHz band (5150–5350 MHz + 5470–5725 MHz): max. 150 mW

	BE BG CZ DK DE EE	IE	el	ES
	FR HR IT	CY LI	LV	LT LU HU
	MT NL AT PL PT RO	SI	SK	FI
	SE NO CH TR IS UK (NI)			

5 GHz WLAN (WiFi): For indoor use only.

ALGAMD	MEMK	RS	UK	UA
--------	------	----	----	----

5 GHz WLAN (WiFi): For indoor use only.



Thank you for buying a Bosch Home Appliance!

Register your new device on MyBosch now and profit directly from:

- **Expert tips & tricks for your appliance**
- **Warranty extension options**
- **Discounts for accessories & spare-parts**
- **Digital manual and all appliance data at hand**
- **Easy access to Bosch Home Appliances Service**

Free and easy registration – also on mobile phones:

www.bosch-home.com/welcome



Looking for help? You'll find it here.

Expert advice for your Bosch home appliances, help with problems or a repair from Bosch experts.

Find out everything about the many ways Bosch can support you:

www.bosch-home.com/service

Contact data of all countries are listed in the attached service directory.

BSH Hausgeräte GmbH

Carl-Wery-Straße 34

81739 München, GERMANY

www.bosch-home.com

A Bosch Company



9002024561 (050819)

nl