



BOSCH



Washing machine

WGG24405NL

[NL] User manual and
installation instructions

Refer to the Digital User's Guide for more information.



Index

1 Safety.....	4	7 Display	21
1.1 General instructions	4	8 Buttons	23
1.2 Destination of the device rate	4	9 Programs	25
1.3 Restriction of users	4	10 Accessories.....	29
1.4 Safe installation.....	5	11 Laundry.....	29
1.5 Safer use	7	11.1 Preparing the laundry.....	29
1.6 Safe cleaning and maintenance	9	12 Detergent and care ginger.....	30
2 Avoiding material damage	11	13 The Ministry at its core.....	30
3 Environmental protection and saving ring.....	12	13.1 Switching on the appliance	30
3.1 Disposing of the packaging	12	13.2 Set program	30
3.2 Saving on energy and resources	12	13.3 Adjust program settings	30
3.3 Energy Saving Mode	12	13.4 Loading the drum with laundry	31
4 Set up and connection	13	13.5 Inserting the dosing aid for liquid detergent	31
4.1 Unpacking the device	13	13.6 Using the dosing aid for liquid detergent	31
4.2 Package contents.....	13	13.7 Dosing detergent and care agent	32
4.3 Installation site requirements	13	13.8 Starting the program ...	32
4.4 Removing transport locks	14	13.9 Soaking laundry	32
4.5 Connecting the device	15	13.10 Adding laundry	32
4.6 Adjusting the device	16	13.11 Program cancel.....	32
4.7 Connecting the appliance electrically.....	17	13.12 Taking out the laundry	33
5 Getting to know your device.....	18	13.13 Switching off the appliance	33
5.1 Device	18	14 Child Lock	33
5.2 Detergent drawer	19	14.1 Activating child lock	33
5.3 Control panel.....	19	14.2 Deactivating the child lock.....	33
6 Before using for the first time	20	15 Basic Settings	33
6.1 Starting a wash cycle without laundry.....	20		

16	Cleaning and maintenance	33
16.1	Cleaning the drum	34
16.2	Cleaning the detergent drawer.....	34
16.3	Cleaning the drain pump.....	35
17	Troubleshooting	38
17.1	Emergency release.....	47
18	Transporting, Storing and disposal.....	47
18.1	Disassembling the device	47
18.2	Installing transport locks	47
18.3	Restarting the appliance	47
18.4	Disposal of your old device	48
19	Customer Service.....	48
19.1	Product number (E no.) and production number (FD)	49
20	Consumption values	50
21	Technical data.....	51



1 Safety

Observe the following safety instructions.

1.1 General instructions



†Please read this manual carefully.

†Keep the operating instructions and product information for future reference.
for use or for subsequent owners.

†Do not connect the device in case of transport damage.

1.2 Destination of the device

Only use the device:

†to wash machine-safe textiles and wool by hand
wash care label.

†with tap water and commercially available washing machine
detergents and maintenance products.

†for domestic use and in enclosed spaces within the
sly environment.

†to an altitude of 4000 m above sea level.

1.3 Restriction of users

This appliance can be used by children aged from 8 years and above and persons with reduced physical, sensory or mental capabilities or lack of experience and/or knowledge if they have been given supervision or instruction concerning use of the appliance in a safe way and understand the resulting hazards. understood. Children must not play with the appliance.

Cleaning and user maintenance shall not be made by children unless they are supervised.

Make sure that children up to 3 years old and pets cannot reach the device.

1.4 Secure installation

Observe the safety regulations when installing the device.

⚠ WARNING – Risk of electric shock! Improper installations are dangerous.

- ▶ Connect and operate the device only in accordance with the information on the type plate.
- ▶ Only connect the device to a mains supply with alternating current via a properly installed earthing socket.

- ▶ The protective earth system of the electrical house installation must be installed in accordance with the electrical engineering regulations. The installation must have a sufficiently large conductor diameter.

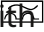
- ▶ When using an earth leakage circuit breaker, only use a type marked with .
- ▶ Never power the device via an external switching device, e.g. a time switch or remote control.
- ▶ When the device is installed, the mains plug of the mains connection cable must be freely accessible or, if free access is not possible, an all-pole disconnecting device must be installed in the permanently installed electrical system in accordance with the installation instructions.
- ▶ When setting up the device, make sure that the power cord is not pinched or damaged.
Damaged power cord insulation is dangerous.
- ▶ Never bring the connecting cable into contact with hot appliance parts or heat sources.
- ▶ Never bring the power cable into contact with sharp points or edges.
- ▶ Never kink, pinch or alter the power cord.

⚠ WARNING – Risk of fire!

Using an extended power cord and unauthorized adapters is dangerous.

- ▶ Do not use extension cords or multiple sockets.

- ▶ If the power cord is too short, contact customer service.
- ▶ Only use adapters approved by the manufacturer.

⚠ WARNING – Risk of injury!

The heavy weight of the device can cause injuries when lifted.

- ▶ Do not lift the device alone.

If this appliance is installed incorrectly in a washer-dryer column, the installed appliance may fall.

- ▶ Stack the dryer on top of a washing machine only with the dryer manufacturer's connection kit. No other method of installation is allowed.
- ▶ Do not install the appliance in a washer-dryer column if the dryer manufacturer does not offer a suitable connection set.
- ▶ Do not install appliances from different manufacturers and with different depths and widths in a washer-dryer column.
- ▶ Do not set up a washer-dryer column on a platform, the devices can tilt.

⚠ WARNING – Risk of suffocation!

Children can pull packing material over their head and become entangled and suffocate.

- ▶ Keep packaging material away from children.
- ▶ Do not let children play with packaging material.

⚠ CAUTION – Risk of injury!

The device may vibrate or move during operation.

- ▶ Set up the device on a clean, flat and solid surface.
- ▶ Level the appliance using the appliance feet and a spirit level.

There is a tripping hazard with incorrectly laid hoses and mains connection cables.

- ▶ Lay the hoses and connection cables in such a way that they cannot be tripped over.

If the appliance is moved by protruding parts, such as the loading door, the parts can break off.

- ▶ Do not move the appliance by protruding parts.

⚠ CAUTION – Risk of cutting!

Sharp edges on the device can cause cuts if touched.

- ▶ Do not touch the device on sharp edges.
- ▶ Use protective gloves when installing and transporting the device.

1.5 Safer use

⚠ WARNING – Risk of electric shock!

A damaged appliance or power cord is dangerous.

- ▶ Never use a damaged device.
- ▶ Never pull on the power cord to disconnect the device from the power supply. Always pull the plug on the power cord.
- ▶ If the appliance or the mains cable is damaged, immediately unplug the mains cable from the socket or switch off the fuse in the fuse box and close the tap.
- ▶ Contact customer service. *Page 48* Penetrating moisture can cause an electric shock.
- ▶ Only use the device in closed rooms.
- ▶ Never expose the device to excessive heat and humidity.
- ▶ Do not use a steam cleaner, pressure washer, hoses or nozzles to clean the appliance.

⚠ WARNING – Risk of health hazard! Children can lock themselves in the appliance and endanger their lives.

- ▶ Do not install the appliance behind a door that blocks or prevents the opening of the appliance door.

- ▶ In the case of discarded appliances, remove the mains plug from the socket, then cut the mains cable and damage the lock of the appliance door so that the appliance door no longer closes.

⚠ WARNING – Risk of suffocation!

Children can inhale or swallow small parts and choke.

- ▶ Keep small parts away from children.
- ▶ Do not allow children to play with small parts.

⚠ WARNING – Risk of poisoning!

Detergents and care products can lead to poisoning if ingested.

- ▶ In case of accidental ingestion, seek medical advice.
- ▶ Keep detergents and care products out of the reach of children.

⚠ WARNING – Risk of explosion!

If laundry has been pretreated with cleaning agents containing solvents, this can lead to an explosion in the appliance.

- ▶ Rinse pre-treated laundry thoroughly with water before washing.

⚠ CAUTION – Risk of injury!

The cover plate may break when climbing or clambering on the device.

- ▶ Do not climb or clamber on the device.
The appliance may tip over when sitting or leaning on the open door.
- ▶ Do not sit or lean on the appliance door.
- ▶ Do not place any objects on the appliance door.
Reaching into the rotating drum can cause injury to hands.

- ▶ Wait for the drum to come to a complete stop before reaching inside the drum with your hand.

⚠ CAUTION – Risk of burns!

The soap gets hot when washing at high temperatures.

- ▶ Do not touch the hot soapy water.

⚠ CAUTION – Risk of chemical burns! When opening the detergent drawer, detergent and care products may splash out of the appliance. Contact with eyes or skin may cause irritation.

- ▶ In case of contact with detergents or care products, rinse eyes or skin thoroughly with clean water.
- ▶ In case of accidental ingestion, seek medical advice.
- ▶ Keep detergents and care products out of the reach of children.

1.6 Safe cleaning and maintenance

Observe the safety instructions when cleaning and maintaining the device.

⚠ WARNING – Risk of electric shock! Improper repairs are dangerous.

- ▶ Only qualified personnel may carry out repairs on the device.
- ▶ Only original spare parts may be used for repair of the device.
- ▶ If the power cord of this appliance is damaged, it must be replaced by the manufacturer, its service agent or a similarly qualified person in order to avoid a hazard. Penetrating moisture can cause a shock.
- ▶ Do not use a steam cleaner, pressure washer, hoses or nozzles to clean the appliance.

⚠ WARNING – Risk of injury!

The use of non-original spare parts and non-original accessories is dangerous.

- ▶ Only use original spare parts and accessories from the manufacturer.

 **WARNING – Risk of poisoning!**

Toxic fumes can be generated when cleaning agents containing solvents are used.

▶ Do not use solvent-based cleaning agents.

2 Material damage avoid

Follow this instruction to avoid material damage and damage to the device.

PAY ATTENTION!

Incorrect dosage of fabric softeners, detergents, care products and cleaning agents can affect the functioning of the appliance.

- ▶ Follow the manufacturer's dosing recommendations.

Exceeding the maximum load quantity affects the operation of the appliance.

- ▶ Observe and do not exceed the maximum load for each programme.

→ *"Programs", Page 25*

The device is secured for transport with transport locks. Transport locks that have not been removed can lead to material damage and damage to the device.

- ▶ Before commissioning, remove and store all transport locks completely.

- ▶ Before every transport, install all transport locks completely to avoid transport damage.

Improper connection of the water inlet hose can lead to material damage.

- ▶ Tighten the screw connections on the water supply hand-tight.
- ▶ It is best to connect the water inlet hose directly to the water tap without additional connecting elements such as adapter, extension, valve or the like.
- ▶ Make sure that the valve housing of the water inlet hose is installed without contact with the environment and that it is not exposed to external forces.

- ▶ Make sure that the internal diameter of the water tap is at least 17 mm.
- ▶ Make sure that the thread length on the connection to the water tap is at least 10 mm.

Water pressure that is too low or too high can interfere with the appliance function.

- ▶ Make sure that the water pressure on the water supply system is at least 100 kPa (1 bar) and at most 1000 kPa (10 bar).
- ▶ If the water pressure exceeds the specified maximum value, a pressure reducing valve must be installed between the drinking water connection and the hose set of the device.
- ▶ Do not connect the device to the mixer tap of a pressureless water heater or boiler.

Modified or damaged water hoses can lead to material damage and damage to the device.

- ▶ Never kink, pinch, modify or cut water hoses.
- ▶ Only use supplied water hoses or original spare hoses.

- ▶ Reuse never used water hoses.

Use with contaminated or too hot water can cause material damage and damage to the device.

- ▶ Only use the appliance with cold tap water.

Unsuitable cleaning agents can damage the surfaces of the device.

- ▶ Do not use sharp or abrasive cleaning agents.
- ▶ Do not use strongly alcoholic cleaning agents.
- ▶ Do not use hard scouring or dishwashing sponges.

- ▶ Clean the device only with water and a soft, damp cloth.
- ▶ Remove all detergent residues, spray mist or residues immediately upon contact with the appliance.

3 Environmental protection and savings

3.1 Disposal of the packaging

The packaging materials are environmentally friendly and can be reused.

- ▶ Dispose of the individual components separately according to type.

3.2 Energy- and resource-efficient

If you follow these directions, your device will use less power and water.

Use programs with low temperatures and longer washing times and use the maximum load capacity.

- aThe energy consumption and water consumption are the most efficient.

Detergent according to the degree of soiling of the laundry .

- aFor a light to normal degree of contamination, a small amount of detergent is sufficient. Follow the detergent manufacturer's dosing recommendations.

Reduce washing temperature for lightly and normally soiled laundry.

- aAt low temperatures, it consumes device less energy. For light to normal soiling, lower temperatures than those stated on the care label are also sufficient.

Set the maximum speed if the laundry is subsequently to be dried in the tumble dryer.

- aDryer laundry shortens the programme time during drying and reduces energy consumption. With a higher spin speed, the residual moisture in the laundry decreases and the spinning sound volume increases.

Wash laundry without prewash.

- aWashing with prewash extends program duration and increases energy and water consumption.

The device has automatic load matching.

- aThe automatic load matching ming optimally adapts the water consumption and program duration to the type of textile and the load capacity.

3.3 Energy Saving Mode

If you do not operate the device for a longer period of time, it automatically switches to energy-saving mode.

The energy saving mode is exited when you operate the device again.

4 Set up and connect

4.1 Unpacking device

PAY ATTENTION!

Objects that remain in the drum and that are not intended for use with the device can lead to material and device damage.

- ▶ Before use, remove all these items and the supplied accessories from the drum.

1. Completely remove packaging material and protection from the device.

→ *†Disposal of the packaging*", Page 12

2. Check the device for visible damage.

3. Open the appliance door.

→ *†The Ministry in Essence*", Page 30

4. Remove the accessories from the drum.

5. Close the appliance door.

4.2 Package contents

After unpacking, check all parts for transport damage and the completeness of the delivery.

PAY ATTENTION!

Use with incomplete or defective accessories may impair the function of the device or cause material damage and damage to the device.

- ▶ Do not use the device with incomplete or defective accessories.
- ▶ Replace the accessories before using the device.
→ *†Accessories*", Page 29

Remark: The device has been checked at the factory for correct operation. Water stains may remain in the device. The stains disappear after the first wash.

The delivery consists of: †

Washing machine

†Accompanying documents †

Transport protections

→ *†Remove transport locks*", page 14

†cover caps

†Water supply hose

→ *†Connecting the water inlet hose*", page 15

4.3 Installation site requirements

 **WARNING**

Risk of electric shock!

The device contains live parts.

Touching live parts is dangerous.

- ▶ Do not use the appliance without a cover.

 **WARNING**

Risk of injury!

When used on a plinth, the device can tip over.

- ▶ The device feet for commissioning on a plinth must be absolutely with the fixings
→ *Page 29* from the manufacturer.

PAY ATTENTION!

Freezing residual water in the device can damage the device.

- ▶ Do not place and use the device in frost-sensitive places or outdoors.

NLSet up and connect

If the device is tilted more than 40°, residual water can run out of the device and cause material damage.

- ▶ Carefully tilt the device.
- ▶ Transport the device upright.

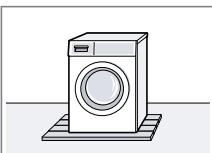
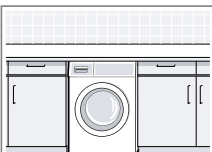
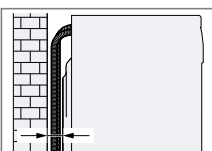
installation site	Requirements
<p>Plinth</p> 	<p>The device with locking lips → Page 29 confirm.</p>
<p>Floor with wooden beams</p> 	<p>Place the device guess at a resistant wooden plate (thick-too minimal 30mm) which screwed to the floor.</p>
<p>kitchen</p> 	<p>The device al-borrow under a continuous work place sheet, that fixed with the adjacent cabinet is connected Pine tree. Required niche width: 60 cm.</p>
<p>on a wall</p> 	<p>no snakes between wall and clamping device man.</p>

4.4 Removing transport locks

The device is secured for transport with transport locks at the rear of the device.

Remark:Keep the screws of the transport locks and the sleeves for later transport
→ Page 47†

- 1.Pull the hoses out of the holders.

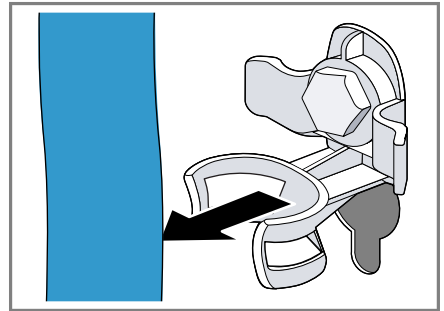

- 2.Loosen and remove all bolts of the 4 transport locks with a SW13 open-end wrench ①
②†

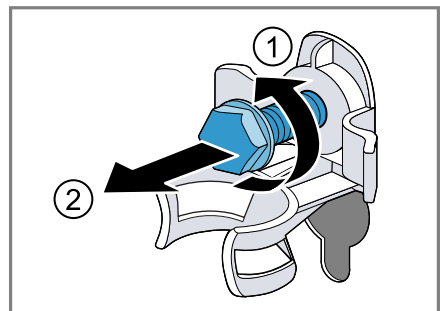

3.Remove the mains connection cable from the holder.

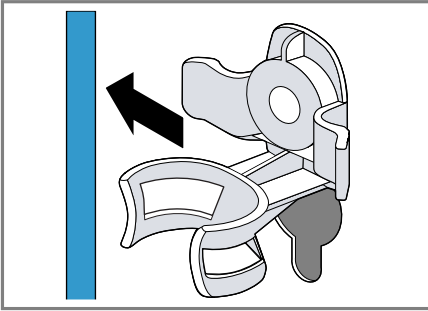

4.Remove the 4 sleeves.

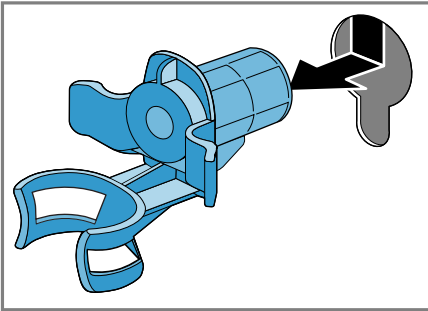

5.Install the 4 cover caps.

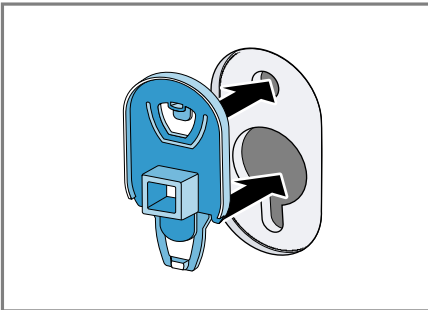

6.Push the 4 cover caps down.

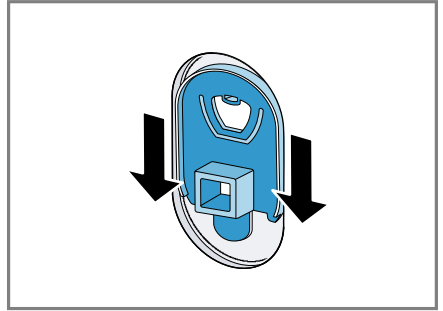

4.5 Connecting the device

Connect water supply hose

1.Connect the water supply hose to the appliance.

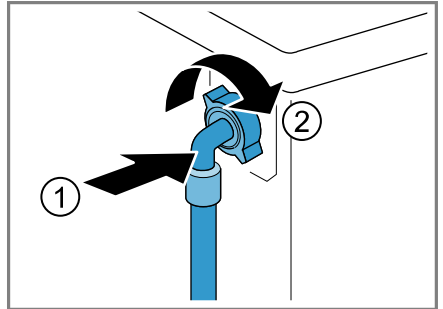

2.Connect the water inlet hose to the tap (26.4 mm = 3/4").

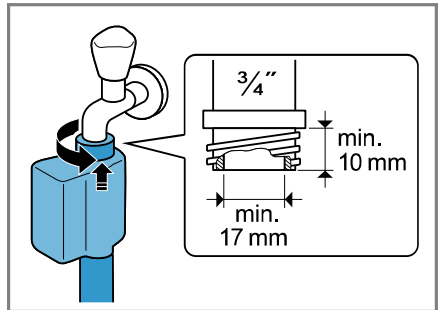

NLSet up and connect

3. Open the tap carefully and check that the connections are tight.

Connection types for water drainage

The information will help you to connect this appliance to the water outlet.

PAY ATTENTION!

When draining, the water drain hose is under pressure and can come loose from the installed connection position.

- ▶ Secure the water drain hose against unintentional disconnection.

Remark: Observe the pumping heights.

The maximum pumping height bed

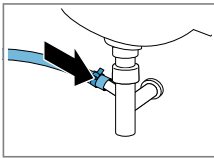

The connection position tie with a hose clamp (24-40 mm) bore gene.

washbasin

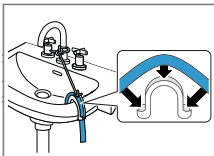

the water feeding hose with a bend → Page 29 fixate and gene.

plastic stand pipe with rubber run muff or a floor drain

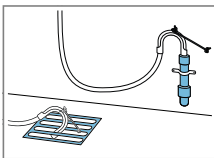

the water feeding hose with a bend → Page 29 fixate and gene.

4.6 Adjusting the device

To reduce noises and vibrations and to prevent the device from walking, place the device horizontally.

1. Loosen the lock nuts with a SW17 open-end wrench.

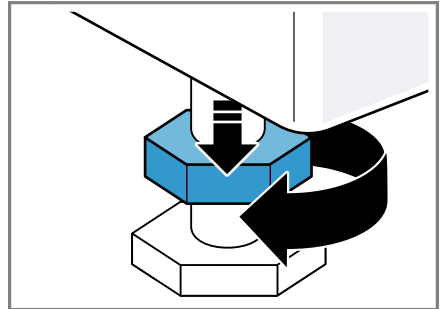

2. To adjust the appliance, turn the appliance feet. Check the horizontal adjustment of the appliance with a spirit level.

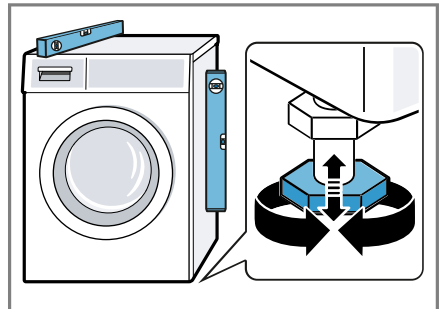

All appliance feet must be firmly planted on the floor.

3. Tighten the lock nuts against the housing with an open-end wrench SW17 hand-tight.

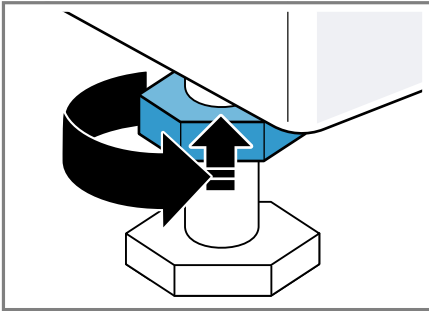

Hold the appliance foot while doing so and do not adjust the height.

4.7 Connecting the appliance electrically

Remark: Your home electrical installation for this appliance must comply with local legal and safety regulations and must include an earth leakage circuit breaker.

1. Insert the mains plug of the mains cable of the device into a socket in the vicinity of the device.

The connection data of the device can be found in the technical data
→ *Page 51†*

2. Check the mains plug for tightness.

5 Getting to know your device

5.1 Device

Here you will find an overview of the components of your device.

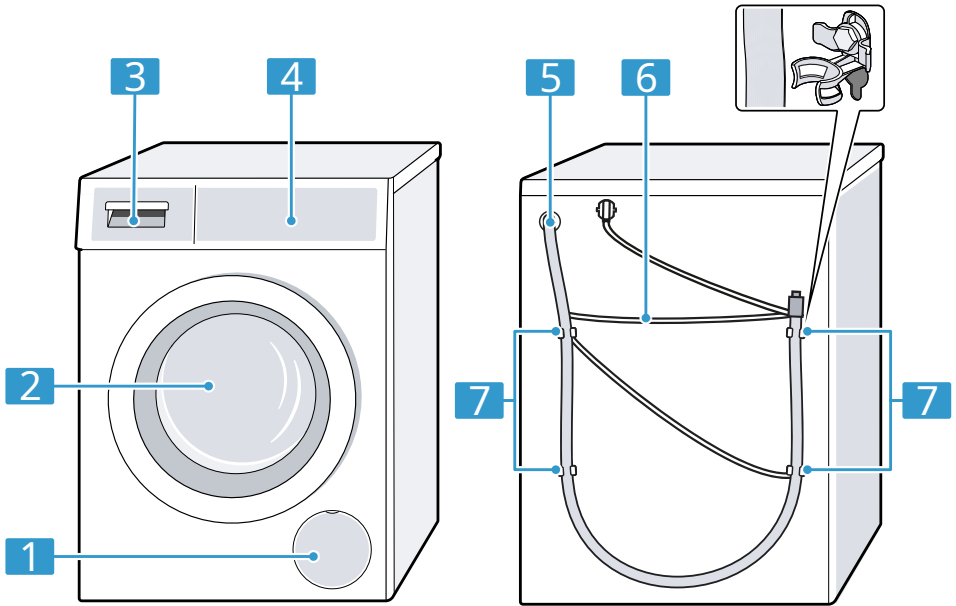

Depending on the device type, details in the picture may differ, e.g. the color and the form.

- | | |
|----------|---|
| 1 | Service valve/pump
→ <i>Page 35</i> |
| 2 | Door |
| 3 | Detergent drawer → <i>Page 19</i> |
| 4 | Control panel
→ <i>Page 19</i> |
| 5 | Water drains sign
→ <i>Page 16</i> |
| 6 | Mains connection cable → <i>Page 17</i> |

- | | |
|----------|---|
| 7 | Transport protections
→ <i>Page 14</i> |
|----------|---|

5.2 Detergent drawer

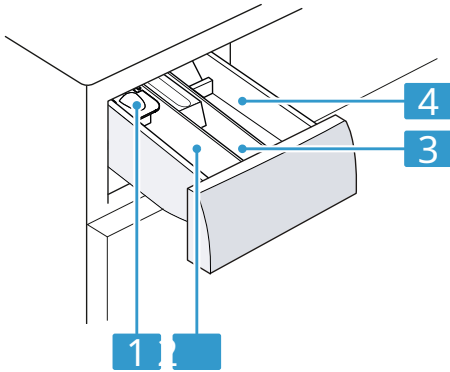

1 Dosing aid for liquid detergent
→ *†Insert the dosing aid for liquid detergent*,
Page 31

2 Detergent dispenser II:
†Detergent for the main
used to be,
†softener
†Bleach
†Stain salt

3 Compartment :⊗
†fabric softener
†Liquid starch
†Impregnation agent

4 Detergent dispenser I:
†Detergent for the pre-
used to be
†Hygiene detergent

5.3 Control panel

You can set all functions of your device and obtain information about the operating status via the control panel.

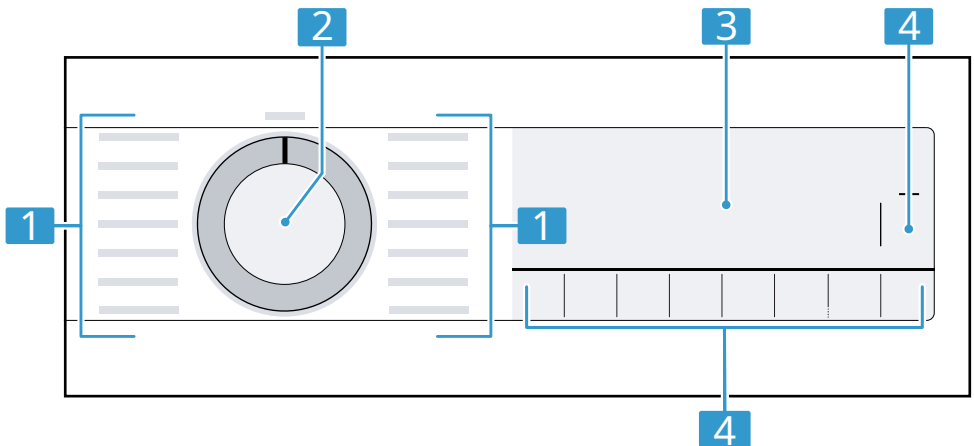

1 Programs → *Page 25*

2 programmakiez er
→ *Page 30*

3 This play → *Page 21*

4 knöpen → *Page 23*

6 Before first use

Prepare the device for use.

6.1 Starting a wash cycle without laundry

Your device has been thoroughly checked before leaving the factory. To remove any residual water, wash without any laundry the first time.

1. Turn the program selector on Cleaning the drum to make.
2. Close the door.
3. Pull out the detergent drawer.
4. Approx. Pour 1 liter of tap water into compartment II.

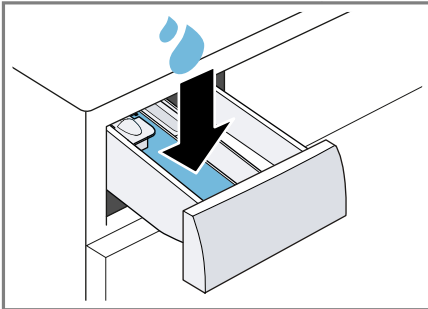

5. Fill powder detergent into compartment II.

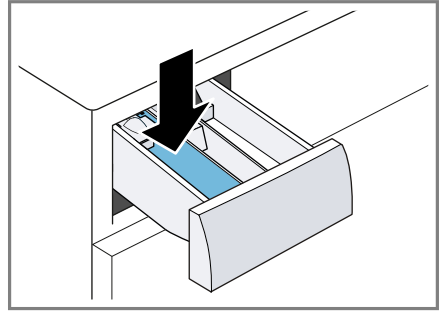

To avoid foaming, use only half the amount recommended by the detergent manufacturer for light soiling. Do not use wool or delicate detergent.

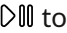
6. Slide the detergent drawer into the appliance.
7. Press Start/Reload  to start the program.
 - a The display shows the remaining program duration.
 - a After the program end, it shows display: "End" .
8. Start the first wash cycle or turn the program selector to Out to switch off the device.
→ *†The Ministry in Essence*,
Page 30

7 Display



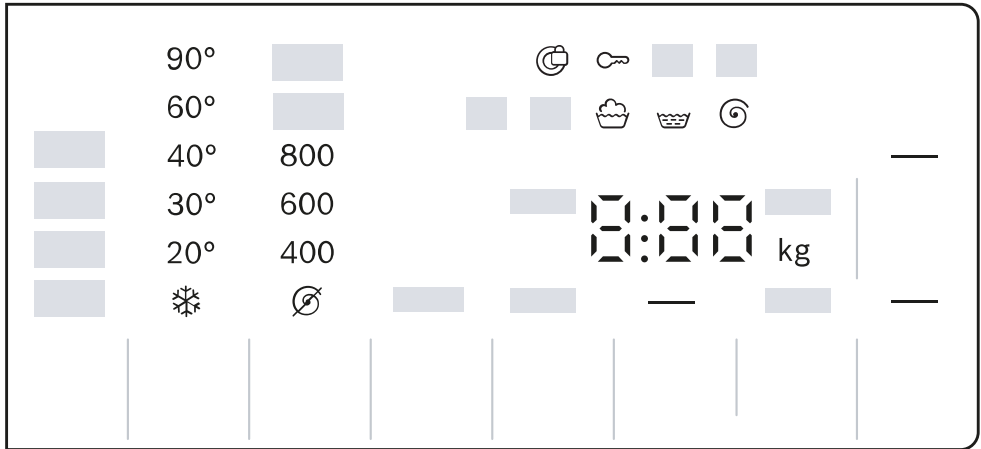











The display shows the current setting values, options or information texts.



Example display indication

Indication	name	More information
0:40 ₁	Program duration / remaining time of the program	Approximate expected program duration or time remaining in the program.
"10" / — ¹	Ready in time	→ <i>tKeys</i> ", Page 23
9.0 kg ₁	Recommended load	Maximum load amount for the set program in kg.
⌀ - 1400 Ⓢ	Spin speed tal	Spin speed set in rpm. → <i>tKeys</i> ", Page 23 ⌀ : without spinning, only draining
❄ - 90	Temperature	Set temperature in °C. → <i>tKeys</i> ", Page 23 ❄ (cold)
—	Start / Pause	Start, cancel or pause †lights up: the program is running and can be aborted or paused. †flashes: the program can be started or resumed.
⤵	prewash	program astatus



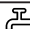

¹Example

Indication	name	More information
	To wash	Program status
	To rinse	Program status
	Centrifuge	Program status
end	Program end	Program status
	Child lock	†lights up: the childproof lock is activated. † flashes: the child lock is activated and the device was operated. → †Deactivate child lock", page 33
	Anti-crease function	The anti-crease function is activated. → †Buttons", Page 24
	prewash	The prewash is activated. → †Keys", Page 23
	Extra water and extra rinse	Wash with more water and a rinse cycle is activated. → †Keys", Page 23
	speedPerfect	Washing in a shorter time is activated. → †Keys", Page 23
	Blood	The stain type is activated.
	Grass	The stain type is activated.
	Red wine	The stain type is activated.
	Butter/salad oil	The stain type is activated.
	drum memory flour cleaning	flashing: drum dirty. Run the Drum Clean program for cleaning and maintenance of the drum and the lye container. → †Cleaning the drum", page 34
	Door	†lights up: the door is locked and can not be opened. †flashes: the door is not closed. †off: the door is unlocked and can be den open.
	Crane	†No water pressure. †The water pressure is too low.
E:35 / -10 ₁	Error	Error code, error indication, signal.

†Example

8 Keys

The selection of the program settings depends on the program set.



Knob	Choose	More information
Start/Reload 	†start †Cancel †pause	Start, cancel or pause program.
SpeedPerfect	†activate †deactivate	Activate or deactivate reduced program duration. Remark: The energy consumption is higher. The washing result is not affected by this.
Anti Stains	multiple se-reading	Choose the stain type. The temperature, drum movement and soaking time are adapted to the type of stain.
Ready in	up to 24 hours	Capture the program end. The program duration is already included in the set number of hours. After the program has started, the program duration is displayed.
temp. °C	 - 90 °C	Adjust the temperature in °C.
 (Spin)	 - 1400 rpm min	Adjust the spin speed or deactivate the spin. The selection drains the water and deactivates the spin cycle. The laundry remains wet in the drum.
 3 sec. (Children's security 3 sec.)	†activate †deactivate	→ †Child Lock", Page 33
prewash	†activate †deactivate	Activate or deactivate prewash, e.g. for washing heavily soiled laundry.
Extra rinse	†activate †deactivate	Wash with more water and activate or deactivate an extra rinse cycle. Recommended for particularly sensitive skin or in areas with very soft water.

Knob	Choice	More information
Anti wrinkle	†activate †deactivate	Activate or deactivate washing with less crease. To reduce creasing in the laundry, the spin process and spin speed are adjusted. The laundry is so damp after washing that it hangs out well on the clothesline.

9 Programs

Remark: The care labels on the laundry give you additional information on program selection.

Program	Description	max. belathing (kg)
Cotton	<p>Wash hard-wearing fabrics made of cotton, linen and blended fabrics.</p> <p>Also suitable as a shortened program for normally soiled laundry if you activate SpeedPerfect. Program setting: †max. 90 °C †max. 1400 rpm</p>	<p>9.0 5.0₁</p>
Eco 40-60	<p>Wash cotton, linen and blended fabrics.</p> <p>Remark: Textiles that can be washed at 40 °C to 60 °C according to the care symbol can be washed together. The wash result corresponds to the best possible wash result class and complies with legal regulations. The wash result corresponds to the best possible wash result class and complies with legal regulations.</p> <p>For this programme, the washing temperature is automatically adjusted depending on the load capacity in order to achieve optimum energy efficiency with the best possible washing result. The washing temperature cannot be changed. Program setting: Remark: The temperature is not adjustable in this program and is set automatically. †max. - °C †max. 1400 rpm</p>	9.0
wrinkle recovery loin	<p>Wash textiles made of synthetic and blended fabrics.</p> <p>Program setting: †max. 60 °C †max. 1200 rpm</p>	4.0
¹ SpeedPerfect	activated	
² Washing not possible		

Program	Description	max. belasting (kg)
Fast mix	Wash textiles made of cotton, linen, synthetic materials and blended fabrics. Suitable for lightly soiled laundry. Program setting: †max. 60 °C †max. 1400 rpm	4.0
Delicate silk	Wash delicate, washable textiles made of silk, viscose and synthetics. Use a detergent for delicates or silk. Remark:Wash particularly sensitive textiles or textiles with hooks, eyes or brackets in a laundry net. Program setting: †max. 40 °C †max. 800 rpm	2.0
 Wool	Wash by hand or machine washable textiles made of wool or with a high wool content. To avoid shrinkage of the laundry, the drum with textiles moves especially gently with long pauses. Use a wool detergent. Program setting: †max. 40 °C †max. 800 rpm	2.0
To rinse	Rinse with subsequent centrifugation and drain off the water. Program setting: max. 1400 rpm	†
Centrifuge/ Drain	Centrifuge and drain water. If you only want to drain the water, activate  . The laundry  is not spun. Program setting: max. 1400 rpm	†
Hygiene Plus	Wash hard-wearing fabrics made of cotton, linen and blended fabrics. Suitable for allergy sufferers and with high hygiene requirements. Remark:When the set temperature is reached, it remains constant throughout the washing process. Program setting: †max. 60 °C	6,5
¹ SpeedPerfect	activated	
² Washing not possible		

Program	Description	max. belathing (kg)
	†max. 1400 rpm	
Sport	Wash sports and leisure textiles made of synthetic, microfibre and fleece. Use a detergent for sports textiles. Do not use fabric softener. Tip:Wash heavily soiled laundry with the Easy-Care program. Program setting: †max. 40 °C †max. 800 rpm	2.0
blankets	Wash synthetic fiber filled pillows, duvets or fillings containing down. Wash large parts separately. Use a detergent for down or delicates. Dose sparingly. Do not use fabric softener. Remark:To avoid excessive foaming, before washing, roll the laundry together and remove the air from the laundry. Program setting: †max. 60 °C †max. 1200 rpm	2.5
Jeans/Dark <small>used to be</small>	Wash dark and colour-intensive textiles made of cotton and wrinkle-resistant textiles, e.g. jeans. Wash the laundry inside out. Use a liquid detergent. Program setting: †max. 40 °C †max. 1200 rpm	4.0
drum cleaning gene	Cleaning and maintenance of the drum. Use the program in the following cases: †before first use †with frequent washing with a washing temperature of 40°C and below †after a long absence Use a powder detergent or a detergent containing bleach.	† ²
¹ SpeedPerfect	activated	
² Washing not possible		

Program	Description	max. belathing (kg)
Super Short 15/30 min.	<p data-bbox="300 240 882 268">Halve the amount of detergent to avoid foaming.</p> <p data-bbox="300 300 860 352">Do not use fabric softener. Do not use wool, delicates or liquid detergents.</p> <p data-bbox="300 360 904 443">Remark:If you have not used a program with a temperature of 60 °C or higher for a long time, the drum cleaning indicator flashes as a reminder.</p> <p data-bbox="300 483 818 510">Wash cotton, synthetic and blended fabrics.</p> <p data-bbox="300 539 916 707">Short program for lightly soiled small items of laundry. The program duration is approx. 30 minutes. If you want to shorten the program duration to 15 minutes, activate SpeedPerfect . The maximum load capacity is reduced to 2.0 kg. Program setting:</p> <p data-bbox="300 735 437 762">†max. 40 °C</p> <p data-bbox="300 767 490 794">†max. 1200 rpm</p>	4.0
<p data-bbox="79 802 400 829">1SpeedPerfect activated</p> <p data-bbox="79 834 344 861">2Washing not possible</p>		

10 Accessories

Only use original accessories. These are adapted to the device.

Remark:Some accessories are available in other colours. Contact the

→ *"Customer Service", page 48*

	Usage	Order number
Extension water supply feeding hose	Cold water or Aquastop water inlet hose lengthen (2.50 m).	WMZ2381
Mounting brackets	Improve the firmness of the device.	WMZ2200
bend	Fix the water drain hose.	00655300
Insert units for liquid detergent	Dose liquid detergent.	00605740
Elevation	The device higher places so that it is easily filled and can be emptied.	WMZPW20W

11 Laundry

Remark:More information can be found in the digital operating instructions by scanning the QR code in the table of contents or on www.bosch-home.com.

11.1 Preparing the laundry

PAY ATTENTION!

Objects left in the laundry can damage the laundry and the drum.

- ▶ Before use, remove all objects from the pockets of the laundry.
- ▶ To protect your appliance and the laundry, prepare the laundry.

- Empty pockets
- Brush sand from all covers and pockets
- Close duvet covers and pillowcases
- Close zippers, Velcro fasteners, hooks and eyes
- Tie fabric belts, apron straps, etc. together, or use a laundry bag
- Tie together long drawstrings and cords with fixed ends in hoods or trousers
- Remove curtain rollers and lead laces or use a laundry net
- use a laundry net for small items of laundry, e.g. children's socks

NLDetergent and laundry care product

- some stubborn, dried-on stains can be removed by washing several times
- wash large and small items of laundry together
- do not rub in fresh stains, but dab off with soapy water
- Unfold and loosen the laundry or observe the program descriptions

12 Detergent and detergent care product

Comments

†More information can be found in the digital manual by scanning the QR code in the table of contents or at www.boschhome.com.

†Take the information regarding Safety → *Page 4* and Avoid material damage → *Page 11* heed.

Information from the manufacturer about use and dosage can be found on the packaging.

Comments

†with liquid detergents only tend to use self-flowing liquid detergents

†various liquid detergents don't mix

†detergent and fabric softener not to blend

†Not stored for too long and strongly in- using thickened products. †Use dyes in moderation

salt can affect stainless steel

†no decolorizing agent in the appliance ready to use

13 The Operation in es- sentie

Remark:More information can be found in the digital operating instructions by scanning the QR code in the table of contents or on www.bosch-home.com.

13.1 Switch on device

Required:The device is correctly set up and connected.

→ *†Setting up and connecting", Page 13*

- ▶ Set the program selector to a programme.

13.2 Set program

1.Turn the program selector and set it to the desired programme.

→ *†Programs", Page 25*

2.Adjust program settings if necessary → *Page 30*†

13.3 Adjust program settings

Required:A program is set.

→ *†Set program", page 30*

- ▶ Adjust the program settings.

→ *†Keys", Page 23*

Remark:The program settings are not saved permanently for the program.

13.4 Filling the drum with laundry

Remark: To avoid creasing, keep the maximum load of the

→ *tPrograms*", Page 25heed.

Required: The laundry is prepared.

→ *tLaundry*", Page 29

1. Open the door.

Make sure the drum is empty.

2. Place the laundry in the drum.

3. Close the door.

Make sure that no small items of laundry are caught in the door.

13.5 Inserting the liquid detergent dosing aid

When you order the dosing aid as an accessory, you must fit the dosing aid.

1. Pull out the detergent drawer.

2. Press the insert down and take out the detergent drawer.

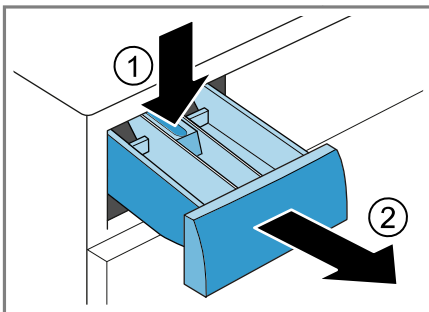

3. Place the dosing aid.

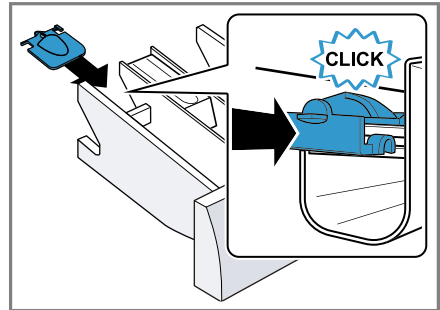

4. Insert the detergent drawer.

13.6 Using the dosing aid for liquid detergent know

You can use a dosing aid in the detergent drawer to dose liquid detergent.

1. Pull out the detergent drawer.

2. Push the dosing aid forward.

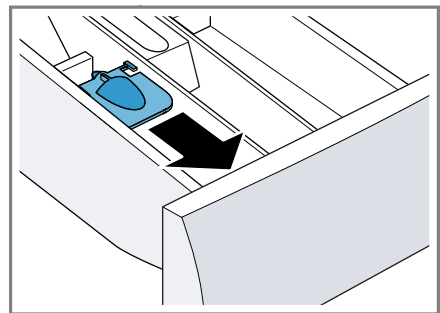

3. Fold the dosing aid downwards and click into place.

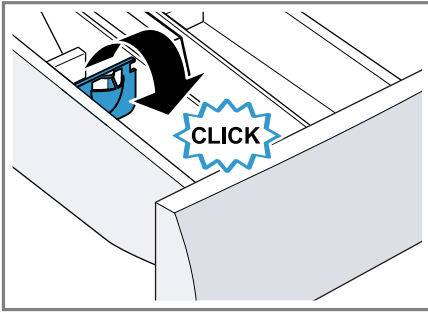

4. Slide in the detergent drawer.

13.7 Dosing detergent and care agent

Comments

† Use the dosing aid for liquid. Do not use gel-like detergents, washing powder, switched on prewash or ready-in time. † Keep the directions for washing agent and laundry care agent → Page 30at.

1. Pull out the detergent drawer.
2. Fill with detergent.
→ †Detergent drawer", Page 19
3. If desired, fill with a care product.
4. Slide the detergent drawer into the appliance.

13.8 Starting the program

Remark: If you want to change the time until the program end, first set the ready in time.

- ▶ onStart/Reload to press.
- a The drum rotates and find a load recognition up to 2 minutes after that it flows water in the app ready.

- a The display shows whether the program maduur or the ready in time displayed.
- a After the program end, it shows display: "End".

13.9 Soaking laundry

Remark: No additional detergent is needed. The soapy water is then used for washing.

1. Start the program.
2. To pause the program, after about 10 minutes, press Start/ Refill
3. To resume the program after the desired soaking time, press Start/ Reload

13.10 Adding laundry

1. Press Start/Reload The device pauses.
Remark: When far- appears, it is not possible to add laundry.
When goes out, it is possible to add laundry.
2. Open the appliance door.
3. Reload or remove the laundry.
4. Close the appliance door.
5. Press Start/Reload

13.11 Program Cancel

1. onStart/Reload to press.
2. Open the appliance door.
At high temperature and high water level, the appliance door remains locked for safety reasons.

– Start the program at a high temperature To rinse .

- Start the program at a high water levelCentrifuge or select a suitable program for draining.

→ †Programs", Page 25

3.Remove the laundry

→ Page 33†

13.12 Take out the laundry

- 1.Open the appliance door.
- 2.Remove the laundry.

13.13 Switch off device

- 1.Turn the program selector onOutto make.
- 2.Close the water tap.
- 3.Wipe the rubber sleeve dry and remove any foreign objects.

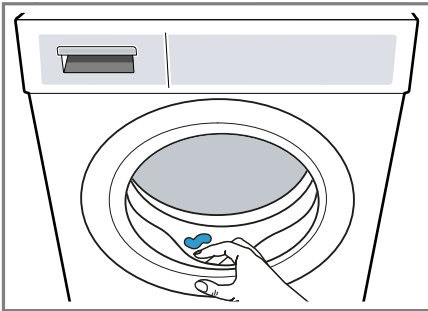

- 4.Leave the appliance door and detergent drawer open to allow the residual water to dry out.

14 Child Lock

Secure your device against unwanted operation via the controls.

14.1 Child lock i switch on

- ▶ Both keys  3 sec.approx. 3 sec-press condense.

aThe display shows to give.

 reflected

aThe controls are blocked.

aThe childproof lock remains in effect even after the switching on the device and activated in the event of a power failure.

14.2 Deactivate child lock

Required:To deactivate the child lock, the appliance must be switched on.

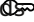
- ▶ Press both buttons for about 3 seconds 3 sec..

agoes out in the display  †

15 Basic Settings

You can configure the basic settings of your device according to your needs.

Remark:More information can be found in the digital operating instructions by scanning the QR code in the table of contents or on www.bosch-home.com.

16 Cleaning and care loves

Carefully clean and maintain your device to ensure that it continues to function properly for a long time.

Remark:More information can be found in the digital operating instructions by scanning the QR code in the table of contents or on www.bosch-home.com.

16.1 Cleaning the drum

⚠ CAREFULLY

Risk of injury!

Permanent washing at low temperatures and lack of ventilation of the appliance can damage the drum and cause injuries.

- ▶ Run a drum cleaning program regularly or wash at a temperature of at least 60°C.
- ▶ Leave the appliance to dry with the door and detergent drawer open after each use.
- ▶ The programCleaning the drum without laundry with powder detergent.

16.2 Cleaning the detergent drawer

- 1.Pull out the detergent drawer.
- 2.Press the insert down and remove the detergent drawer.

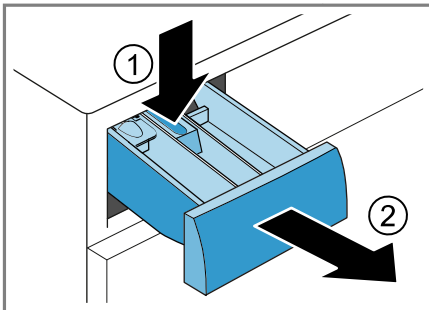

- 3.Pull out the insert from bottom to top.

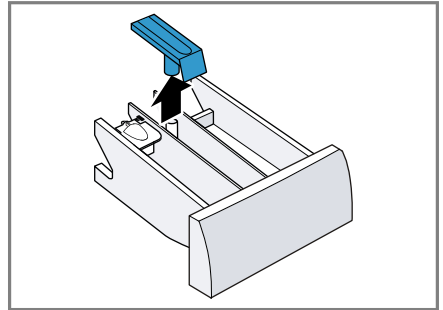

- 4.Clean and dry the detergent drawer and insert with water and a brush.

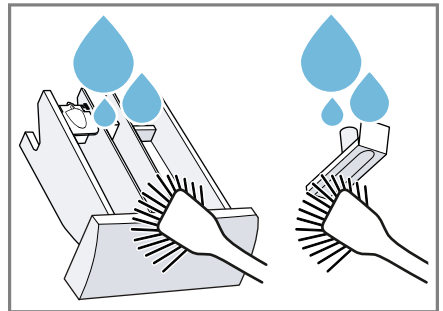

- 5.Place the insert and click into place.

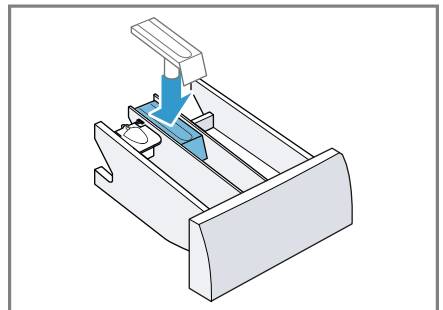

6. Clean the opening for the detergent drawer.

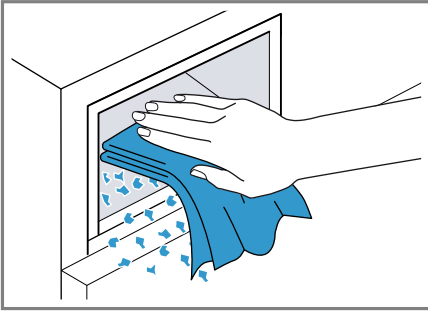

7. Slide the detergent drawer into the appliance.

16.3 Cleaning the drain pump

Clean the drain pump in the event of malfunctions, e.g. blockages or chattering.

Emptying the drain pump

1. Close the tap.
2. Turn off the device.
3. Disconnect the plug of the device from the mains.
4. Open and remove the service door.

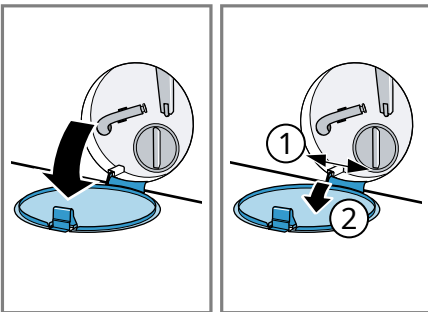

5. Place a sufficiently large container under the opening.

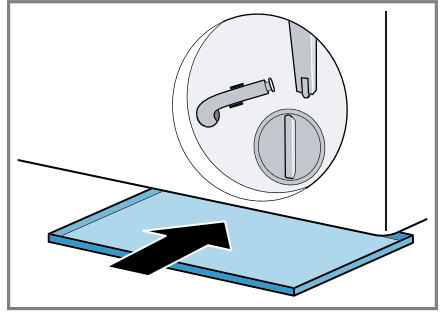

6. Remove the drain hose from the holder.

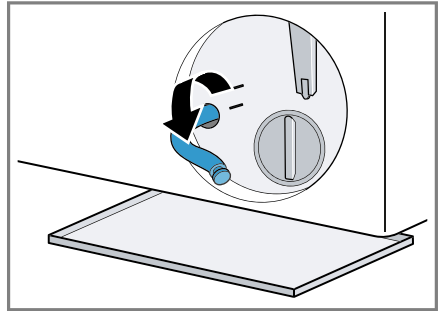

7. **⚠ CAUTION - Risk of burns!** The soap gets hot when washing at high temperatures.

- ▶ Do not touch the hot soapy water. Pull off the sealing cap to allow the wash water to flow into the collection container.

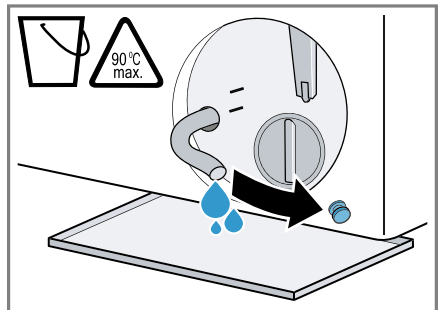

8. Press the stopper back on.

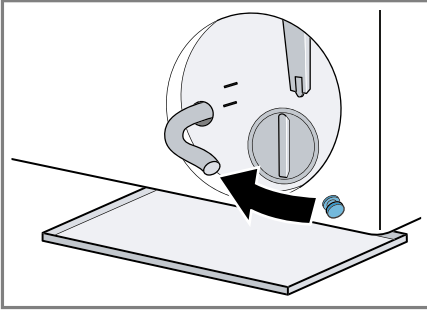

9. Clamp the drain hose in the holder.

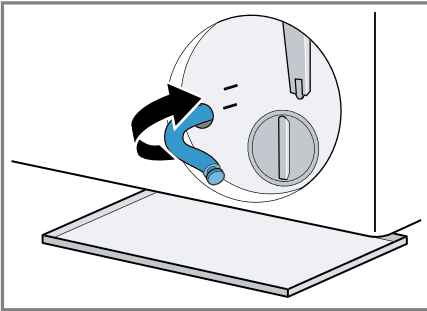

Cleaning the drain pump

Required: The drain pump is empty.
→ Page 35

1. As there may still be residual water in the pump, carefully unscrew the lid.

- † Large impurities can cause the filter element to get stuck in the pump housing. Loosen impurities and remove filter element.

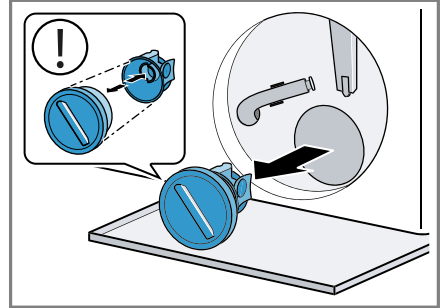

2. Clean the interior, screw thread of the pump cover and pump housing.

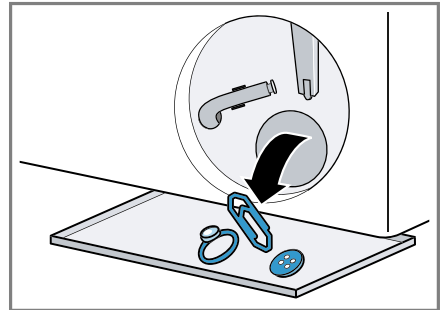

The pump cover consists of two components that can be disassembled for cleaning.

3. Verify that the pump impeller rotates easily.

4. Install the pump cover.

- † Check that the pump cover components are correctly assembled.

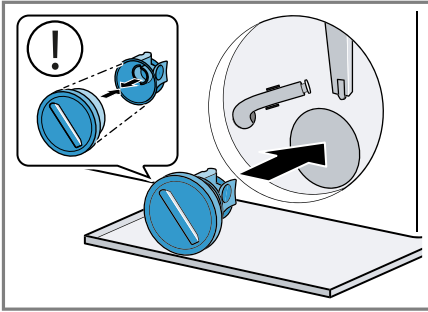

5. Tighten the pump cover as far as it will go.

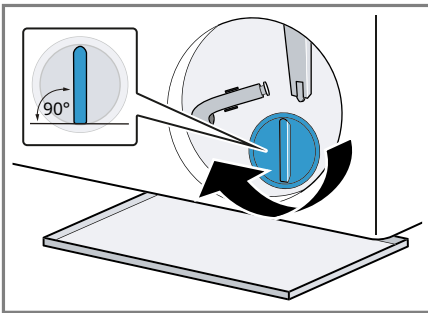

The pump cover handle must be vertical.

6. Install and close the service door.

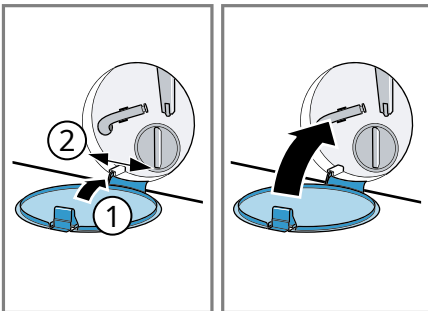

Before the next wash

To prevent unused detergent from flowing into the drain during the next wash, run the programme Drainoff after you have emptied the pump.

1. Open the tap.
2. Plug in the mains plug.
3. Switch on the device.
4. Pour one liter of water into compartment II.
5. Select a suitable program for draining.
→ *tPrograms*", Page 25

17 Troubleshooting

You can remedy minor faults on the device yourself. Before contacting customer service, please refer to the troubleshooting information. This way you avoid unnecessary costs.

WARNING



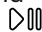

Risk of electric shock! Improper repairs are dangerous.

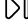

- ▶ Only qualified personnel may carry out repairs on the device.
- ▶ Only original spare parts may be used for repair of the device.
- ▶ If the power cord of this appliance is damaged, it must be replaced by the manufacturer, its service agent or a similarly qualified person in order to avoid a hazard.

Malfunction	Cause and Troubleshooting
The display is off and Start/Reload flashes. 	The energy saving mode is active. ▶ Press any button. The display lights up again.
"E:36 / -10"	Drain pipe or water drain hose is clogged. ▶ Clean the drain pipe and the water drain hose.
	Drain pipe or water drain hose is kinked or pinched. ▶ Make sure that the drain pipe and the water drain hose are not kinked or pinched.
	Drain pump is clogged. ▶ → <i>Cleaning the drain pump</i> , page 35
	Water drain hose is connected too high. ▶ Install the water drain hose at a maximum height of 1 meter.
	Pump cover not assembled correctly. ▶ Assemble the pump cover correctly.
	Detergent dosage is too high. ▶ Immediate measure: mix a tablespoon of fabric softener with 0.5 l of water and pour this mixture into the left compartment (not for outdoor, sportswear and down textiles). ▶ Reduce the amount of detergent for the next wash with an equal load.
	Unauthorized extension mounted on the water drain hose.

Malfunction	Cause and Troubleshooting
"E:36 / -10"	<p>▶ Remove unauthorized extensions from the water drain hose. → <i>tConnecting the device</i>, page 15</p> <hr/> <p>Pump cover is not fully screwed in.</p> <p>▶ Make sure that the pump cover is screwed into the device as far as it will go. The pump cover handle must be vertical.</p>
"E:60 / -2B"	<p>The imbalance detection system has interrupted the spin cycle due to uneven distribution of the laundry.</p> <p>▶ Redistribute the laundry in the drum.</p> <p>Remark:If possible, place large and small items of laundry together in the drum. Different sized laundry is more evenly distributed during the spin cycle.</p>
"E:30 / -10" and/or 	<p>Water pressure is low. No solution possible.</p> <hr/> <p>The strainers in the water supply are clogged.</p> <p>▶ Clean the strainers in the water supply.</p> <hr/> <p>Water tap is closed.</p> <p>▶ Open the water tap.</p> <hr/> <p>Water supply hose is kinked or pinched.</p> <p>▶ Make sure that the water supply hose is not kinked or pinched.</p> <hr/> <p>Water level measuring system defective.</p> <p>Remark:With the error message, the device starts a draining procedure.</p> <ol style="list-style-type: none"> 1.First wait for approx. 5 minutes until the pump-down procedure has ended. 2.To reset the error message, turn off the device. 3.Turn the device back on. 4.If the error message is displayed again, contact customer service. → <i>tCustomer Service</i>, page 48
: flashes.	<p>The Voltage Control System detects an impermissible voltage drop.</p> <p>▶ No solution possible.</p> <p>Remark:When the supply voltage has stabilized, the program continues normally.</p>

Malfunction	Cause and Troubleshooting
• flashes.	Undervoltage can cause a program extension. No solution possible.
⊙ burns.	Temperature is too high. ▶ Wait for the temperature to drop. ▶ → <i>!program cancel</i> ", Page 32
	Water level is too high. ▶ Select a suitable program for draining. → <i>!Programs</i> ", Page 25
⊙ flashes.	Door is not closed. 1.Close the door. 2.To start the program, press to fill ▷00†
	Laundry is wedged in the door. 1.Open the door again. 2.Remove trapped laundry. 3.Close the door. 4.To start the program, press to fill ▷00†
All other error codes.	Malfunction ▶ Please contact customer service. → <i>!Customer Service</i> ", page 48
"E:30/-20"	Solenoid valve defective. ▶ Please contact customer service. → <i>!Customer Service</i> ", page 48
	Detergent dosage is too high. ▶ Reduce the amount of detergent for the next wash with an equal load.
	Additional water filled. ▶ Do not fill the device with additional water during operation.
Device not working.	Mains plug of the power cable is not plugged in. ▶ Connect the appliance to the mains.
	The fuse in the fuse box has tripped. ▶ Check the fuse in the meter box.
	Power supply has failed. ▶ Check whether the interior lighting or other appliances are working.

Malfunction	Cause and Troubleshooting
Program does not start.	Start/Reload  was not pressed. ► Press Start/Reload 
	Door is not closed. 1. Close the door. 2. To start the program, press to fill  Start/Additional
	Child lock is activated. ► → <i>“Deactivate child lock”, page 33</i>
	Ready inis activated. ► Check if Ready inis activated. → <i>“Keys”, Page 23</i>
	Laundry is wedged in the door. 1. Open the door again. 2. Remove trapped laundry. 3. Close the door. 4. To start the program, press to fill  Start/Additional
Door cannot be opened.	Temperature is too high. ► Wait for the temperature to drop. ► → <i>“program cancel”, Page 32</i>
	Water level is too high. ► Select a suitable program for draining. → <i>“Programs”, Page 25</i>
	Power cut. ► Open the door with the emergency release. → <i>“Emergency release”, page 47</i>
Washing water is not pumped out.	Drain pipe or water drain hose is clogged. ► Clean the drain pipe and the water drain hose.
	Drain pipe or water drain hose is kinked or pinched. ► Make sure that the drain pipe and the water drain hose are not kinked or pinched.
	Drain pump is clogged. ► → <i>“Cleaning the drain pump”, page 35</i>
	Water drain hose is connected too high. ► Install the water drain hose at a maximum height of 1 meter.
	Pump cover not assembled correctly. ► Assemble the pump cover correctly.

Malfunction	Cause and Troubleshooting
Washing water is not pumped out.	Detergent dosage is too high. <ul style="list-style-type: none"> ▶ Immediate measure: mix a tablespoon of fabric softener with 0.5 l of water and pour this mixture into the left compartment (not for outdoor, sportswear and down textiles). ▶ Reduce the amount of detergent for the next wash with an equal load.
	Unauthorized extension mounted on the water drain hose. <ul style="list-style-type: none"> ▶ Remove unauthorized extensions from the water drain hose. → <i>Connecting the device</i> , page 15
	Pump cover is not fully screwed in. <ul style="list-style-type: none"> ▶ Make sure that the pump cover is screwed into the device as far as it will go. The pump cover handle must be vertical.
No water flows into the device. The detergent was not washed in.	Start/Reload  was not pressed. <ul style="list-style-type: none"> ▶ Press Start/Reload 
	The strainers in the water supply are clogged. <ul style="list-style-type: none"> ▶ Clean the strainers in the water supply.
	Water tap is closed. <ul style="list-style-type: none"> ▶ Open the water tap.
Start several times with centrifugation.	The imbalance control system eliminates the imbalance by distributing the laundry several times. <ul style="list-style-type: none"> ▶ No error - no action required.
	Remark: When loading, place large and small items of laundry together in the drum. Different sized laundry is more evenly distributed during the spin cycle.
The program duration changes during the wash cycle.	The program sequence is electronically optimized. This may lead to changes in the program duration. <ul style="list-style-type: none"> ▶ No error - no action required.
	The imbalance control system eliminates the imbalance by distributing the laundry several times. <ul style="list-style-type: none"> ▶ No error - no action required.

Malfunction	Cause and Troubleshooting
The program duration changes during the wash cycle.	<p>Remark:When loading, place large and small items of laundry together in the drum. Different sized laundry is more evenly distributed during the spin cycle.</p> <hr/> <p>The foam control system provides an extra rinse if the foam is too high.</p> <ul style="list-style-type: none"> ▶ No error - no action required.
The water is not visible in the drum bar.	<p>The water is below visible range.</p> <ul style="list-style-type: none"> ▶ No error - no action required. ▶ Do not fill the device with additional water during operation.
Drum jerks after program start.	<p>The cause is an internal motor test.</p> <ul style="list-style-type: none"> ▶ No error - no action required.
In the compartment there is residual water.	<p>Insert in compartment hidden.</p> <ul style="list-style-type: none"> ▶ → <i>“Cleaning the detergent drawer”, Page 34</i>
Vibration and movement of the appliance during the spin run.	<p>The appliance is not leveled properly.</p> <ul style="list-style-type: none"> ▶ → <i>“Adjusting the device”, Page 16</i> <hr/> <p>Device feet are not fixed.</p> <ul style="list-style-type: none"> ▶ Secure the device feet. → <i>“Adjusting the device”, Page 16</i>
Drum is spinning, er no water flows into the appliance.	<p>Transport protections have not been removed.</p> <ul style="list-style-type: none"> ▶ → <i>“Remove transport locks”, page 14†</i> <hr/> <p>Load recognition is active.</p> <ul style="list-style-type: none"> ▶ No error, no action necessary. <p>Remark:The load detection can take up to 2 minutes.</p>
strong foam ming.	<p>Detergent dosage is too high.</p> <ul style="list-style-type: none"> ▶ Immediate measure: mix a tablespoon of fabric softener with 0.5 l of water and pour this mixture into the left compartment (not for outdoor, sportswear and down textiles). ▶ Reduce the amount of detergent for the next wash with an equal load.
High spin speed rental is not reached.	<p>Low spin speed is set.</p> <ul style="list-style-type: none"> ▶ Set a higher spin speed for the next wash. <hr/> <p>Anti wrinkleis activated.</p> <ul style="list-style-type: none"> ▶ Select a suitable program for the type of fabric.

Malfunction	Cause and Troubleshooting
High spin speed rental is not reached.	<p>Unbalance control system compensates for imbalance through reduced spin speed.</p> <p>▶ Redistribute the laundry in the drum.</p> <p>Remark:If possible, place large and small items of laundry together in the drum. Different sized laundry is more evenly distributed during the spin cycle.</p> <p>▶ Start the programCentrifuge .</p>
Program centrifugal run does not start.	<p>Drain pipe or water drain hose is clogged.</p> <p>▶ Clean the drain pipe and the water drain hose.</p> <hr/> <p>Drain pipe or water drain hose is kinked or pinched.</p> <p>▶ Make sure that the drain pipe and the water drain hose are not kinked or pinched.</p> <hr/> <p>The imbalance detection system has interrupted the spin cycle due to uneven distribution of the laundry.</p> <p>▶ Redistribute the laundry in the drum.</p> <p>Remark:If possible, place large and small items of laundry together in the drum. Different sized laundry is more evenly distributed during the spin cycle.</p> <p>▶ Start the programCentrifuge .</p>
fizzing, hissing loud.	<p>Water is flushed into the detergent drawer under pressure.</p> <p>▶ No error - normal operating noise.</p>
Loud noise during spin.	<p>The appliance is not leveled properly.</p> <p>▶ → <i>Adjusting the device", Page 16</i></p> <hr/> <p>Device feet are not fixed.</p> <p>▶ Secure the device feet. → <i>Adjusting the device", Page 16</i></p> <hr/> <p>Transport protections have not been removed.</p> <p>▶ → <i>Remove transport locks", page 14†</i></p>
Clapping, clattering in the pump.	<p>A foreign object has entered the pump.</p> <p>▶ → <i>Cleaning the drain pump", page 35</i></p>
Slurping, rhythmic suction sound.	<p>Pump is active, the water is being pumped out.</p> <p>▶ No error - normal operating noise.</p>

Malfunction	Cause and Troubleshooting
wrinkling.	Spin speed is too high. ▶ Set a lower spin speed for the next wash.
	The load quantity is too high. ▶ Reduce the load during the next wash.
	Unsuitable program set for the type of fabric. ▶ Select a suitable program for the type of fabric.
Detergent or detergent softer drips from the cuff and collects on the door or in the cuff fold.	Too much detergent/fabric softener in the detergent drawer. ▶ When dosing the liquid detergent and fabric softener, pay attention to the marking in the detergent drawer and do not dose above that.
	Low spin speed is set. ▶ Set a higher spin speed for the next wash. ▶ Start the programCentrifuge .
Spin result is not to satisfaction-ness. The laundry is too wet / too damp.	Anti wrinkleis activated. ▶ Select a suitable program for the type of fabric.
	Drain pipe or water drain hose is clogged. ▶ Clean the drain pipe and the water drain hose.
	Drain pipe or water drain hose is kinked or pinched. ▶ Make sure that the drain pipe and the water drain hose are not kinked or pinched.
	The imbalance detection system has interrupted the spin cycle due to uneven distribution of the laundry. ▶ Redistribute the laundry in the drum. Remark:If possible, place large and small items of laundry together in the drum. Different sized laundry is more evenly distributed during the spin cycle.
	▶ Start the programCentrifuge .
	Unbalance control system compensates for imbalance through reduced spin speed.
	▶ Redistribute the laundry in the drum.

Malfunction	Cause and Troubleshooting
Spin result is not to satisfaction-ness. The laundry is too wet / too damp.	<p>Remark:If possible, place large and small items of laundry together in the drum. Different sized laundry is more evenly distributed during the spin cycle.</p> <p>▶ Start the programCentrifuge .</p>
Detergent residue on the damp laundry.	<p>Detergents may contain water-insoluble substances, which deposit on the laundry.</p> <p>▶ Start the programTo rinse .</p>
Detergent residue on the dry laundry.	<p>Detergents may contain water-insoluble substances, which deposit on the laundry.</p> <p>▶ Brush the laundry after washing and drying.</p>
At the water supply feed hose is leaking water.	<p>The water inlet hose is not correctly / firmly connected.</p> <ol style="list-style-type: none"> 1.Connect the water supply hose correctly. → <i>tConnecting the water inlet hose", page 15</i> 2.Tighten the coupling properly.
Water is leaking from the water drain hose.	<p>Water drain hose is damaged.</p> <p>▶ Replace the damaged water drain hose.</p> <hr/> <p>Water drain hose is not connected correctly.</p> <p>▶ Connect the water drain hose correctly. → <i>tDrainage connection types", page 16</i></p>
Odor has formed in the appliance <small>Pine tree.</small>	<p>Humidity and detergent residue can encourage bacterial growth.</p> <p>▶ → <i>tCleaning the drum", page 34</i></p> <p>▶ When you are not using the appliance, leave the door and detergent drawer open to allow the residual water to dry out.</p>

17.1 Emergency release

unlock door

Required: The drain pump is empty.
→ *Page 35*

1. **ATTENTION!** Running water can lead to material damage.

- ▶ Do not open the door if water can be seen behind the glass.

Pull the emergency release downwards with the aid of a tool and release it.

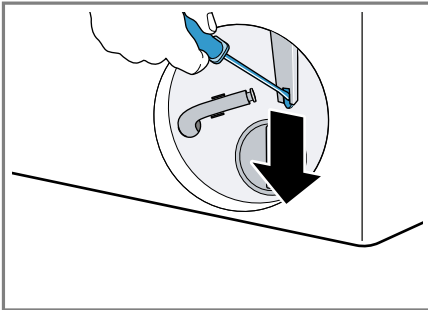

- a The door lock is unlocked.
2. Place the service door and click it into place.
3. Close the service door.

18 Transport, on-hit and drain

Here you will find an explanation of how to prepare the device for transport and storage. We also explain how to dispose of old appliances.

18.1 Disassembling the device

Remark: More information can be found in the digital usage by clue scanning v in the table and the QR code of contents or on www.bosch-home.com.

1. Close the tap.
2. Empty the water inlet hose.
3. Turn off the device.
4. Unplug the appliance from the mains.
5. Let the suds drain.
→ *Cleaning the drain pump*, page 35
6. Disassemble the hoses.

18.2 Installing transport locks

Secure the device before transport with the transport locks to avoid damage.

1. Remove the 4 cover caps using a screwdriver.

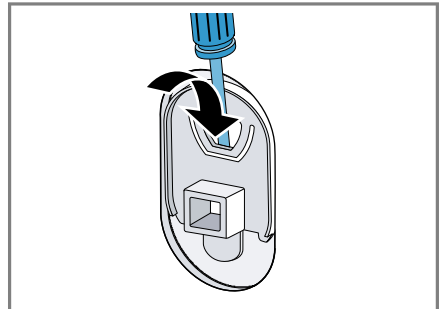

- Keep the cover caps.
2. Install the 4 transport locks. Keep the description
→ *Remove transport locks*, page 14 and proceed in reverse order.

18.3 Restarting the device

- ▶ For more information, see
→ *Setting up and connecting*, Page 13 and
→ *Before using for the first time*, Page 20†

18.4 Disposal of your old appliance

Environmentally friendly disposal means that valuable raw materials can be reused.

 **WARNING**
Risk of health hazard!

Children can lock themselves in the appliance and endanger their lives.

- ▶ Do not install the appliance behind a door that blocks or prevents the opening of the appliance door.
- ▶ In the case of discarded appliances, remove the mains plug from the socket, then cut the mains cable and damage the lock of the appliance door so that the appliance door no longer closes.

1. Unplug the power cord from the outlet.

2. Cut the power cord.

3. Dispose of the device in an environmentally friendly way.

You can obtain information about the current disposal methods from your dealer and your municipal or district council office.



This appliance is marked in accordance with the European Directive 2012/19/EU on waste electrical and electronic

chemical equipment (waste electrical and electronic equipment - WEEE). The Directive sets the framework for the take-back valid in the EU and processing of old appliances.

19 Customer Service

If you have any questions about use, if you are unable to remedy a malfunction of the device yourself or if the device needs to be repaired, please contact our service department. Original replacement parts that are relevant for the function in accordance with the respective Ecodesign Regulation can be obtained from our service department for a period of at least 10 years from the time the device is placed on the market within the European Economic Area.

Remark: Engaging the service within the framework of the manufacturer's warranty conditions is free of charge.

Detailed information about the warranty period and warranty conditions in your country can be obtained from our after-sales service, your dealer or on our website.

When contacting customer service, you will need the product number (E-Nr.) and the production number (FD) of the device.

The contact details of the after-sales service can be found in the supplied service list or on our website.

19.1 Product number (E-No.) and production number (FD)

The product number (E-Nr.) and the production number (FD) can be found on the type plate of the device.

The type plate is located depending on the model: †on the inside of the door. †on the inside of the bottom

holding valve.
†on the back of the device

honeycomb.

In order to quickly find your device data and the service telephone numbers, you can write down the data.

20 Consumption values

The following information is provided in accordance with the EU Ecodesign Regulation. The specified values for other programs as Eco 40-60 are only guide values and have been determined in accordance with the applicable standard EN60456.

Program	belathing (kg)	Program-maduur (h:min) ¹	energy-gibberish use (kWh/cycle) ¹	Water-far-usage (l/cycle) ¹	maxi-male temperature (°C) 5 min ¹	centrifuge revving number (t/min) ¹	Rest-moisture-half-at (%) ¹
Eco 40-60 ²	9.0	3:48	0.870	75.0	38	1351	50.00
Eco 40-60 ²	4.5	2:54	0.370	40.0	27	1351	49.00
Eco 40-60 ²	2.5	2:22	0.180	30.0	23	1351	52.00
Cotton 20°C	9.0	3:44	0.400	98.0	23	1400	50.00
Cotton 40 °C	9.0	3:44	1,290	98.0	44	1400	50.00
Cotton 60°C	9.0	3:44	1,750	98.0	60	1400	50.00
Cotton 40 °C + prewash	9.0	4:14	1,330	110.0	44	1400	50.00
wrinkle recovery lenght 40 °C	4.0	2:37	0.800	61.0	44	1200	30.00
Fast mix 40 °C	4.0	1:05	0.640	44.0	42	1400	53.00
 Wool 30 °C	2.0	0:41	0.300	48.0	29	800	26.00

¹Actual values may vary due to the influence of water pressure, hardness and inlet temperature, ambient temperature, type, amount and soiling of the laundry, detergent used, fluctuations in the power supply and selected additional functions deviate from the stated values.

²Test program in accordance with the EU Ecodesign Regulation and the EU energy call regulation with cold water (15°C).

21 Technical data

Device height	84.8 cm
Device width	59.8 cm
Device depth	59.0 cm
Device depth with closed door	63.6 cm
Device depth with open door	107.3 cm
Weight	73.5 kg ¹
Maximum load thing	9.0 kg
mains voltage	220-240V, 50-60 Hz
☞ Minimum input installation fuse	10 A
Rated power gene	2300 W
Recorded Ver- <small>to be allowed to</small>	†Off state: 0.15W †non-disabled caved in position: 0.50 W
water pressure	†At least: 100 kPa (1 bar) †Maximum: 1000 kPa (10 bar)
Length of the water supply feeding hose	150 cm
Length of the water drain hose	150 cm
Length of the mains connection cable	160 cm
†Depending on the device output ring	

You can find more information about your model on the Internet under <https://eprel.ec.europa.eu/>[†] This web address refers to the official EU product database EPREL. Then follow the instructions when looking for the model. The model identification consists of the slash character of the E-number (E-No.) on the type plate. Alternatively, you will also find the model identifier in the first line of the EU energy label.

¹Only applies to countries in the European Economic Area



BOSCH
HOME APPLIANCES
SERVICE

www.bosch-home.com/service

Contact data of all countries are listed in the attached service directory.

BSH Hausgeräte GmbH
Carl-Wery-Strasse 34
81739 Munich, GERMANY
www.bosch-home.com

A Bosch Company

* 9001610248*

9001610248†020228)

NL