

SIEMENS

Kühl- und Gefrierkombination

Réfrigérateur / Congélateur combiné

Combinazione frigorifero / congelatore

Fridge-freezer combination

KG..N..

the Gebrauchsanleitung
fr Manuel d'utilisation

it manual utente
NL User manual



Register your product on My Siemens and discover exclusive services and offers.

siemens-home.bsh-group.com/welcome

The future moving in.

Siemens Home Appliances

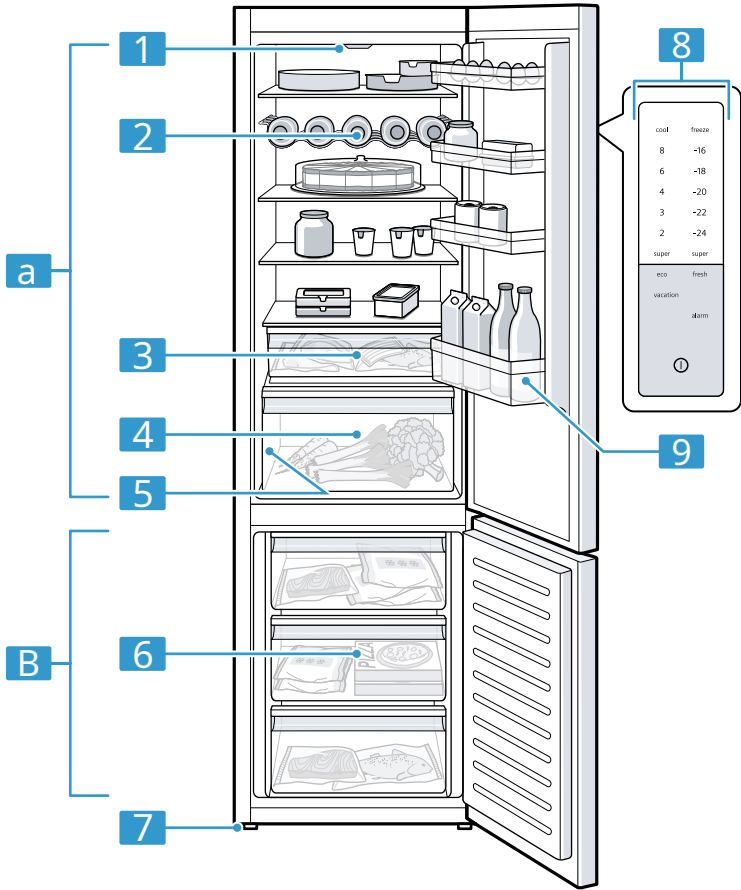

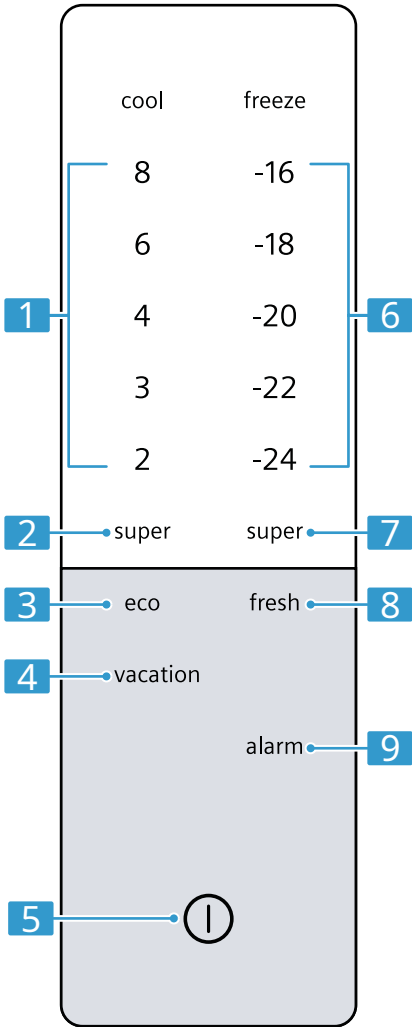

2

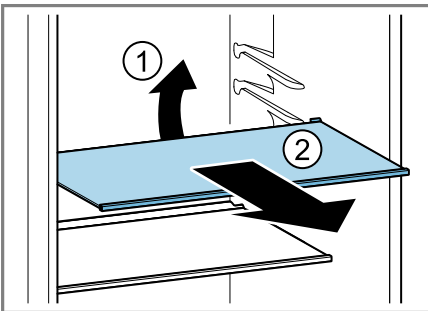

3

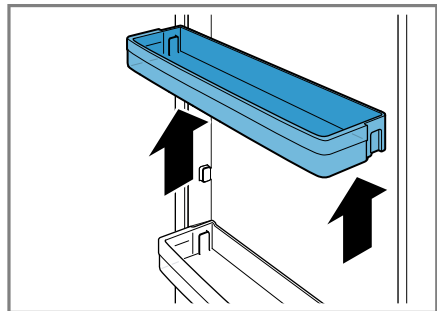

4

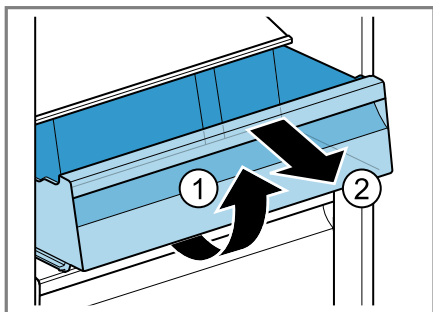

5

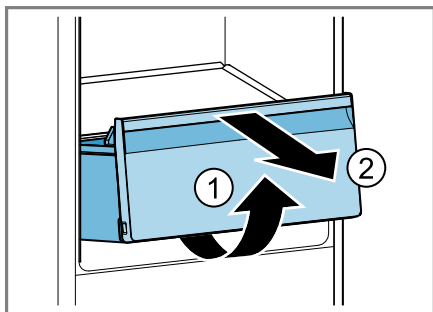

6

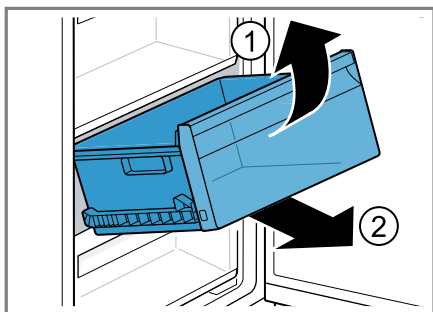

7

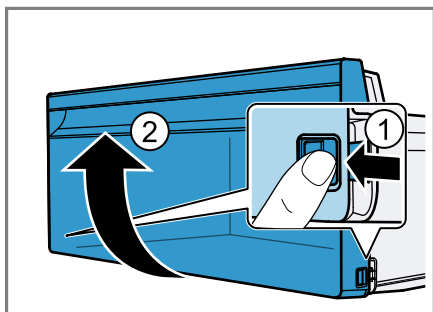

8

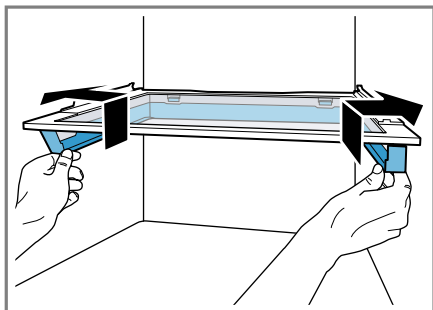

9

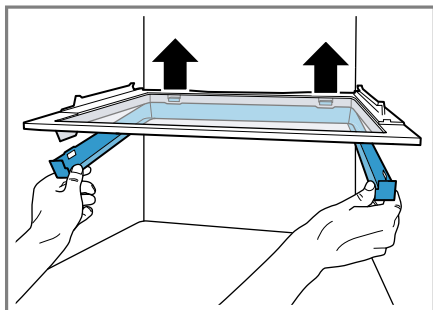

10

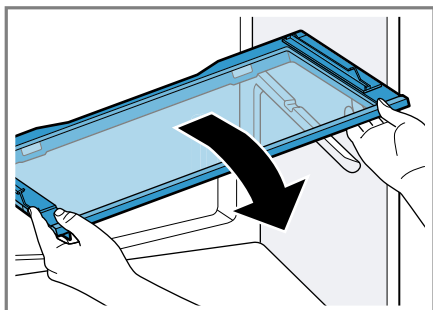

11

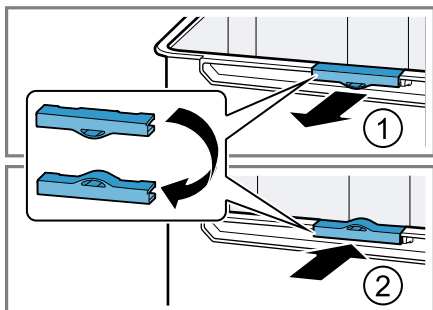

12

Table of contents

1 Safety.....	89	8 Additional functions	99
1.1 General notes	89	8.1 Super cooling	99
1.2 Destination of the device rate	89	8.2 Automatic Super Freeze	99
1.3 Restriction of users	89	8.3 Manual Super Freeze	100
1.4 Safer transportation	89	8.4 Vacation mode.....	100
1.5 Safe installation.....	90	8.5 Energy Saving Mode	101
1.6 Safe use.....	91	8.6 Fresh mode	101
1.7 Damaged device.....	93	8.7 Sabbath Mode	101
2 Preventing material damage	95	9 Alarm.....	101
3 Environmental protection and savings	95	9.1 Door alarm.....	101
3.1 Disposing of the packaging	95	9.2 Temperature alarm	102
3.2 Saving energy	95	10 Refrigerator compartment	102
4 Set up and connection	95	10.1 Tips for storing food in the refrigerator box	102
4.1 Scope of delivery	95	10.2 Cold zones in the refrigerator compartment ..	102
4.2 Criteria for the installation location ...	96	11 Freezer compartment	103
4.3 Mounting the device	96	11.1 Freezing capacity.....	103
4.4 Preparing the device for the first use	96	11.2 Using Freezer Compartment Volume Full	103
4.5 Connecting the device electrically.....	96	11.3 Tips for storing food in the freezer box	103
5 Getting to know your device.....	97	11.4 Tips for freezing fresh food	103
5.1 Device	97	11.5 Shelf life of frozen food at -18 °C	104
5.2 Control panel.....	97	11.6 Defrosting Methods for Frozen Goods	104
6 Equipment.....	97	12 Defrost.....	105
6.1 Shelf	97	12.1 Defrosting in the freezer compartment	105
6.2 Bottle rack	97	13 Cleaning and maintenance	105
6.3 Storage drawer.....	98	13.1 Preparing the device for cleaning	105
6.4 Fruit and vegetable drawer	98	13.2 Cleaning the appliance	105
6.5 Door racks.....	98	13.3 Removing parts	106
6.6 Accessories.....	98	13.4 Disassembling Device Components	106
7 The Ministry in Essentials.....	98		
7.1 Switching on the device.....	98		
7.2 Notes on use ...	99		
7.3 Switching off the machine.....	99		
7.4 Setting the temperature.....	99		

NL

14 Troubleshooting	107
14.1 Power failure.....	110
14.2 Performing the device self-test....	110
15 Storing and Disposing.....	110
15.1 Device not in use set	110
15.2 Disposal of your old device	111
16 After-sales service.....	111
16.1 Product number (E no.) and production number (FD)	112
17 Technical data.....	112



1 Safety

Observe the following safety instructions.

1.1 General instructions

s Read this manual carefully.

s Keep the operating instructions and product information for future reference or for subsequent owners.

s Do not connect the device in case of transport damage.

1.2 Destination of the device

Only use the device:

s for cooling and freezing food and for preparing ice cubes.

s for domestic use and in enclosed spaces within the domestic environment.

s to an altitude of 2000 m above sea level.

1.3 Restriction of users

This appliance can be used by children aged from 8 years and above and persons with reduced physical, sensory or mental capabilities or lack of experience and/or knowledge if they have been given supervision or instruction concerning use of the appliance in a safe way and understand the resulting hazards. Children must not play with the appliance.

Cleaning and user maintenance shall not be made by children unless they are supervised.

Children from 3 years old and under 8 years old are allowed to fill and empty the fridge/freezer.

1.4 Safer transport

 **WARNING – Risk of injury!**

The heavy weight of the device can cause injuries when lifted.

► Do not lift the device alone.

1.5 Secure installation

WARNING – Risk of electric shock!

Improper installations are dangerous.

- ▶ Only connect and use the device in accordance with the information on the type plate.
- ▶ Only connect the device to a mains supply with alternating current via a properly installed earthing socket.

- ▶ The protective earth system of the electrical house installation must be installed in accordance with the electrical engineering regulations.
- ▶ Never power the device via an external switching device, e.g. a time switch or remote control.
- ▶ When the device is installed, the mains plug of the mains connection cable must be freely accessible, or if free access is not possible, an all-pole disconnecting device must be installed in the permanently installed electrical system in accordance with the installation instructions.
- ▶ When setting up the device, make sure that the power cord is not pinched or damaged.

Damaged power cord insulation is dangerous.

- ▶ Never bring the connecting cable into contact with heat sources.

WARNING – Risk of explosion!

If the ventilation openings of the device are closed, a flammable gas-air mixture can form in the event of a cold circuit leak.

- ▶ Do not block ventilation openings in the housing of the device or in the installation housing.

WARNING – Risk of fire!

Using an extended power cord and unauthorized adapters is dangerous.

- ▶ Do not use extension cords or multiple sockets.
- ▶ If the power cord is too short, contact customer service.

- ▶ Only use adapters approved by the manufacturer.

Portable mobile multiple power outlets or portable power supplies can overheat and cause a fire.

- ▶ Do not place portable mobile multiple power outlets or portable power supplies on the back of the devices.

1.6 Safe use

⚠ WARNING – Risk of electric shock!

Penetrating moisture can cause an electric shock.

- ▶ Only use the device in closed rooms.
- ▶ Never expose the device to excessive heat and humidity.
- ▶ Do not use a steam cleaner or high-pressure cleaner to clean the appliance.

⚠ WARNING – Risk of suffocation!

Children can pull packing material over their head and become entangled and suffocate.

- ▶ Keep packaging material away from children.
- ▶ Do not let children play with packaging material.
Children can inhale or swallow small parts and choke.

- ▶ Keep small parts away from children.
- ▶ Do not allow children to play with small parts.

⚠ WARNING – Risk of explosion!

Damage to the refrigerant circuit can cause flammable refrigerant to leak and explode.

- ▶ Do not use mechanical devices or means other than those recommended by the manufacturer to accelerate defrosting.
- ▶ Loosen frozen food with a blunt object, eg with the handle of a wooden spoon.
Products with flammable propellants and explosive substances can explode, eg aerosol cans.
- ▶ Do not store products with flammable propellants and explosive substances in the device.

⚠️ WARNING – Risk of fire!

Electrical appliances inside the appliance can lead to a fire, e.g. heating appliances or electric ice-cream makers.

- ▶ Do not use electrical appliances inside the appliance.

⚠️ WARNING – Risk of injury!

Bottles or cans of carbonated drink may burst.

- ▶ Do not keep bottles or cans of carbonated drinks in the freezer compartment.

Injury to the eyes from leaking flammable refrigerant and harmful gases.

- ▶ Do not damage the pipes of the refrigerant circuit and the insulation.

The device can tilt.

- ▶ Do not stand or lean on the plinth, drawers or doors.

⚠️ WARNING – Risk of burns!

Parts on the back of the appliance become hot during use.

- ▶ Never touch the hot parts.

⚠️ WARNING – Risk of cold burns!

Contact with frozen foods and cold surfaces can cause cold burns.

- ▶ Never put frozen food in your mouth after it has been taken out of the freezer compartment.
- ▶ Avoid prolonged skin contact with frozen foods, ice and freezer compartment surfaces.

⚠️ CAUTION – Risk of health hazard!

Observe the following instructions to avoid contamination of foodstuffs.

- ▶ Opening the door for an extended period of time can lead to a significant increase in temperature in the compartments of the appliance.
- ▶ Clean surfaces that come into contact with food and accessible drainage systems regularly.

- ▶ Store raw meat and fish in suitable containers in the refrigerator in such a way that it does not come into contact with or drip onto other foodstuffs.
- ▶ If the refrigerator/freezer is left empty for a long time, switch off the appliance, defrost, clean and leave the door open to prevent mold from forming.

Parts of the device made of metal or with a metallic appearance may contain aluminum. When acidic foods come into contact with aluminum, aluminum ions can transfer to the foods.

- ▶ Do not consume contaminated food.

1.7 Damaged device

 **WARNING** – Risk of electric shock!

A damaged appliance or damaged power cord is dangerous.

- ▶ Never use a damaged device.
- ▶ Never pull on the power cord to disconnect the device from the power supply. Always pull the plug on the power cord.
- ▶ If the appliance or the mains cable is damaged, immediately unplug the mains cable from the socket or switch off the fuse in the fuse box.
- ▶ Contact customer service. → *Page 111*
Improper repairs are dangerous.
- ▶ Only qualified personnel may carry out repairs on the device.
- ▶ Only original spare parts may be used to repair the device.
- ▶ If the power cord of this appliance is damaged, it must be replaced by the manufacturer, its service agent or a similarly qualified person in order to avoid a hazard.

 WARNING – Risk of fire!



If the pipes are damaged, flammable refrigerant and harmful gases can escape and ignite.

- ▶ Keep fire and ignition sources away from the device.
- ▶ Ventilate the room.
- ▶ Turn off the device. → *Page 99*
- ▶ Pull the mains plug out of the socket or switch off the fuse in the fuse box.
- ▶ Contact the service department. → *Page 111*

2 Preventing material damage

PAY ATTENTION!

Using the plinth, drawers or appliance doors as a seat or step can damage the appliance.

- ▶ Not on the plinth, drawers or doors standing or leaning.

Contamination with oil or grease can make plastic parts and door seals porous.

- ▶ Keep plastic parts and doors seals oil and grease free.

Parts of the device made of metal or with a metallic appearance may contain aluminum. Aluminum reacts on contact with acidic foods.

- ▶ No foodstuffs unpackaged in store the device.

3 Environmental protection and savings

3.1 Disposing of the packaging

The packaging materials are environmentally friendly and can be reused.

- ▶ The individual components on kind of separate disposal.

3.2 Saving energy

If you follow these directions, your device will use less power.

Choice of installation location

- s Do not expose the device to direct sunlight.

Preventing material damage NL

- s Place the appliance as far as possible body from radiators, stove and other heat sources:

- Keep a distance of 30 mm from electric or gas stoves.
- Keep a distance of 300 mm from oil and coal stoves.

- s Keep a small distance to the side wall on.

- s Never open the external ventilation opening cover or close.

Save energy when using.

Remark: The arrangement of the equipment parts has no influence on the energy consumption of the appliance.

- s Open the device only briefly and close it carefully.

- s Never enter the ventilation openings nenin, or cover or close the ventilation grilles on the outside.

- s Transport refrigerated foodstuffs parts in a cool bag and put them in the appliance quickly.

- s Warm food and drinks first to cool, then place in the appliance.

- s To avoid the cold of the deep-to use frozen products, put them in the refrigerator compartment for thawing.

- s Always leave some space between the legs equipment and the back wall.

4 Set up and connect

4.1 Scope of delivery

After unpacking, check all parts for transport damage and the completeness of the delivery.

In case of complaints, please contact your dealer or our service → *Page 111* contact on.

The delivery consists of:

NL Set up and connect

- s Freestanding device
- s Equipment and accessories¹
- s Assembly instructions
- s Instructions
- s Customer service overview
- s Warranty Supplement²
- s Energy label
- s Information about energy consumption and sounds

4.2 Criteria for the installation location

WARNING

Risk of explosion!

If the appliance is located in a room that is too small, a flammable gas-air mixture can form in the event of a leak in the cooling circuit.

- ▶ Only set the device to a space, which has a volume of at least 1 m³ per 8 g of refrigerant. The amount of refrigerant is stated on the rating plate. → *fig. 1*



The weight of the device can be up to 120 depending on the model.

The surface must be stable enough to support the weight of the appliance.

Permissible room temperature

The permitted room temperature depends on the climate class of the device.

The climate class can be found on the type plate. → *fig. 1/5*

Climate-class	Permitted space-temperature
---------------	-----------------------------

SN 10 °C...32 °C

The device is fully functional within the permitted indoor temperature.

If you use a device of the climate class SN at lower room temperatures, damage to the device up to a room temperature of 5 °C can be excluded.

4.3 Mounting the device

- ▶ The device in accordance with the install the installation manual.

4.4 Preparing the device for the first use

1. Remove the information material.
2. Remove the protective film and transport safeguards, eg adhesive strips and cardboard.
3. Cleaning the device for the first time. → *Page 105*

4.5 Connecting the appliance electrically

1. Insert the mains plug of the appliance's connecting cable into a socket in the vicinity of the appliance.

The connection data of the device can be found on the type plate. → *fig. 1/5*

¹ Depending on the device version

² Not in all countries

2. Check the mains plug for tightness.

a The device is now ready for use.

5 Getting to know your appliance men

5.1 Device

Here you will find an overview of the components of your device.

→ Fig. ■

a	Cooling compartment → <i>Page 102</i>
B	Freezer compartment → <i>Page 103</i>
1	Relief
2	Bottle rack → <i>Page 97</i>
3	Storage drawer → <i>Page 98</i>
4	Fruit and vegetable drawer → <i>Page 98</i>
5	Rating plate → <i>Page 112</i>
6	freezer drawer → <i>Page 106</i>
7	Leveling foot
8	Control panel → <i>Page 97</i>
9	Door rack for large bottles → <i>Page 98</i>

Remark: Differences between your device and the images may be based on equipment and size.

5.2 Control panel

You can set all functions of your device and obtain information about the operating status via the control panel.

→ Fig. ■

1	Shows the set temperature of the refrigerator compartment in °C.
2	super (refrigerator compartment) switches Supercooling in or out.
3	eco turns power saving mode on or off.
4	vacation switches the holiday mode on or off.
5	⓪ turns on the device or from.
6	Shows the set temperature of the freezer compartment in °C.
7	super (freezer compartment) switches Super Freeze on or off.
8	fresh switches the Fresh mode in or out.
9	alarm switches the warning wings signal off.

6 Equipment

The equipment of your appliance depends on the model.

6.1 Shelf

To vary the shelves as desired, you can remove the shelf and put it back in a different position.

→ "*Remove platform*", *page 106*

6.2 Bottle rack

Store bottles safely on the bottle rack.

To vary the bottle rack as desired, you can remove the bottle rack and put it back in a different location.

→ "*Remove platform*", *page 106*

6.3 Storage drawer

Lower temperatures prevail in the storage drawer than in the refrigerator compartment. Temperatures below 0 °C may occur temporarily.

To achieve temperatures close to 0°C in the storage drawers, set the refrigerator compartment temperature to 2°C.

Use the lower temperatures in the drawer to store food that spoils quickly, e.g. fish, meat and sausage.

6.4 Fruit and vegetable drawer

Store fresh fruit and vegetables packed in the fruit and vegetable drawer.

Store sliced fruits and vegetables covered or in an airtight container. Depending on the type of food and the amount, condensation may form in the fruit and vegetable drawer.

Remove the condensation water with a dry cloth.

To ensure that the quality and aroma are preserved, you should store cold-sensitive fruit and vegetables outside the appliance at temperatures of approx. 8 °C to 12 °C, e.g. pineapple, bananas, citrus fruits, gherkins, zucchini, peppers, tomatoes and potatoes.

6.5 Door racks

To vary the door rack as required, you can remove the door rack and place it in a different position.

→ *"Remove Door Rack", Page 106*

6.6 Accessories

Use only original accessories. These are adapted to the device. The accessories of the device depend on the model.

egg tray

Store eggs safely on the egg tray.

ice cube tray

Use the ice cube tray to make ice cubes.

Making ice cubes

Use only drinking water to make ice cubes.

1. Fill the ice cube tray $\frac{3}{4}$ full with drinking water and place it in the freezer compartment.

Only loosen frozen ice cube trays with a blunt object, e.g. the handle of a spoon.

2. To loosen the ice cube tray, twist the ice cube tray slightly or hold it briefly under running water.

7 The Ministry in essence tie

7.1 Switch on device

1. Connect the appliance electrically.
→ *Page 96*

Remark: If the device was previously turned off via the control panel, 3 seconds ① keep pressed.

- a The appliance starts to cool.
- a A warning beep will sound signal and the temperature display flashes because the freezer compartment is still too warm.
- 2. Switch off the warning signal with a harm
- a alarm goes out as soon as the set temperature is reached.
- 3. Set the desired temperature.
→ *Page 99*

7.2 Notes on use

- s When you have set up the device switched on, it takes up to a few hours before the set temperature is reached.
Do not put food in the appliance until the set temperature has been reached.
- s The front sides of the housing are temporarily heated. This prevents condensation from forming in the area of the door seal.
- s When you close the door, a under pressure arise. The door will then be more difficult to open. Wait a moment until the negative pressure is compensated.

7.3 Switching off the machine

- ▶ ① Hold for 3 seconds.

7.4 Set temperature

Set fridge compartment temperature

- ▶ Press the desired temperature know.

The recommended temperature in the refrigerator compartment is 4 °C.

Set freezer temperature

- ▶ Press the desired temperature.

The recommended temperature in the freezer compartment is -18 °C.

8 Additional Features

8.1 Super cooling

With Supercooling, the refrigerator compartment cools as cold as possible.

Switch on Super Cool before loading large quantities of food.

Remark: If Super Cool is on, there may be more noise.

Enable super cooling

- ▶ Press **super** (refrigerator compartment).

a (refrigerator compartment) lights up.

Remark: After approx. 6 hours, the device switches to normal operation.

Switch off super cooling

- ▶ **super** (refrigerator compartment) press.

8.2 Automatic Super Freeze

With automatic Super Freezing, the freezer compartment cools significantly at a lower temperature than in normal operation. As a result, the food freezes faster to the core. The automatic Super Freeze switches on when you place fresh food in the bottom freezer drawer starting from the right.

Automatic Super Freeze is activated at the factory. You can deactivate the automatic Super Freeze. When the automatic Super Freeze is on, (freezer compartment) lights up and there may be more noises.

The appliance switches to normal operation after the automatic Super Freeze has expired.

Activate Auto Super Freeze

► **super** (freezer compartment) press and hold for 5 seconds.

a If there are 2 acoustic signals are heard, the automatic Super Freeze is activated.

Deactivate Automatic Super Freeze

► **super** (freezer compartment) press and hold for 5 seconds.

a If there are 3 acoustic signals are heard, the automatic Super Freeze is deactivated.

Auto Cancel Super Freeze

► Press **super** (freezer).

8.3 Manual Super Freeze

With Super Freezing, the freezer compartment cools as cold as possible. Switch on Super Freeze 4 to 6 hours before loading a quantity of food from 2 kg into the freezer compartment.

To take advantage of the freezing power, use Super Freeze.
→ *"Freezing power conditions gen", Page 103*

Remark: If Super Freeze is on, there may be more noise.

Manual Super Freeze switch

► Press **super** (freezer). a (freezer) lights up.

Remark: After approx. 54 hours, the device switches to normal operation.

Manual Super Freeze Switch off

► Press **super** (freezer).

8.4 Vacation mode

If you are away for a longer period of time, you can switch the device into energy-saving holiday mode.

 **CAREFULLY**
Risk of health hazard!

While the holiday mode is switched on, the refrigerator compartment heats up. The increased temperature allows bacteria to multiply and spoil the food.

► When holiday mode is switched on so do not store food in the refrigerator compartment.

The device sets the temperatures automatically.

refrigerator compartment	14 °C
bottle compartment	temperature on-altered
Freezer	temperature on-altered

Enable holiday mode

► vacation impressions.
a vacation burns.

Switch off holiday mode

► vacation impressions.

8.5 Energy Saving Mode

Energy-saving mode switches the device to energy-saving mode.

The device automatically changes the temperatures.

refrigerator compartment	8 °C
bottle compartment	temperature on-altered
Freezer	-16 °C

Energy Saving Mode switch

- ▶ eco impressions.
- a eco is lit.

Energy Saving Mode Switch off

- ▶ eco impressions.

8.6 Fresh mode

To keep the food fresh for longer, you can switch on the fresh cooling mode of the appliance.

The device automatically changes the temperatures.

refrigerator compartment	2°C
bottle compartment	temperature on-altered
Freezer	temperature on-altered

Enable fresh mode

- ▶ fresh impressions.
- a fresh is lit.

Disable fresh mode

- ▶ fresh impressions.

8.7 Sabbath Mode

So that you can also use the device on Sabbaths, Sabbath mode disables all functions that are not absolutely necessary.

The following functions are disabled during Sabbath mode:

- s Super cooling
- s Automatic Super Freeze and manual Super Freeze
- s Alarm
- s Indoor lighting
- s Acoustic signals
- s Messages on the control panel neel

Remark: During Sabbath mode, the control panel backlight turns off. burns vacation with reduced brightness.

Enable Sabbath Mode

- ▶ vacation pressed for 15 seconds until an acoustic signal sounds.

a vacation burns.

Remark: After approx. 80 hours, the device switches to normal operation.

Disable Sabbath Mode

- ▶ vacation pressed for 15 seconds until an acoustic signal sounds.

9 Alarm

9.1 Door alarm

If the door of the appliance is left open for a long time, the door alarm is activated.

A warning signal sounds, alarm flashes, and the temperature display of the corresponding compartment flashes.

Disable door alarm

- ▶ Close or open the appliance door alarm to press.
- a The warning signal is off switched.

9.2 Temperature alarm

When it is too hot in the freezer compartment, the temperature alarm is activated.

A warning signal sounds, the set temperature (freezer compartment) and flash alarm

 **CAREFULLY**
Risk of health hazard!

When defrosting, bacteria can multiply and the frozen food can go bad.

- ▶ Half or completely defrosted frozen were not refreezing.
- ▶ Do not cook or roast the food until freeze again.
- ▶ The maximum retention time no longer take full advantage.

The temperature alarm may activate in the following cases:

- s The appliance is in use names.
Do not put food in the appliance until the set temperature has been reached.
- s Large amounts are packed food. Switch on Super Freeze before placing large quantities of food in the appliance.
- s The freezer compartment door is too long opened.
Check whether the frozen product is partially or completely thawed.

Disable temperature alarm

- ▶ alarm impressions.
- a The warning signal is off switched.

1 Refrigerator compartment

In the refrigerator compartment you can store meat, sausage, fish, dairy products, eggs, ready meals and bread and pastries.

The temperature is adjustable from 2 °C to 8 °C.

The cold storage also allows you to store slightly perishable foodstuffs in the short or medium term. The lower the temperature selected, the longer the food will remain fresh.

10.1 Tips for storing food in

the refrigerator compartment

- s Only fresh and undamaged clearing out resources.
- s Store the food in air tightly packed or covered.
- s Leave warm food and drinks cool down first.
- s Keep the manufacturer's instructions the best before date or use date.

10.2 Cold zones in the refrigerator compartment

The air circulation in the refrigerator compartment creates different cold zones.

Coldest zone

The coldest zone is between the arrow stamped on the side and the shelf underneath.

Tip: Store quickly perishable food in the coldest zone, e.g. fish, sausage and meat.

Warmest zone

The warmest zone is at the very top of the door.

Tip: Store less sensitive foods in the warmest zone, eg hard cheese and butter. As a result, the aroma of the cheese develops better and the butter remains spreadable.

1 freezer compartment

You can store frozen food, freeze food and make ice cubes in the freezer compartment.

The temperature is adjustable from $-16\text{ }^{\circ}\text{C}$ to $-24\text{ }^{\circ}\text{C}$.

Long-term storage of foodstuffs should be at a temperature of $-18\text{ }^{\circ}\text{C}$ or lower.

Freezing allows you to store perishable foods for a long time. The low temperatures slow down or stop spoiling.

11.1 Freezing capacity

The freezing capacity indicates which amount of food can be frozen to the core in how many hours.

Information about the freezing capacity can be found on the type plate. → fig. ■

5

Conditions for freezing capacity

1. Approx. 24 hours before loading fresh food, switch on Super Freeze.
→ "Manual Super Freeze switch", page 100

2. Place the food in the bottom freezer drawer, starting from the right.

11.2 Fully use freezer compartment volume

Find out how to put the maximum amount of frozen food in the freezer compartment.

1. Remove all equipment.
→ Page 106
2. Store the food directly on the shelves and the bottom of the freezer compartment.

11.3 Tips for storing food in

the freezer compartment

- s Store the food in air tightly packed.
- s Bring food to be frozen not in contact with frozen food.
- s The foodstuffs side by side place in the compartments or freezer drawers.
- s For larger quantities of fresh to freeze food quickly and carefully, place it in the lower freezer drawers.
- s For good air circulation in push the appliance into the freezer drawer as far as it will go.

11.4 Tips for freezing fresh food

- s Only fresh and impeccable freezing foodstuffs.
- s Foods per portion frozen zen.
- s Prepared foods are better suitable than raw edible foods.

- s Wash vegetables before freezing reduce and blanch.
- s Wash fruit before freezing, destone and peel if necessary, add sugar or ascorbic acid solution if necessary.
- s Food suitable for freezing
Foods such as baked goods, fish and seafood, meat, game and poultry, eggs without shells, cheese, butter, quark, ready meals and leftovers.
- s Food unsuitable for freezing
Foods are eg lettuce, radishes, eggs with shell, grapes, red apples and pears, yogurt, sour cream, crème frache and mayonnaise.

Pack frozen foods

Suitable packaging material and the right type of packaging largely preserve product quality and avoid freezer burn.

1. Place the food in the packaging.
2. Push the air out.
3. Seal the package airtight to prevent the food from losing their flavor or drying out.
4. Provide the packaging with the contents of the freezing date.

11.5 Shelf life of the frozen food at -18 °C

Product	Storage time
fish, sausage, ready made dishes, bread and banquet	Up to 6 months <small>Pine tree</small>
Poultry, meat	Up to 8 mon- <small>Pine tree</small>
Vegetables fruit	Up to 12 Mon- <small>Pine tree</small>

The freezer calendar printed on it indicates the maximum storage time in months at a constant temperature of -18°C.

11.6 Defrosting methods for frozen food

 **CAREFULLY**
Risk of health hazard!

When defrosting, bacteria can multiply and the frozen food can go bad.

- ▶ Half or completely defrosted frozen were not refreezing.
- ▶ Do not cook or roast the food until freeze again.
- ▶ The maximum retention time no longer take full advantage.

s Animal foods in the
defrost the refrigerator compartment, e.g. fish, meat, cheese and cottage cheese.

s Bread at room temperature thaw.

s Foodstuffs for direct con-
preparation in the microwave, in the oven or on the stove.

2 Defrost

12.1 Defrosting in the freezer compartment

Thanks to the fully automatic “NoFrost” system, the freezer compartment remains frost-free. Thawing is not necessary.

3 Cleaning and maintenance loves

Carefully clean and maintain your device to ensure that it continues to function properly for a long time. The cleaning of inaccessible places must be carried out by the after-sales service. There may be costs associated with cleaning by the service department.

13.1 Preparing the device for cleaning

1. Turn off the device.
→ *Page 99*
2. Unplug the appliance from the mains.
Pull the mains plug out of the socket or switch off the fuse in the fuse box.
3. Remove all food and store in a cool place.
If available, place cooling elements on the food.
4. Remove all equipment and accessories from the device.
→ *Page 106*
5. Remove the shelf above the fruit and vegetable drawer.
→ *Page 106*

13.2 Cleaning the appliance



WARNING

Risk of electric shock!

Penetrating moisture can cause a shock.

- ▶ No steam cleaner or high pressure use cleaner to clean the appliance.

Liquid in the lighting, in the controls or in the internal ventilation openings can be dangerous.

- ▶ The washing-up water must not be placed in the light, into the controls, or into the internal ventilation openings.

PAY ATTENTION!

Unsuitable cleaning agents can damage the surfaces of the device.

- ▶ No harsh scouring or dishwashing use sponges.
- ▶ No sharp or abrasive cleaning using chemicals.
- ▶ No strong alcoholic cleaning agents using chemicals. When you clean equipment and accessories in the dishwasher, they can become deformed or discolored.
- ▶ Never use equipment and accessories clean the rest in the dishwasher.

1. Prepare device for cleaning. → *Page 105*
2. Clean the appliance, the equipment, the accessories and the door seals with a dish cloth, lukewarm water and a little pH-neutral washing-up liquid.
3. Dry thoroughly with a soft, dry cloth.
4. Position the equipment and install the equipment parts.
5. Connect the appliance electrically.
6. Put the food in the appliance.

13.3 Removing parts

If you want to thoroughly clean the equipment, remove it from the device.

Remove platform

- ▶ Lifting the platform from behind
① and delete . ②
→ Fig. ■

Remove door rack

- ▶ Lift the door rack and
to widen.
→ Fig. ■

Remove storage drawer

1. Pull out the drawer as far as it will go.
2. Lift the front storage drawer and
remove it . ②
→ Fig. ■

Remove fruit and vegetable drawer

1. Pull out the fruit and vegetable drawer
as far as it will go.
2. Lift and remove the fruit and
vegetable drawer at the front
②.
→ Fig. ■

Remove freezer drawer

1. Pull out the freezer drawer as far
as it will go.
2. Lift and remove the freezer
① drawer at the front . ②
→ Fig. ■

Remove drawer front

You can remove the drawer front of the fruit and vegetable drawer and the frozen food drawer for easier cleaning.

- ▶ Press the snap hooks on the side
of the tray and remove it
drawer front by turning the
drawer . ②
→ Fig. ■

13.4 Disassembling device components

To thoroughly clean your device, you can disassemble certain parts from your device.

Remove the shelf above the fruit and vegetable drawer

1. Remove the fruit and vegetable
drawer. → *Page 106*
2. Remove the storage drawer
→ *Page 106*
3. To release the hooks on the sides,
push the sealing frame up and out.

→ Fig. ■
4. To release the rear hooks, lift the
sealing frame and slide it back.

→ Fig. 0 ■
5. Remove the sealing frame.
6. Lift the shelf above the fruit and
vegetable drawer and turn it out to
the side.
→ Fig. 1 ■

4 Troubleshooting

You can remedy minor faults on the device yourself. Before contacting customer service, please refer to the troubleshooting information. This way you avoid unnecessary costs.

WARNING

Risk of electric shock!

Improper repairs are dangerous.

- ▶ Only qualified personnel may carry out repairs on the device to carry out.
- ▶ Only original spare parts may be used for repair of the device.
- ▶ If the power cord of this appliance is damaged, it must be replaced by the manufacturer, its service agent or another qualified person.

Malfunction	Cause and Troubleshooting
Device does not cool, indicators and lighting are on.	<p>The presentation light is turned on.</p> <ol style="list-style-type: none"> 1. Press and hold POWER (refrigerator compartment) for 50 seconds until a sound signal is heard. 2. After a short time, check whether your appliance is cooling.
Side panels of the appliance are hot.	<p>No malfunction. Pipes run in the side walls, which become hot during the cooling process. Furniture against the appliance will not be damaged by the heat.</p> <p>No action required. No action required.</p>
Temperature displays and alarm.	<p>A sensor is defective.</p> <ul style="list-style-type: none"> ▶ Contact customer service. <p>The service number can be found in the enclosed service overview.</p>
<p>A warning signal sounds, the temperature display (refrigerator compartment) and alarm blink.</p> <p>The door alarm is turned on.</p>	<p>The refrigerator compartment door is open.</p> <ul style="list-style-type: none"> ▶ Close the refrigerator compartment door.

Malfunction	Cause and Troubleshooting
<p>A warning signal sounds, the temperature display (freezer compartment) and alarm blink.</p> <p>The door alarm is turned on.</p>	<p>Freezer door is open.</p> <ul style="list-style-type: none"> ▶ Close the freezer compartment door.
<p>A warning signal sounds, the set temperature (freezer compartment) and alarm blink.</p> <p>Temperature alarm is enabled.</p>	<p>Various causes are possible.</p> <ul style="list-style-type: none"> ▶ Press . alarm <p>a Turn off the alarm.</p> <hr/> <p>Ventilation grilles on the outside are covered.</p> <ul style="list-style-type: none"> ▶ Remove blockages to the external ventilation grille ter. <hr/> <p>Larger quantities of fresh foodstuffs have been placed in storage.</p> <ul style="list-style-type: none"> ▶ Do not exceed the freezing capacity. → "Freezing capacity", page 103
<p>Set temperature is not reached.</p> <p>Fully automatic de-thaw doesn't work more.</p>	<p>The freezer compartment door was open too long. There is a lot of ice on the evaporator (cold generator) in the NoFrost system.</p> <p>Required: Frozen foods are well insulated and stored in a cool place.</p> <ol style="list-style-type: none"> 1. Switch off the device. → <i>Page 99</i> 2. Disconnect the device from the power supply. Unplug the power cord from the socket or switch off the fuse in the meter box. 3. Contact customer service. The service number can be found in the enclosed service overview.
<p>Temperature varies a lot depending on the setting.</p>	<p>Various causes are possible.</p> <ol style="list-style-type: none"> 1. Switch off the device. → <i>Page 99</i> 2. Switch the device on again after approx. 5 minutes. → <i>Page 98</i> <ul style="list-style-type: none"> s If the temperature is too high, check the temperature again after a few hours. s If the temperature is too low, check the temperature again the next day.

Malfunction	Cause and Troubleshooting
Condensation forms on the surface of the device and the shelves in the device.	<p>The water vapor in warm and humid air condenses on the colder surfaces of the device.</p> <ol style="list-style-type: none"> 1. Wipe off the water with a soft, dry cloth. 2. Open the device as briefly as possible. 3. Make sure that the device is always closed properly.
collects in the fruit and vegetable drawer often a lot of condensation ter.	<p>Depending on the storage quantity and the product, condensation forms in the fruit and vegetable drawer.</p> <ol style="list-style-type: none"> 1. Remove the fruit and vegetable drawer. → <i>Page 106</i> 2. Remove the breather clips and reverse bet . ② → Fig. 2
The device hums, bubbles, buzzes, gurgles, clicks, or makes popping noises.	<p>No malfunction. A motor is running, eg cooling unit, fan. Refrigerant flows through the pipes. Motor, switches or solenoid valves switch on or off. The automatic defrost system operates.</p> <p>No action required. No action required.</p>
Device produces sounds.	<p>The appliance is not level.</p> <ul style="list-style-type: none"> ▶ Adjust the appliance horizontally using a spirit level and the leveling feet. <hr/> <p>Device is not freestanding.</p> <ul style="list-style-type: none"> ▶ Keep the minimum distances from the device. <hr/> <p>Equipment parts wobble or jam.</p> <ul style="list-style-type: none"> ▶ Check the removable equipment and put them back into the device if necessary. <hr/> <p>Bottles or containers touch each other.</p> <ul style="list-style-type: none"> ▶ Separate bottles or containers. <hr/> <p>Super freeze is enabled.</p> <p>No action required. No action required.</p>

14.1 Power failure

During a power failure, the temperature in the appliance rises, which shortens the storage time and reduces the quality of the frozen products.

On our website for your appliance, you will find in the technical data the storage time of the frozen products in the event of a malfunction.

Remarks

s The appliance during a power outage open the trap as little as possible and do not put in any other food.

s Food quality

immediately after the power failure.

- Discard frozen foods that are thawed and warmer than 5°C.

- Cook or bake slightly thawed frozen foods and either consume or refreeze.

14.2 Running the device self-test

1. Turn off the device.
→ *Page 99*
2. Unplug the appliance from the mains.
Pull the mains plug out of the socket or switch off the fuse in the fuse box.
3. Reconnect the appliance electrically after 5 minutes.
4. Within 10 seconds after switching on the electrical connection (refrigerator compartment) for Press and hold for 3 to 5 seconds until an acoustic signal sounds.

a The device self-test starts.

a If after the end of the device self-test 2 acoustic signals sound and the temperature display shows the set temperature, your appliance is OK. The device returns to normal operation.

a When after the end of the self-test of the device 5 acoustic signals sound and the LEDs of the temperature display light up with different brightness, please contact customer service. The LEDs provide the service department with information about the current fault.

15 Store and Discard

Here you will find an explanation of how to prepare the device for storage. We also explain how to dispose of old appliances.

15.1 Decommissioning the device

1. Turn off the device.
→ *Page 99*
2. Unplug the appliance from the mains.
Pull the mains plug out of the socket or switch off the fuse in the fuse box.
3. Remove all food.
4. Clean the device.
→ *Page 105*
5. To ensure ventilation of the interior, leave the appliance open.

15.2 Disposal of your old device

Environmentally friendly disposal allows valuable raw materials to be reused.

 **WARNING**
Risk of health hazard!

Children can lock themselves in the appliance and endanger their lives.

- ▶ To prevent children from entering the appliance do not crawl shelves and drawers out of the appliance.
- ▶ Keep children away from keep a discarded device.

 **WARNING**
Risk of fire!

If the pipes are damaged, flammable refrigerant and harmful gases can escape and ignite.

- ▶ The pipes of the refrigerant circuit and do not damage the insulation.

1. Unplug the power cord from the outlet.
2. Cut the power cord.
3. Dispose of the device in an environmentally friendly way.

You can obtain information about the current disposal methods from your dealer and your municipal or district council office.



This appliance is marked in accordance with the European Directive 2012/19/EU on waste electrical and electronic

chemical equipment (waste electrical and electronic equipment - WEEE). The directive sets the framework for the take-back valid in the EU and disposal of old appliances.

16 Customer Service

If you have any questions, cannot rectify a malfunction of the device yourself or if the device needs to be repaired, please contact our service department.

Original replacement parts that are relevant for the function in accordance with the respective Ecodesign Regulation can be obtained from our service department for a period of at least 10 years from the time of placing the device on the market within the European Economic Area.

Remark: Calling in the service is free of charge under the locally applicable manufacturer's warranty conditions. The minimum duration of the warranty (manufacturer's warranty for private users) in the European Economic Area is 2 years in accordance with the applicable local warranty conditions. The warranty terms are without prejudice to any other rights or claims you may have under local law.

Detailed information about the warranty period and warranty conditions in your country can be obtained from our after-sales service, your dealer or on our website.

When contacting customer service, you will need the product number (E-Nr.) and the production number (FD) of the device.

The contact details of the customer service can be found in the service list provided or on our website.

16.1 Product number (E no.) and production number (FD)

The product number (E-Nr.) and the production number (FD) can be found on the type plate of the device.

→ *fig.* ■ ■

In order to quickly find your device data and the service telephone numbers, you can write down the data.

7 Technical data

Refrigerant, net content and other technical data can be found on the type plate.

→ *fig.* ■ ■

You can find more information about your model on the Internet at <https://eprel.ec.europa.eu/1>. This web address refers to the official EU product database EPREL. Then follow the instructions when looking for the model. The model identification consists of the slash character of the E number (E-No.) on the type plate. Alternatively, you can also find the model identifier in the first line of the EU energy label.

¹ Only applies to countries in the European Economic Area

BSH Hausgeräte GmbH

Carl-Wery-Straße 34

81739 Munich

GERMANY

www.siemens-home.bsh-group.com

Hergestellt von BSH Hausgeräte GmbH unter Markenlizenz der Siemens AG Fabriqué par BSH Hausgeräte GmbH sous la license de marque de Siemens AG Prodotto da BSH Hausgeräte GmbH con la licenza di marchio di Siemens AG Manufactured by BSH Hausgeräte GmbH under the trademark license of Siemens AG

*** 9001632354***

9001632354 (010527)

de, fr, it, nl